

## Exploded View

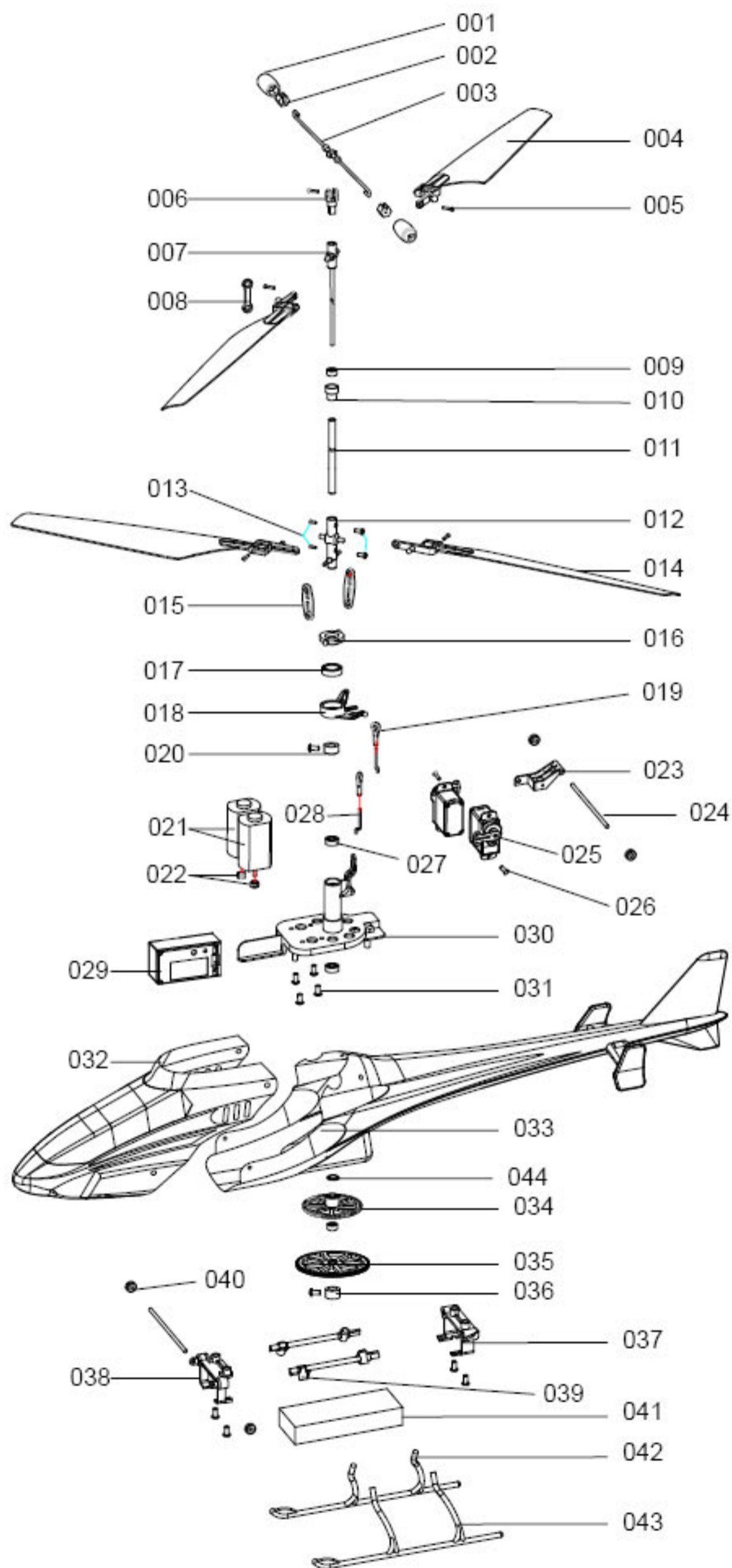

## Exploded View Parts Listing

Exploded View Reference Number	Description (Quantity Required)	Included In Item Number
001	Stabilizer Flybar Rubber Tip (2)	EFLH1219
002	Stabilizer Flybar Weight (2)	EFLH1219
003	Stabilizer Flybar (1)	EFLH1219
004	Upper Main Blade (2)	EFLH1221
005	1.2 x 6mm Screw (5)	EFLH1225
006	Stabilizer Flybar Hub/Holder (1)	EFLH1212
007	Upper Rotor Head & Inner Shaft (1)	EFLH1212
008	Stabilizer Flybar Linkage (1)	EFLH1219
009	Bearing 2mm x 6mm x 3mm (2)	EFLH1121
010	Bearing Holder (1)	EFLH1217
011	Outer Shaft (1)	EFLH1213
012	Lower Rotor Head (1)	EFLH1217
013	M2 x 2.5mm Screw (5)	EFLH1225
014	Lower Main Blade (2)	EFLH1220
015	Lower Rotor Head/Swash Linkage (2)	EFLH1217
016	Upper Swashplate (1)	EFLH1216
017	Bearing 7mm x 13mm x 4mm (1)	EFLH1216
018	Lower Swashplate (1)	EFLH1216
019	Servo Pushrod Control Link (2)	EFLH1218
020	Outer Shaft Retaining Collar (1)	EFLH1214
021	Main Motor Left (1)	EFLH1210
	Main Motor Right (1)	EFLH1211
022	Pinion Gear Left (1)	EFLH1210
	Pinion Gear Right (1)	EFLH1211
023	Servo Mount (1)	EFLH1224
024	Body Mount Rod (2)	EFLH1226
025	Sub-Micro Servo (2)	EFLRS75
026	1.7 x 4mm Screw (8)	EFLH1225
027	Bearing 4mm x 8mm x 3mm (2)	EFLH1215
028	Servo Pushrod (2)	EFLH1218
029	4-in-1 Control Unit (1)	EFLH1025
030	Main Frame (1)	EFLH1224
031	M2 x 4mm Screw (6)	EFLH1225
032	Front Body (1)	EFLH1227
033	Rear Body (1)	EFLH1228
034	Outer Shaft Main Gear (1)	EFLH1213
035	Inner Shaft Main Gear (1)	EFLH1212
036	Inner Shaft Retaining Collar (1)	EFLH1214
037	Battery Support Rear (1)	EFLH1223
038	Battery Support Front (1)	EFLH1223
039	Battery Support Joiner (2)	EFLH1223
040	Body Mount Grommet (4)	EFLH1226
041	Battery Pack (1)	EFLB0990
042	Landing Skid Right (1)	EFLH1222
043	Landing Skid Left (1)	EFLH1222
044	Step Washer (1)	EFLH1225