

2.3 hp • 3000 - 40000 rpm

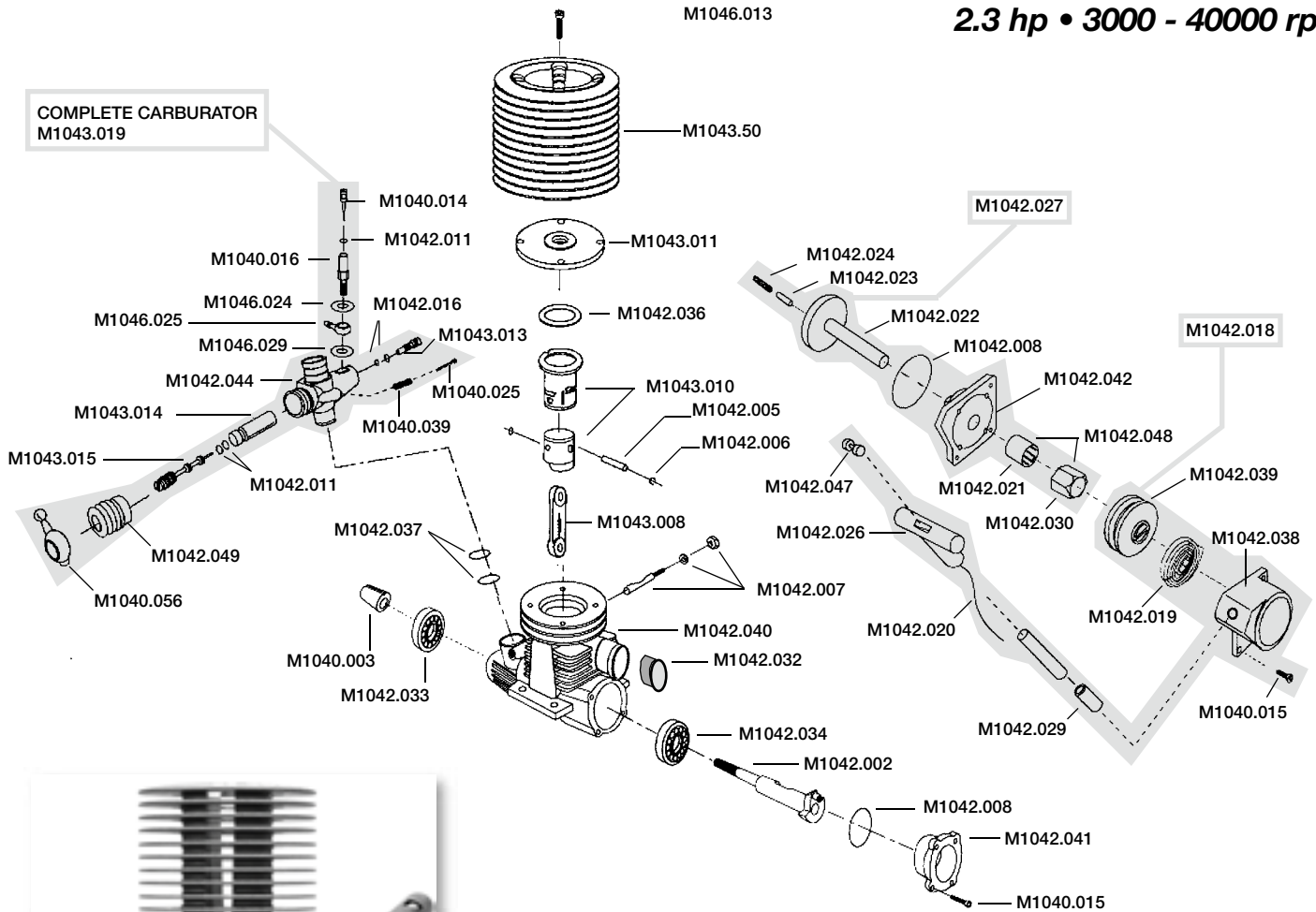

REF	DESCRIPTION	REF	DESCRIPTION	REF	DESCRIPTION
M1040.003	DRIVE COPPER CONE	M1042.026	HANDLE	M1043.013	SUPPLY NEEDLE VALVE
M1040.014	MAIN NEEDLE VALVE	M1042.027	PULL START CRANKCASE COVER SET	M1043.014	THROTTLE 8P
M1040.015	REAR COVER BOLT (M2.6X6) 4PCS	M1042.029	BUFFER HEAD WASHER SEAT	M1043.015	THROTTLE NEEDLE
M1040.016	MAIN NEEDLE VALVE HUB	M1042.030	ONE WAY BEARING SEAT	M1043.019	CARBURETOR (SLIDE TYPE)
M1040.025	THROTTLE STOP ADJUST. SCREW	M1042.032	SILICON EXHAUST GASKET	M1043.050	CYLINDER HEAD
M1040.039	ADJUSTED SCREW SPRING	M1042.033	BALL BEARING FRONT	M1046.013	CYLINDER HEAD BOLT (M3X12)
M1040.056	THROTTLE SCREW CAP	M1042.034	BALL BEARING REAR	M1046.024	WASHER 0,6X5,1X7,5
M1042.002	CRANKSHAFT OS 12MM	M1042.036	CYLINDER HEAD WASHER 0,2MM	M1046.025	FUEL NOZZLE
M1042.005	PISTON GUDGEON PIN	M1042.037	CARBURATOR "O" RING	M1046.029	WASHER 0,6X4,1X7,5
M1042.006	"G" PIN SNAP RING 2 PCS	M1042.038	REAR COVER		
M1042.007	CARBURETOR SETTING PIN	M1042.039	THREAD SEAT		
M1042.008	REAR COVER "O" RING	M1042.040	CRANKCASE BLACK COLOUR	OPTIONAL PART	
M1042.011	MAIN NEEDLE VALVE "O" RING	M1042.041	REAR BACK COVER	M1043.020	CARBURATOR 9MM
M1042.016	SUPPLY NEEDLE VALVE "O" RING	M1042.042	CONNECTIVE SEAT		
M1042.018	RECOIL STARTING UNIT	M1042.044	CARBURETOR MAIN BODY		
M1042.019	EDDY SPRING	M1042.047	STRING SEAT		
M1042.020	STARTING STRING	M1042.048	ONE WAY BALL BEARING + SEAT		
M1042.021	ONE WAY BALL BEARING	M1042.049	THROTTLE COVER		
M1042.022	STARTING AXLE	M1043.008	CONNECTING ROD 8P		
M1042.023	STARTING PIN	M1043.010	CYLINDER SLEEVE/PISTON		
M1042.024	PRESSURE SPRING	M1043.011	BURN ROOM		



**M1046.029**  
Washer, 1pc



**M1040.003**  
Drive washer cone, 1pc



**M1040.014**  
Main needle, 1pc



**M1040.015**  
Pull start cover screws,  
4pcs



**M1040.016**  
Main needle seat, 1pc



**M1040.025**  
Throttle stop adjuster  
screw, 1pc



**M1040.039**  
Spring, 1pc



**M1040.056**  
Throttle arm slide  
carburator, 1pc



**M1043.005**  
Crankshaft 13mm, 1pc



**M1042.005**  
Piston pin SX-21, 1pc



**M1042.006**  
Piston pin clips, 2pcs



**M1042.007**  
Carburator setting pin,  
set



**M1042.008**  
Rear cover O-ring, 1pc



**M1042.011**  
Main needle O-ring, 1pc



**M1042.016**  
Supply needle O-ring,  
set



**M1042.018**  
Pull start unit, set



**M1042.019**  
Recoil spring, 1pc



**M1042.020**  
Pull start string, 1pc



**M1042.021**  
One way bearing, 1pc



**M1042.022**  
Pull start axle, 1pc



**M1042.023**  
Starting pin, 1pc



**M1042.024**  
Pressure spring, 1pc



**M1042.026**  
Pull start handle, 1pc



**M1042.027**  
Pull start crankcase  
cover, set



**M1042.029**  
Buffer head, 1pc



**M1042.030**  
One way bearing seat,  
1pc



**M1042.032**  
Manifold rubber, 1pc



**M1042.033**  
Front ball bearing, 1pc



**M1042.036**  
Cylinder head gasket  
SX-21, 1pc



**M1044.022**  
Rear ball bearing 13mm,  
1pc



**M1042.037**  
Carburator O-ring, 2pcs



**M1042.038**  
Pull start cover, 1pc



**M1042.039**  
Winding plate, 1pc



**M1042.040**  
Crankcase, 1pc



**M1042.041**  
Crankcase cover, 1pc



**M1046.025**  
Fuel supply nipple, 1pc



**M1042.042**  
Pull start crankcase  
cover, 1pc



**M1042.044**  
Carburator body, 1pc



**M1042.047**  
Pull start string seat,  
1pc



**M1042.048**  
One way bearing & seat,  
set



**M1042.049**  
Throttle drum cover,  
1pc



**M1043.008**  
Conrod OMEGA, 1pc



**M1043.010**  
Cylinder & piston OME-  
GA 8P, set



**M1043.011**  
Burn room OMEGA, 1pc



**M1043.013**  
Supply needle valve,  
1pc



**M1043.014**  
Throttle drum OMEGA,  
1pc



**M1043.015**  
Throttle needle, 1pc



**M1043.019**  
Carburator OMEGA, set



**M1043.050**  
Cylinder head PURPLE,  
1pc



**M1046.013**  
Head screws, 6pcs



**M1046.024**  
Washer, 3pcs