

ATTENTION

Note the direction.
If the Cam Holder is installed around the wrong way, the transmission won't shift and you will hear a clicking sound when driving.
Respectez le sens de rotation.
Si la pièce est installée dans le mauvais sens, la transmission ne se fera pas et vous entendrez des "CLICS" quand vous roulez.

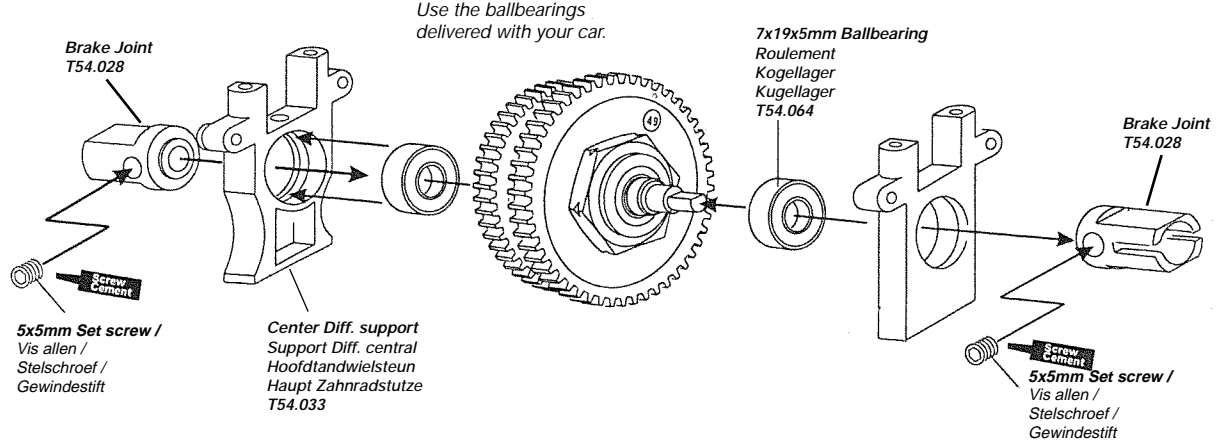



3x10 mm Tapping screw
Vis
Zelftapschroef
Blechschräuben

Use the parts that come with your car
Utilisez les pièces livrées dans le kit
Gebruik de delen uit de kit
Gebrauch mitgelieferte Teile

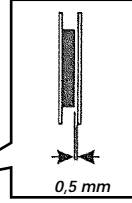
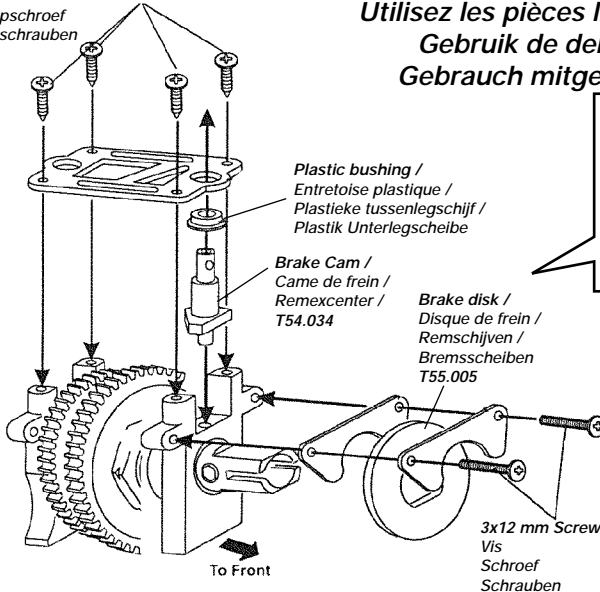

Brake Lever /
Levier de frein /
Remstang /
T55.047

3x3 mm Set screw /
Vis allen /
Stelschroef /
Gewindestift

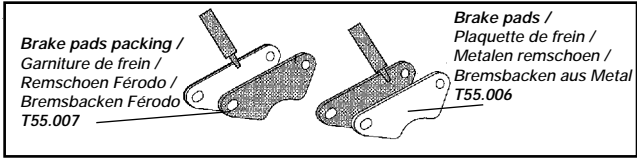
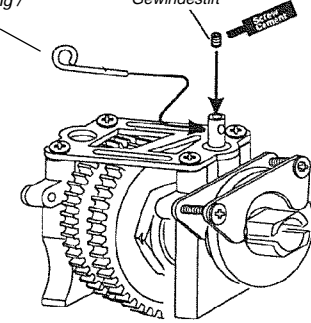

FOR NORMAL PILOT SHAFT

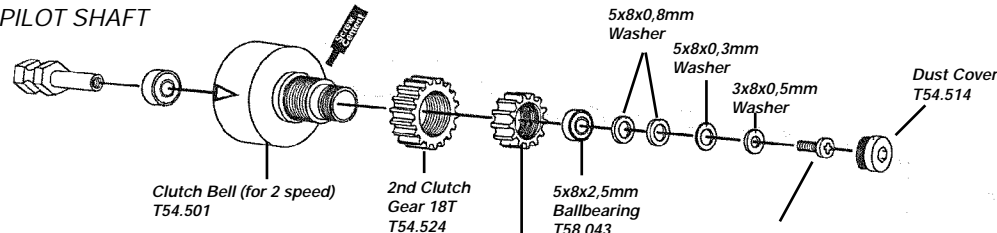

FOR SG PILOT SHAFT

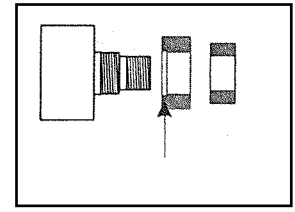
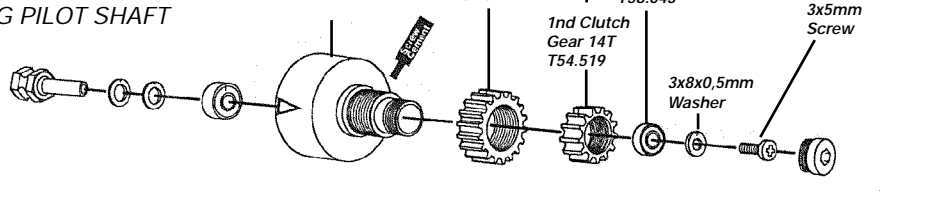

ADJUSTING THE SHIFT POINT

Adjust the engine before adjusting the clutch shift timing

Allen wrench 2 mm /
Clé Allen /
Imbussleutel /
Sechskantstiftschlüssel

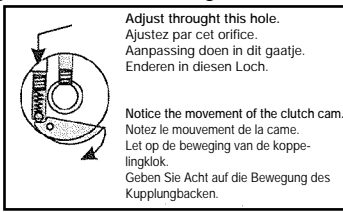

Clockwise (tighten) /
Sens horaire (serrer) /
Wijzerszin (vast) /
Uhrzigersinn (fest)

Anti-clockwise (loosen) /
Sens anti-horaire (déserrer) /
Tegenwijzerszin (los) /
Gegen den Uhrzigersinn (Luchs)

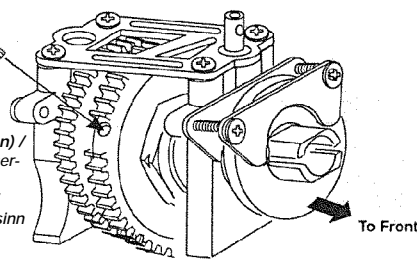

Once the engine adjustment have been completed, proceed to adjustment of the clutch shift timing.
(using a 2mm allen wrench to adjustment the clutch cam.)

NOTE: Clockwise ----- Shift timing will become slower.
Anticlockwise --- Shift timing will become quicker.

- Adjust the clutch shift timing for your track conditions with 4x4mm set screw.
- As you tighten (clockwise) the 4x4mm set screw, the shift timing will become slower.
- As you loosen (anticlockwise) the 4x4mm set screw, the shift timing will become quicker.
- Set the shift timing to the track conditions while the car is running.

2 SPEED GEAR RATIO COMBINATIONS

Important:
The Sum of the spur gear and the clutch gear for 1st gear must be equal to the Sum of the spur gear and the clutch gear for 2nd gear.
Example: 1st gear 45+13=58
2nd gear 41+17=58

SPUR GEAR	CLUTCH GEAR (4 tooth difference)			
49T/45T	13T/17T	14T/18T	15T/19T	16T/20T
48T/44T				
47T/44T				



Ref. nr.	Description		
T54.518	Spur gear	44T 2nd	gear
T54.512	Spur gear	45T 2nd	gear
T54.517	Spur gear	46T 2nd	gear
T54.516	Spur gear	47T 1st	gear
T54.515	Spur gear	48T 1st	gear
T54.511	Spur gear	49T 1st	gear
T54.519	Clutch gear	14T 1st	gear
T54.520	Clutch gear	15T 1st	gear
T54.521	Clutch gear	16T 1st	gear
T54.522	Clutch gear	17T 1st	gear
T54.523	Clutch gear	17T 2nd	gear
T54.524	Clutch gear	18T 2nd	gear
T54.525	Clutch gear	19T 2nd	gear
T54.526	Clutch gear	20T 2nd	gear
T54.527	Clutch gear	21T 2nd	gear