

BAG E

 1:1 115002, qty 5 4mm Ball Stud (D3)	 1:1 502165, qty 2 Washer (E1)	 1:1 126312C, qty 2 3x12mm Cap Screw (E3)	 1:1 502162, qty 1 Sliding Steering Spring (E4)	 1:1 502162, qty 1 3x20mm FH Screw (E3)	 1:1 111007ST, qty 1 3mm Steel Nut (E3)	 1:1 502162, qty 4 Sliding Steering Dust Cover (E1)	 1:1 502165, qty 4 Sliding Steering Mount Screw (E3)	 1:1 116308CR, qty 4 3x8mm Cross FH TP Screw (E1)
 K1432, qty 2 Sliding Steering Mount (E1)	 502160, qty 2 Front Lower Arm (E1)	 502161, qty 1 Front Upper Arm R (E4)	 502161, qty 1 Front Upper Arm L (E4)	 K1470, qty 1 Sliding Steering Servo Saver (E3)	 502162, qty 1 Sliding Steering Servo Saver Arm (E3)	 502170, qty 1 Long Sliding Steering Rail (E3)	 502125, qty 1 #600 Silicone Oil (White Body) (E3) 502163, qty 1 Front Bulkhead L (E4) 502163, qty 1 Front Bulkhead R (E4)	
 502164, qty 2 Front Diff Mount (E1)	 502170, qty 1 Sliding Steering Rail (E3)	 K1406, qty 1 Front Anti-Roll Bar Mounts (w/anti-rill bar) (E3)						

STEP 1

Front Lower Arm & Anti-Roll Bar Assembly

- PLEASE READ K FACTORY MANUAL FOR FUTHER ASSEMBLY.**
- Attach #K1406 3x12mm set screw to the #K1406 front anti-roll bar mounts.
- Please insert the anti-roll bar (w/the ball on the end) into the right mount (without the elliptic hole on the right side). Insert the anti-roll bar (w/the cup on the end) into the left mount (w/the elliptic hole on the left side). Thread the 3x3mm set screw into both mounts to fasten the anti-roll bars.
- Attach one #115002 ball stud to the outside hole of both #502160 right & left front lower arm.
- Attach the anti-roll bar set assembly to the #502160 front lower arm with #K1406 knob & #126312C 3x12 cap screw.
- Attach the anti-roll bar set assembly to the #502160 front lower arm with #126312C 3x12 cap screw.

With the anti roll bars in horizontal position, it will result in the softest setting. At the vertical position it will be the stiffest setting. The knob can be adjusted to reach an equal right-left arm height.

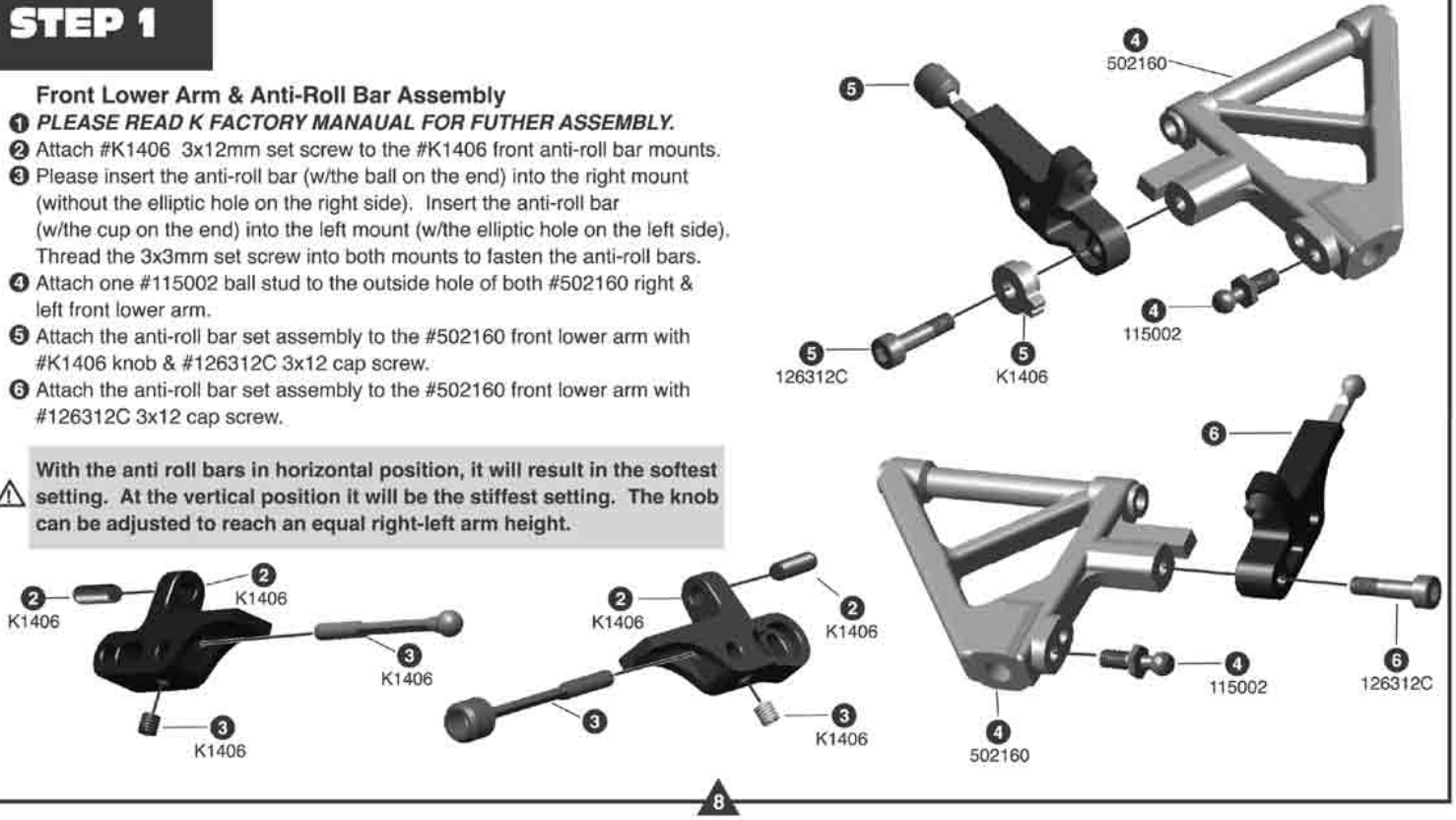

STEP 2

Front Suspension Assembly

- 1 Screw the pivot balls into both # 502161 front upper arm and front lower arm assembly. You want 3mm space between the upper arm & steering block & 2.5mm space between the lower arm & steering block.

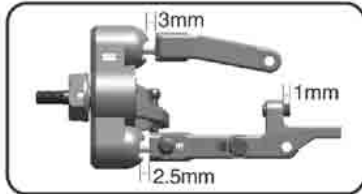

STEP 3

Sliding Steering Servo Saver Assembly

- 1 Thread 2pcs #115002 ball studs into the # 502162 sliding steering servo saver.
- 2 Thread 1pcs #115002 ball stud into # 502162 sliding steering servo saver arm.
- 3 Slide the #502162 spring onto the 3x20mm FH screw. Slide the screw assembly through the bottom of the servo saver assembly.
- 4 Attach the servo saver arm assembly to the servo saver with a #111007ST locknut. Tighten down the screw until the screw end is even with the top of the nut.
- 5 To attach the dust covers, put either #502170 rail through the hole. Peel off the tape on #502162 dust cover & place the tape side through the rail as shown. **DON'T ATTACH THE TAPE TO THE SERVO SAVER. JUST PULL THE RAIL TO MAKE THE COVER STICK TO THE SERVO SAVER.** Please repeat this step to the remaining 3pcs dust cover hole positions.
- 6 Place a drop of #502125 #600 silicone oil on each dust cover.

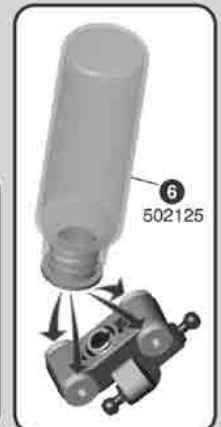
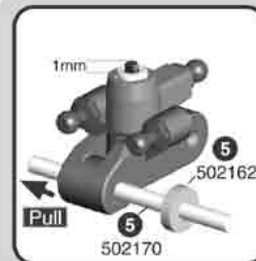
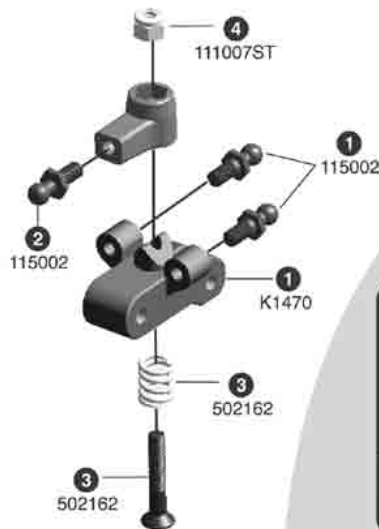

STEP 4

Diff Mount Assembly

- 1 Attach #502165 sliding steering mount to #502163 left front bulkhead with 2pcs #502165 cap screws & washers. **BE GENTLE!! DON'T FULLY TIGHTEN OR OVER TIGHTEN! WE WILL ADJUST THIS MOUNT LATER.**
- 2 Slide #502164 front diff mount into the front bulkhead & fasten with 2pcs #116308CR 3x8mm cross FH TP screws.
- 3 Repeat above 2 steps for the right front bulkhead assembly.

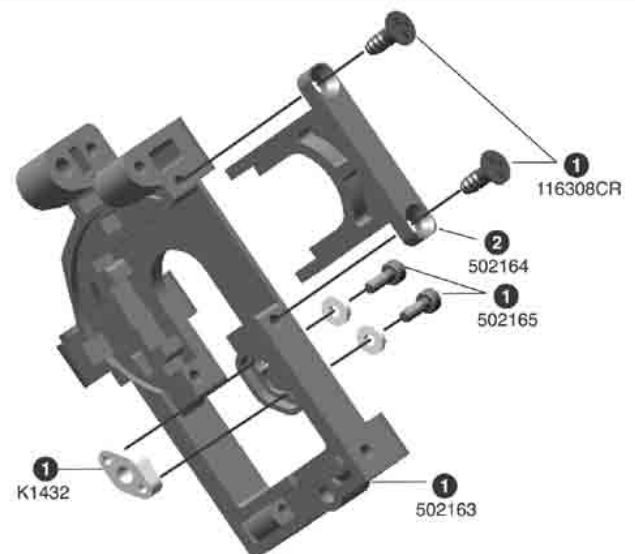

BAG F

<p>1:1</p> <p>111007ST, qty 4 3mm Steel Locknut (E6)</p>	<p>1:1</p> <p>502173, qty 1 2x12mm Cross RH TP Screw (E4)</p>	<p>1:1</p> <p>502174, qty 1 Fuel Tank Support (E9)</p>	<p>1:1</p> <p>116308CR, qty 4 3x8mm Cross FH TP Screw (E11)</p>	<p>1:1</p> <p>126320C, qty 2 3x20mm Cap Screw (E6)</p>	<p>1:1</p> <p>502179, qty 2 2mm Caster Clip (E11)</p>	<p>1:1</p> <p>115002, qty 4 Ball Cup (for 3mm rod) (E10)</p>	
<p>K1464, qty 2 Hardened Hinge Pin (Front Lower) (E9)</p>	<p>K1463, qty 2 Hardened Hinge Pin (Front Upper) (E9)</p>	<p>116134-5, qty 2 3x45mm Adjustable Rod (E9)</p>	<p>1:1</p> <p>116312RCR, qty 2 3x12mm Cross RH TP Screw (E6)</p>	<p>1:1</p> <p>116202, qty 2 E-clip 2.5 (E2)</p>	<p>1:1</p> <p>126408S, qty 2 4x8mm Set Screw (E2)</p>	<p>1:1</p> <p>126305S, qty 2 3x5mm Set Screw (E11)</p>	<p>1:1</p> <p>502179, qty 4 1mm Caster Clip (E11)</p>
<p>502170, qty 1 Sliding Steering Rail (E9)</p>	<p>502170, qty 1 Long Sliding Steering Rail (E9)</p>	<p>502171, qty 1 Front Belt (E11)</p>	<p>502180, qty 1 Front Lower Arm Stiffener Brace (E11)</p>	<p>502173, qty 1 Pivoting Body Mount (E3)</p>	<p>502172, qty 1 Nylon Front Upper Stiffener Bracket (E2)</p>	<p>502173, qty 1 5th Body Post (E3)</p>	<p>502175, qty 1 Front Shock Tower (E9)</p>

STEP 1

Front Transmission Assembly

- Slide #502170 sliding steering rails and front diff assembly into the #502163 right side front bulkhead.
- Slide sliding steering servo saver assembly over the rails.
- Slip #502171 front belt (No. 50145) over the front diff and install the left side bulkhead.

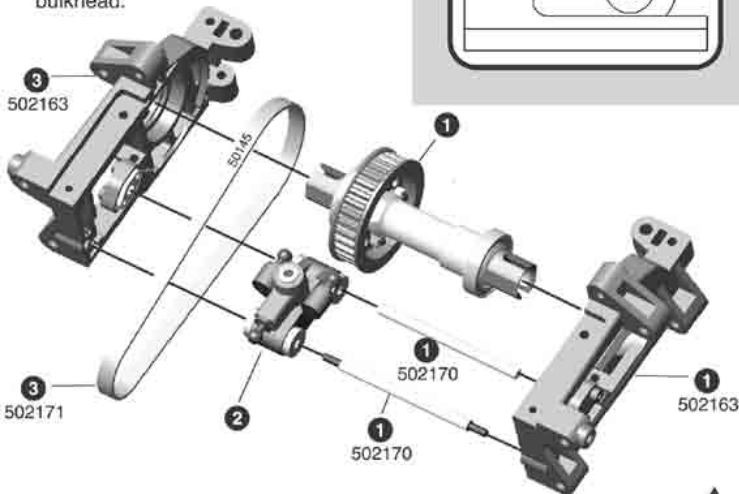
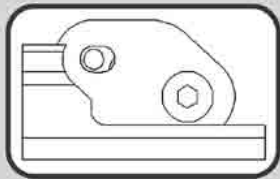

STEP 2

Front Upper Stiffener Bracket Assembly

- Attach #502174 fuel tank support to the #502172 nylon front upper stiffener bracket with a #116308CR 3x8mm cross FH TP screw.
- Attach #502173 5th body post to the nylon front upper stiffener with 1pc 3x8mm cross FH TP screw.
- Slide the #502173 pivoting body mount over the body post so its hole lines up with the fifth hole from the bottom. Then, fasten with a #502173 2x12mm cross RH TP screw. You may need to readjust this depending on your body style.

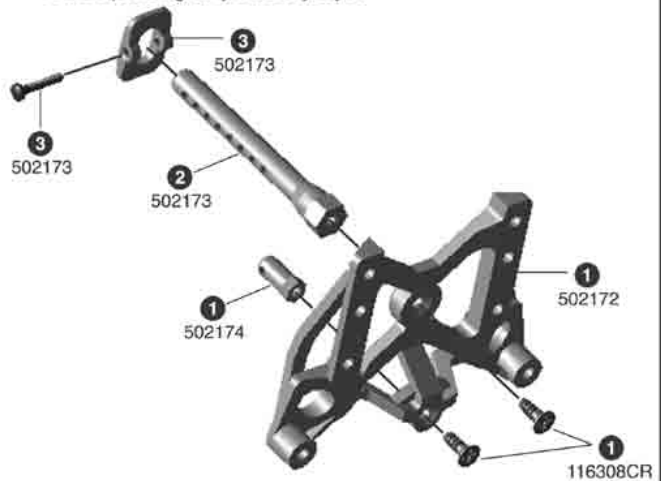

STEP 3

Front Shock Tower Assembly

- 1 Install #126320C 3x20mm cap screws through the lower hole on the #502175 front shock tower.
- 2 Then thread on the #111007ST 3mm steel locknuts & tighten.



STEP 4

- 1 Attach the front upper stiffener assembly to the front bulkheads with 4pcs #116308CR 3x8mm cross FH TP screws.
- 2 Attach the front shock tower assembly to the front bulkheads with 2pcs #116312RCR 3x12 cross RH TP screws.

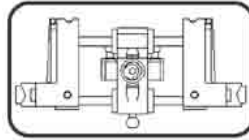

PLEASE ADJUST THE RAIL MOUNTS TO MAKE THE SERVO SAVER MOVEMENT A LITTLE BIT TIGHT & NO EXCESS PLAY. A LITTLE BIT STRESS & TIGHTNESS WILL MAKE THE STEERING SMOOTHER. STRANGE, BUT IT IS TRUE FOR THIS SYSTEM.

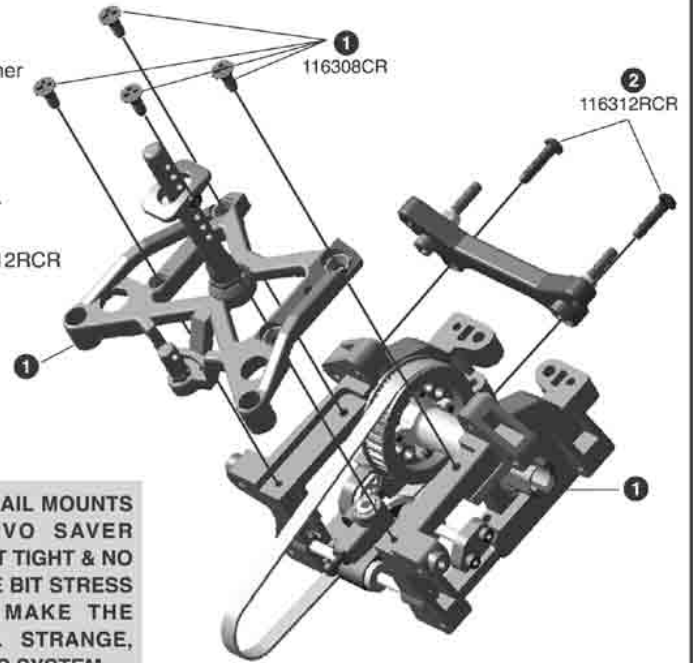

STEP 5

Front Suspension Assembly

- 1 Twist the #115002 ball cups onto the #116134-5 3x45mm adjustable rod until you get the dimension shown (steering rods). Assemble both rods. The end with notch has counter clockwise threads.
- 2 Line up the front lower arm with the bulkhead's lower hole. Push a #K1464 hinge pin (front lower) into the bulkhead & the lower arm.
- 3 Place the #K1462 universal joint in the slot of the front one-way joint cup.
- 4 Line up the front upper arm with the bulkhead's upper hole. Push a #K1463 hinge pin (front upper) into the bulkhead & the upper arm.
- 5 Snap the steering rod into place where shown.
- 6 Please repeat above steps for the left side assembly.

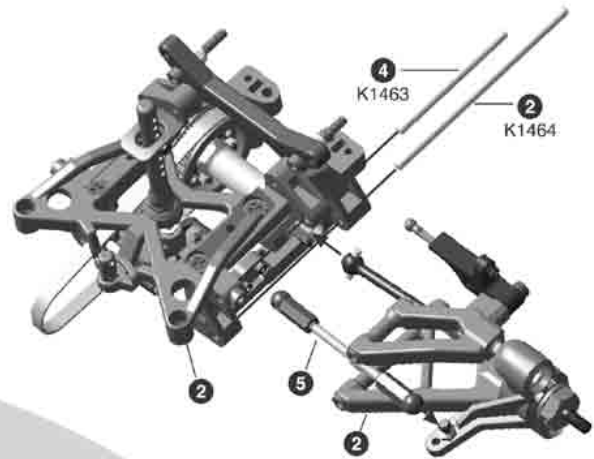
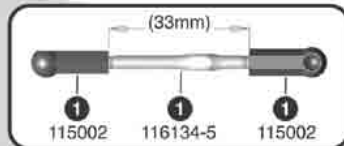

STEP 6

Caster Clip Assembly

- 1 Install #126408S 4x8mm set screw into the bulkhead. **PLEASE REFER TO FINAL ADJUSTMENTS - DROOP SETTING.**
- 2 Install #126305S 3x5mm set screw into the bulkhead. It must contact the flat on the hinge pin.
- 3 Clip in #502179 caster clips. Place all clips on the rear side of the upper arm. **PLEASE REFER TO FINAL ADJUSTMENTS - CASTER SETTING.**
- 4 Please repeat above steps for the left side caster clips assembly.

Sand the arm so that the arm moves freely without any binding or excess play.

