

TRAXXAS

Sway Bar installation Part# 4380

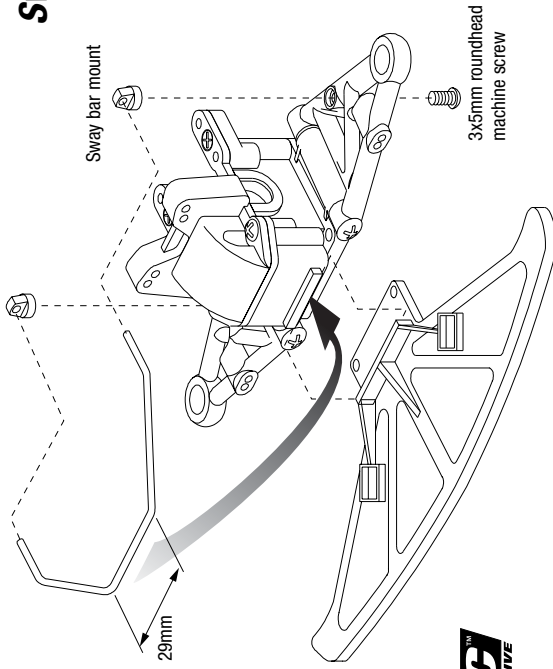

Front sway bar

- 1) Attach the swaybar mounts to the front suspension arms with 3x5mm roundhead machine screws.
- 2) **Remove** the front two lower suspension arm mount screws
- 3) **Loosen** the rear two lower suspension arm mount screws and then remove the front bumper.
- 4) Insert the outer ends of the sway bar through the sway bar mounts and then fit the sway bar between the bumper and the front differential housing (under the lip in the front differential housing).
- 5) Tighten the rear screws in the lower suspension arm mount. Reinstall and tighten the front screws.

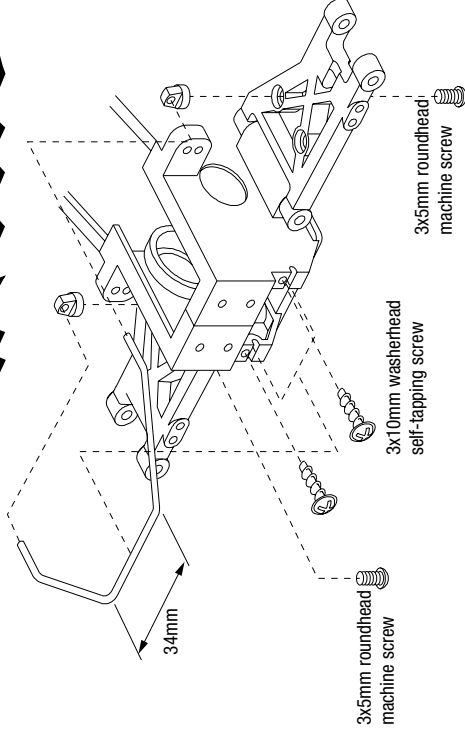

Rear sway bar

- 1) Attach the swaybar mounts to the rear suspension arms with 3x5mm roundhead machine screws.
- 2) Insert the outer ends of the sway bar through the sway bar mounts and then fit the sway bar into the groove molded into the rear side frames.
- 3) Secure the sway bar by installing two 3x10mm washerhead self-tapping screws into the provided holes. The edge of the screw head should overlap and hold the sway bar.

QUESTIONS? 1-888-TRAXXAS (U.S.A. only - outside U.S. call 972-613-3300)

www.traxxas.com • support@traxxas.com

020515

A-TEC
ALL WHEEL DRIVE