

Gear Box Unit

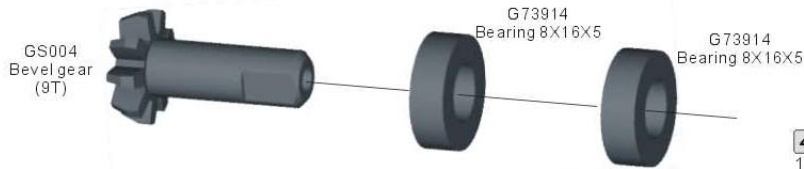

44 Bevel Pinion Gear x2

1. Slide two G73914 8x16x5 bearings onto the GS004 bevel gear.

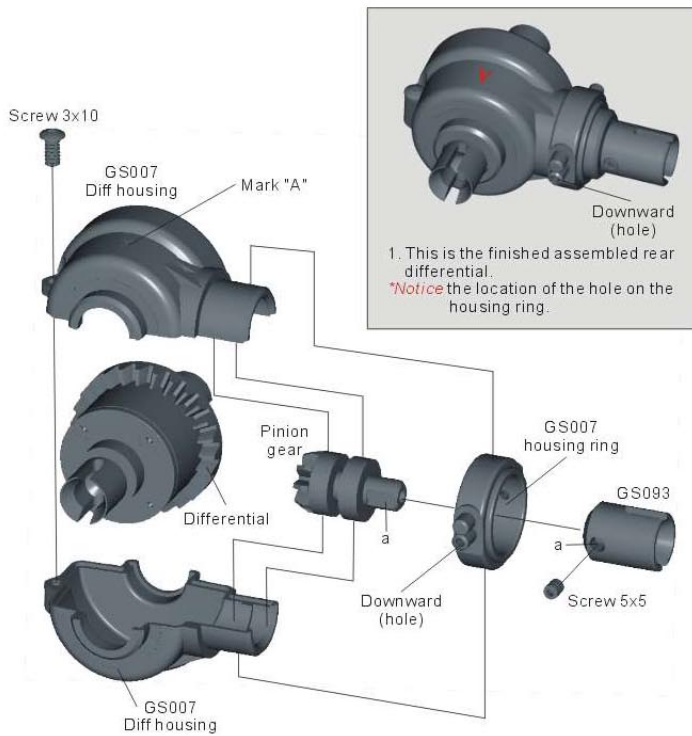

45 Rear Gear Box

1. Place the differential and pinion gears inside the differential housing as pictured in the diagram.
2. Secure with one 3x10 screw and housing ring.

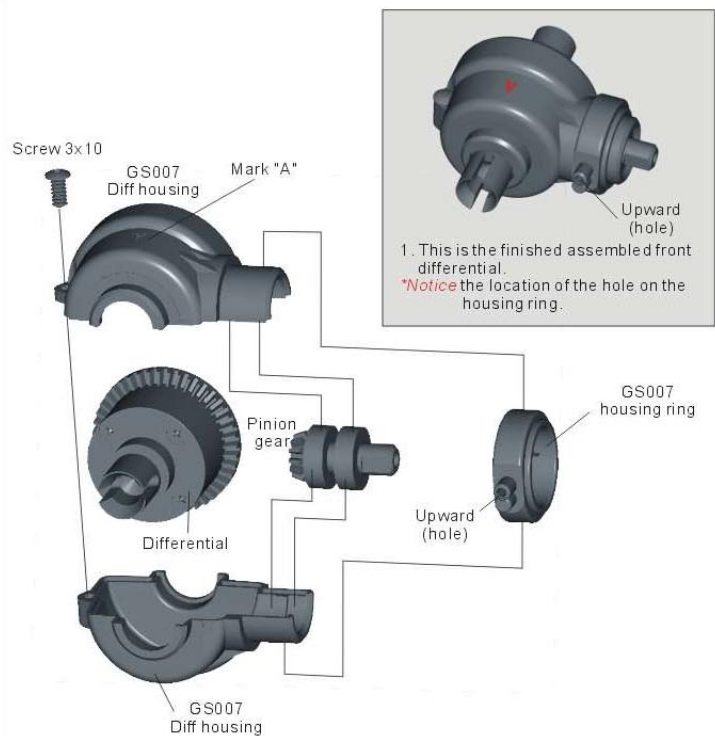

46 Front Gear Box

1. Assemble the differential housing using 3x10 screw and housing ring.

Front / Rear End

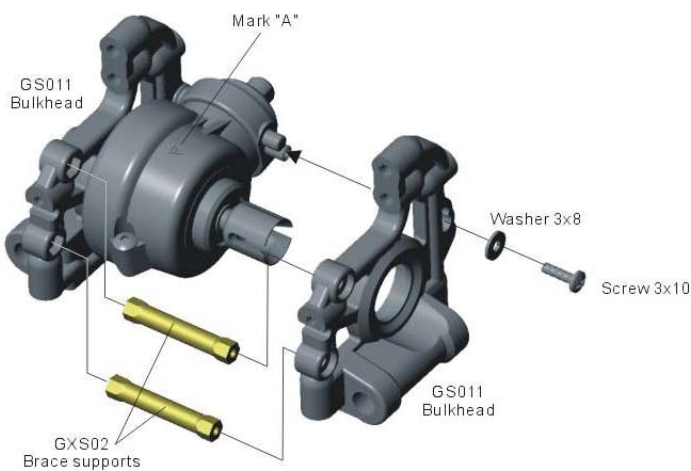

47 Rear(front) Bulkhead

1. Assemble the two GS011 bulkheads together as shown with two GXS02 brace supports.
2. Screw in two 3x10 screws with washers.
3. Repeat for the front.

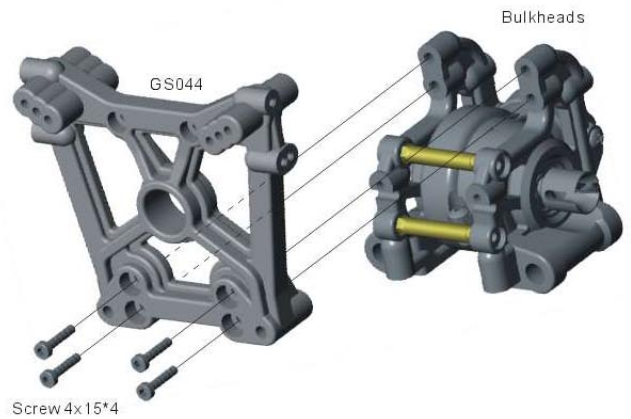

48 Rear(front) Bulkhead

1. Secure the GS044 shock tower to the GS011 bulkheads using four 4x15 cap screws.
2. Repeat for the front.

Transmission Assembly

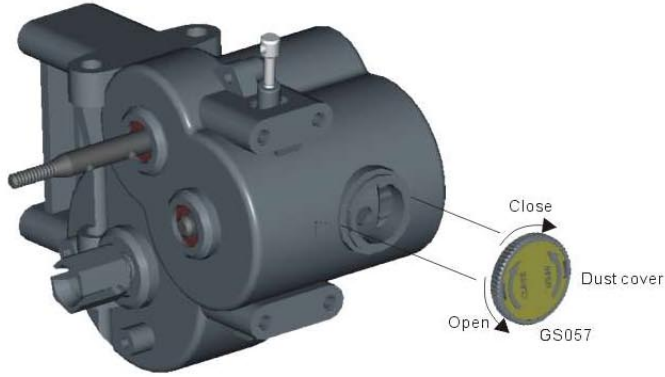

23 Dust Cover

1. Install the dust cover onto the center transmission case by lining up the notches.

24 Disk Brakes

1. Secure the brake disks, pads and plates in the order show in the picture. Make sure you put the brake cam in first followed by the brake puck then the following plates and pads.
2. Align the disks onto the output shafts on each side.
3. Leave the screws just loose enough to allow the transmission to spin freely.
4. Repeat for the other side of the center transmission.

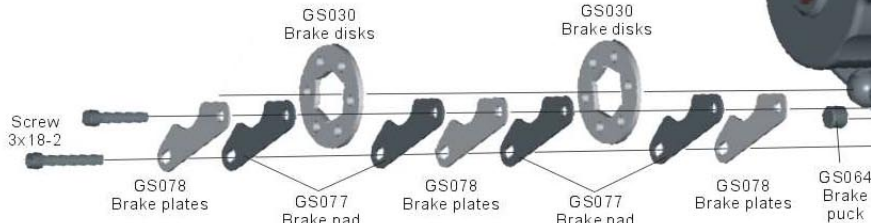
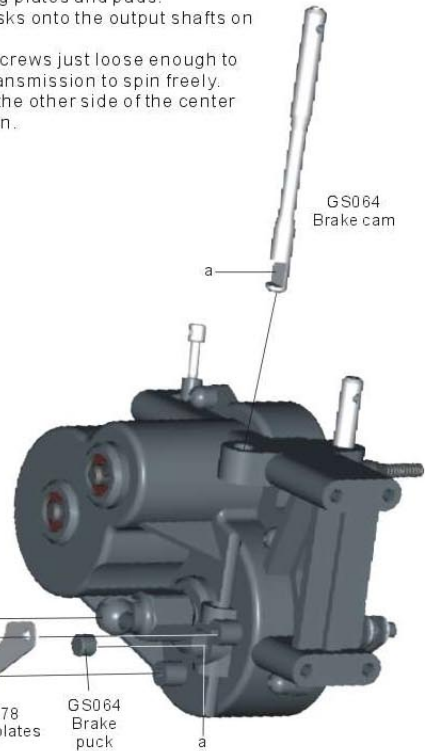

25 External Expanding Clutch

1. Assemble the clutch as shown in the diagram.
2. Start by threading in one setscrew into the center of each clutch shoe.
3. Next insert one 3mm lock nut into each clutch shoe.
4. Place one 5mm ball into the center of each shoe.
5. Next place the GS055 shift hub into the center of the two shoes.
6. Slide one spring onto each of the 3x16 button head screws.
7. Thread the 3x16 screws into the 3mm locknuts. Tighten then down all the way being careful not to crush the spring. Then loosen each screw 7 1/2 turns.
8. Next adjust the setscrews so the ball just hit the internal hub. Watch for the shoe to lift slightly then back off slightly. Repeat on the other shoe.
9. Your clutch is now complete.

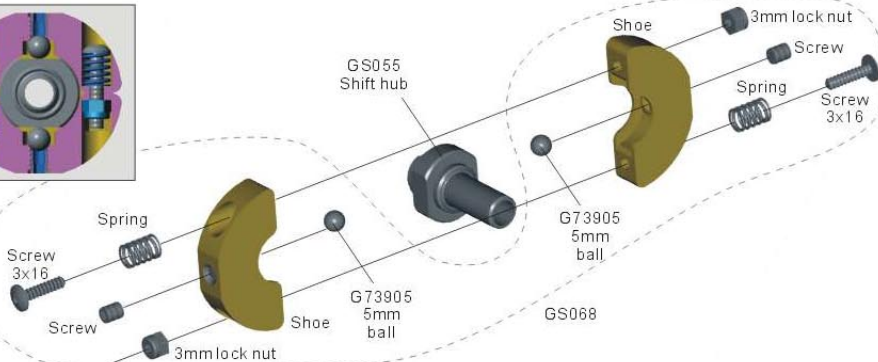

26 External Clutch Gear

1. Insert one G73914 8x16x5 bearing into the GS056 hub.
2. Attach the spur gear to the GS056 hub using three 3x5 screws.



27 External One Way Gear

1. Attach the spur gear to the GS047 one-way hub using three 3x5 screws.



28 External Shift Unit

1. Slide the clutch gear onto the external expanding clutch followed by the one-way gear hub.

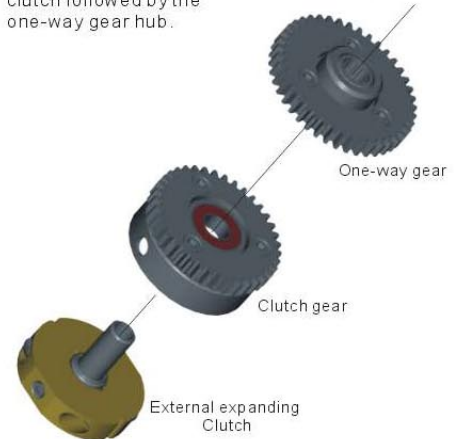

Transmission Assembly

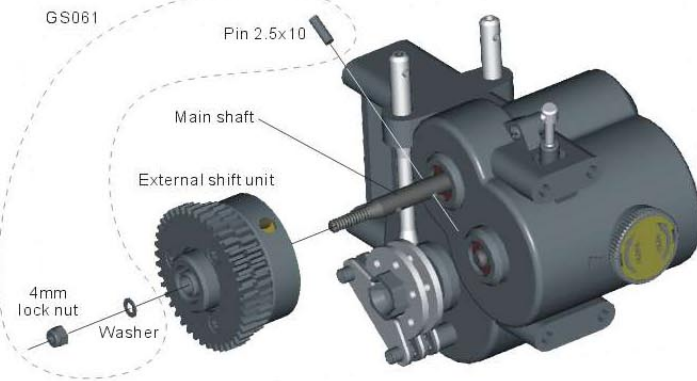

29 Center Drive

- Slide the assembled two-speed onto the main shaft and secure with one lock nut and washer.

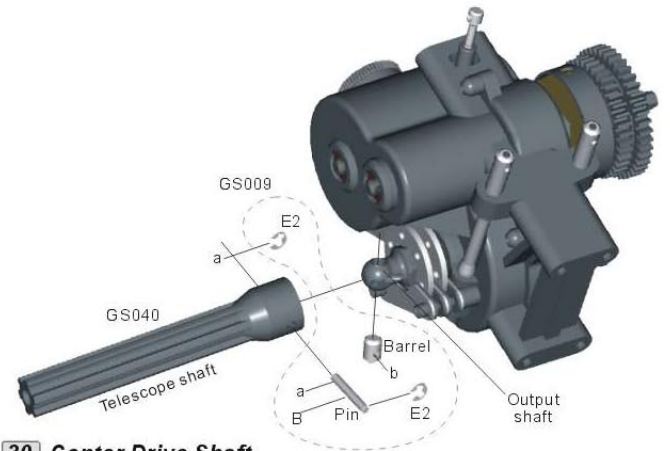

30 Center Drive Shaft

- Insert the outdrive barrel into the output shaft.
- Next, line up the hole in the telescope shaft with the hole in the barrel.
- Secure the pin with two E2 "E" clips

Suspension Assembly

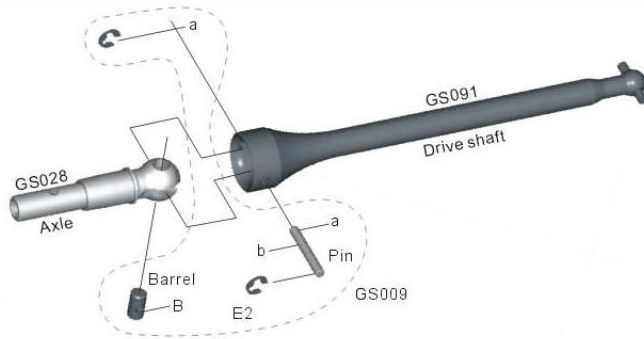

31 Drive Shaft Assembly x4

- Insert one barrel into the axle as shown.
- Align the pin hole on the drive shaft and barrel.
- Push pin through and secure with two E2 "E" clips
- Repeat three more times.

32 Hub and Driveshaft Assembly x4

- Insert one 10x19x5 bearing on the inside of the GS010 hub.
- Insert one 8x16x5 bearing on the outside of the GS010 hub.
- Slide the wheel axle through the hub and bearings as shown in the picture
- Slide on the wheel hub and secure by inserting one 3x19 pin and 5x5 setscrew.
- Repeat for each hub.

"Racer Tip" Thread lock recommended on the 5x5 setscrew.

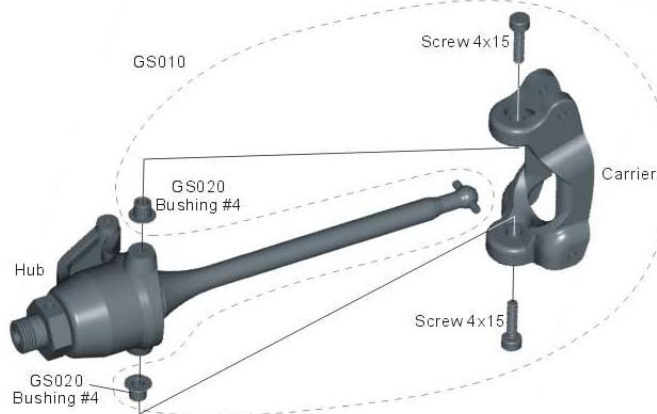

33 Hub and Spindle Assembly x4

- Put two #4 pivot bushings into the carrier as shown in the diagram.
- Line up the spindle pivot bushings and the hub, and tighten down two 4x15 cap head screws.
- Repeat for each hub.



Suspension Assembly

34 Upper Suspension Arm Assembly x4

1. First thread on the GS074 rod end onto the GS067 threaded tie rod.
2. Next thread the tie rod and rod end into the GS033 upper suspension arm.
3. Repeat for the other side.

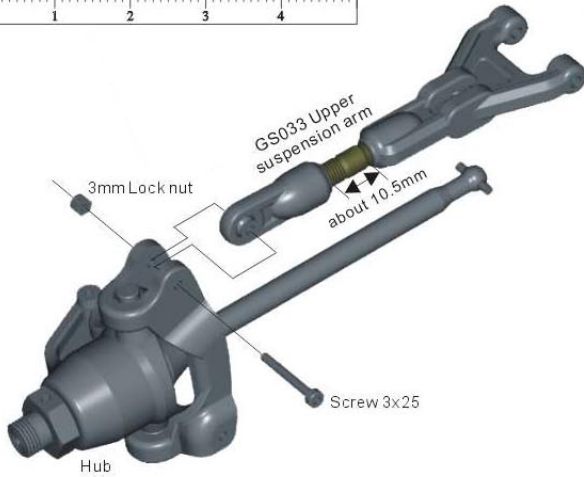
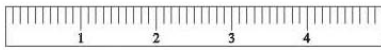
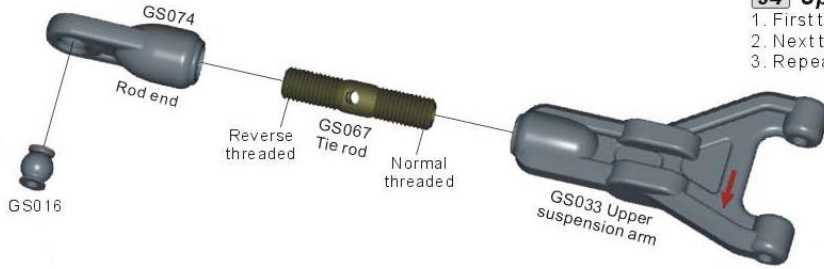

35 Suspension Arm Assembly (Front-right)

1. Attach the upper suspension arm to the hub using one 3x25 screw with 3mm lock nut.
2. Repeat for other side.

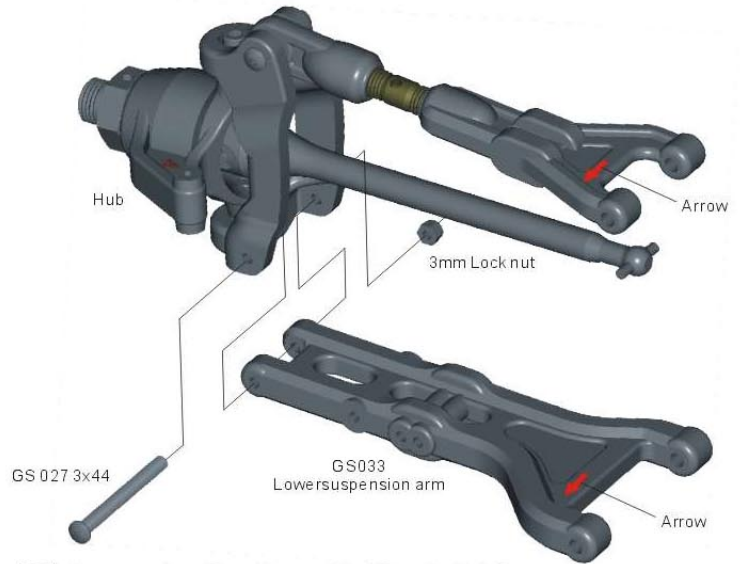

36 Suspension Arm Assembly (Front-right)

1. Attach the lower suspension arm to the hub assembly using one 3x44 screw and 3mm lock nut.

Front-left
(Rear-right for 4WS)

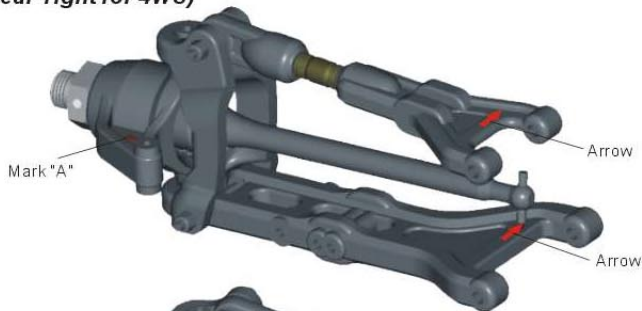

Front-left
(Rear-left for 4WS)

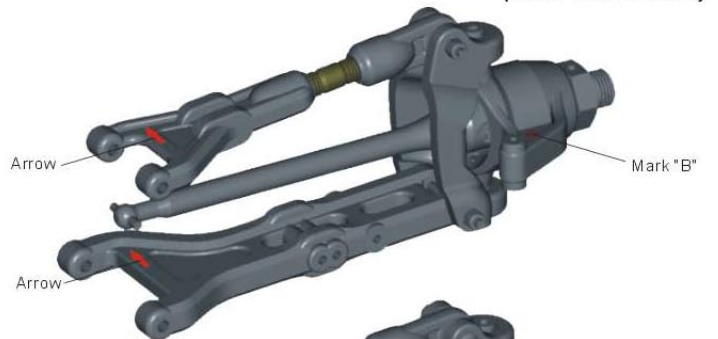

Rear-left
(None for 4WS only)

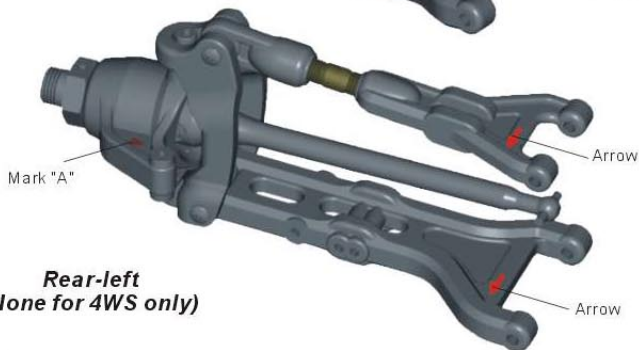

Rear-right
(None for 4WS only)

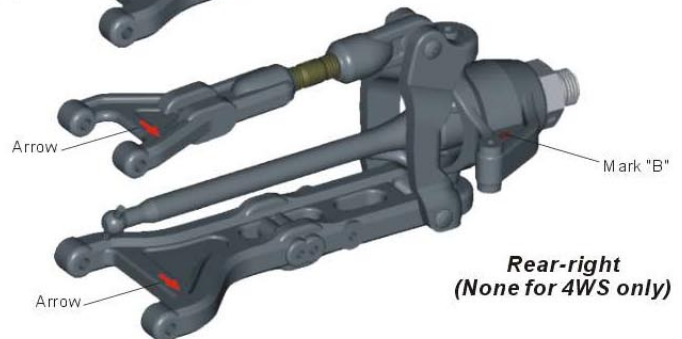

37 Suspension Arms

1. Mount the suspension arms as shown in the diagram. Notice the direction of the arms.

Notice: Look carefully and you will find an arrow. This arrow should always point towards the outside of the truck. Use this arrow for the front and rear.

Differential Assembly

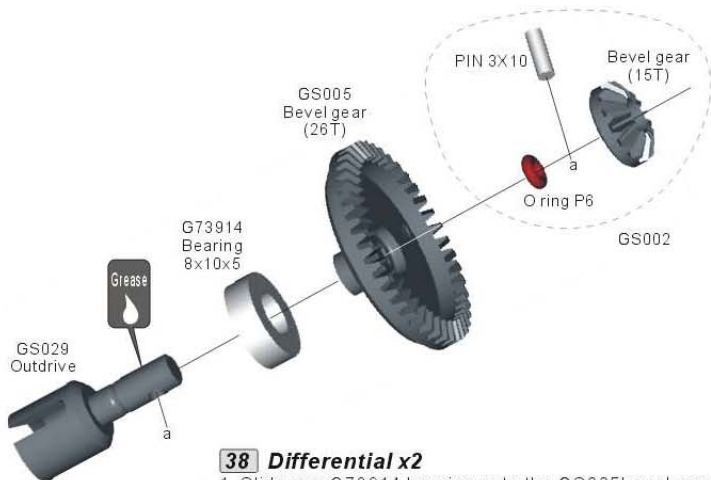

38 Differential x2

1. Slide one G73914 bearing onto the GS005 bevel gear.
2. Insert GS029 outdrive through the center of the GS005 bevel gear.
3. Apply small amount of grease to the outdrive shaft followed by one P6 "O" ring.
4. Insert one 3x10 pin finishing it up with a 15T gear. Make sure you line the slot on the gear with the pin.
5. Repeat one more time.

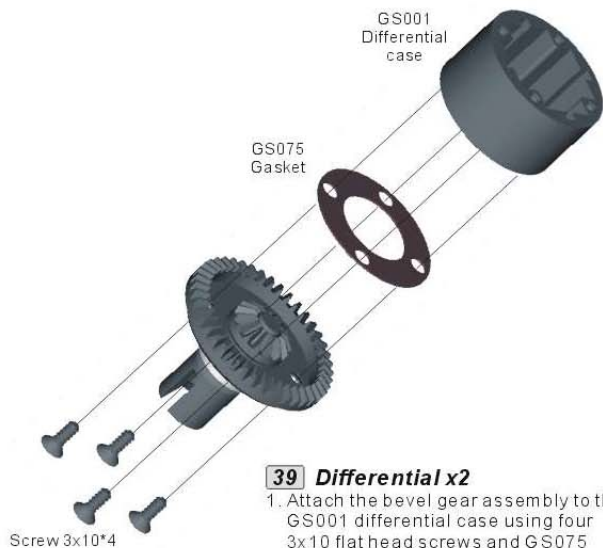

39 Differential x2

1. Attach the bevel gear assembly to the GS001 differential case using four 3x10 flat head screws and GS075 gasket. Carefully tighten screws down equally to ensure a good seal.
2. Repeat one more time.

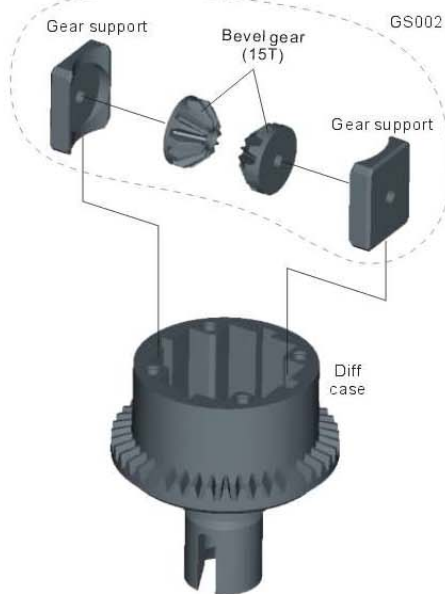

40 Differential x2

1. Install two small bevel gears and gear supports into the differential case. Carefully install everything making sure the bevel gears on the gears stay correctly in place.
2. Repeat one more time.



41 Differential x2

1. Fill the differential to the top of the smaller gears with silicon fluid.
*Don't over fill or the differential will leak.

42 Differential x2

1. Slide one G73914 bearing onto the differential case cover.
2. Insert the GS029 outdrive through the GS060 differential case cover.
3. Apply a small amount of grease to the outdrive shaft followed by a P6 "O" ring seal.
4. Insert one 3x10 pin.
5. Repeat one more time.

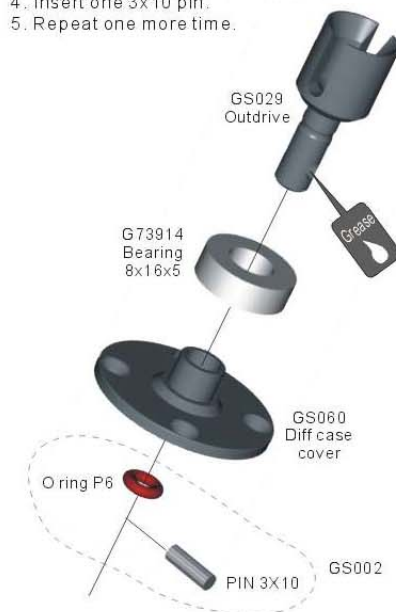

43 Differential x2

1. Put the 15T bevel gear together as shown in the picture.
2. Carefully center the GS075 gasket onto the differential case. Make sure you line up the screw holes accurately.
3. Put the two halves together as shown in the picture. Secure with four 3x10 screws.

"Racer Tip" Tighten down the four screws evenly making sure they are all equally snug.

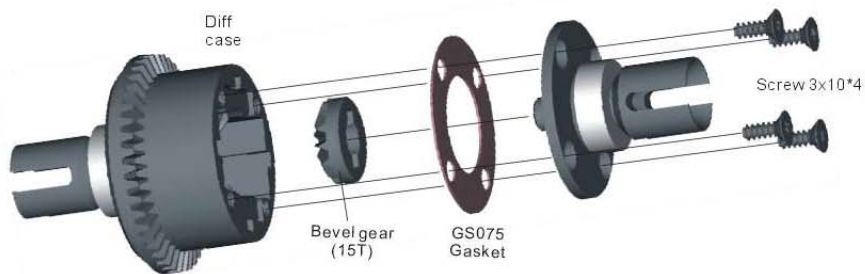

Transmission Assembly

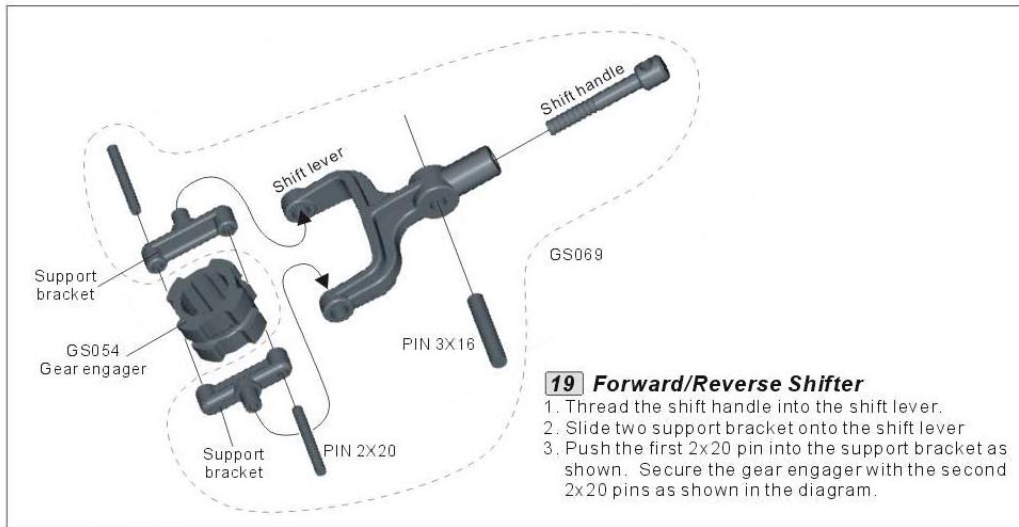

19 Forward/Reverse Shifter

1. Thread the shift handle into the shift lever.
2. Slide two support bracket onto the shift lever
3. Push the first 2x20 pin into the support bracket as shown. Secure the gear engager with the second 2x20 pins as shown in the diagram.

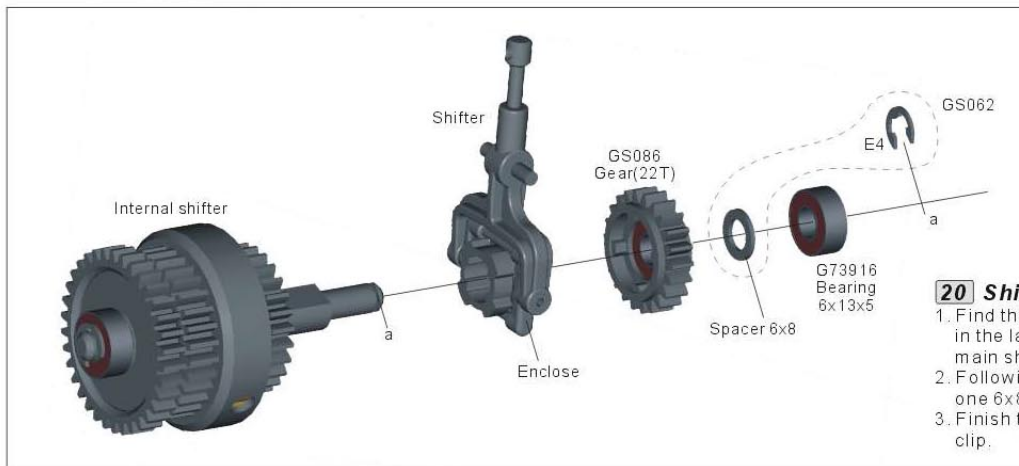
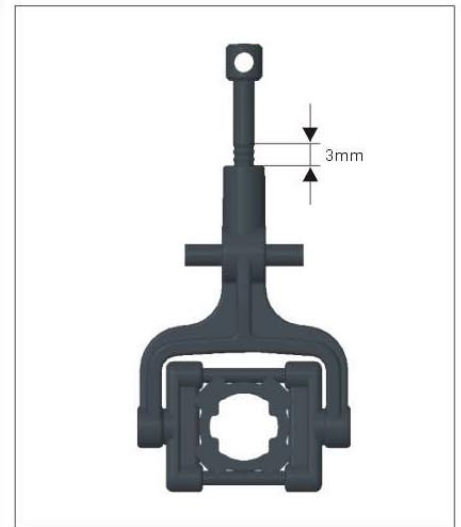

20 Shift Unit

1. Find the internal shift gear assembly that was completed in the last section. Slide the shift assembly onto the main shaft as shown in the diagram.
2. Following the shifter, install the GS086 gear followed by one 6x8 spacer.
3. Finish this step with one 6x13x5 bearing and one E4 "E" clip.

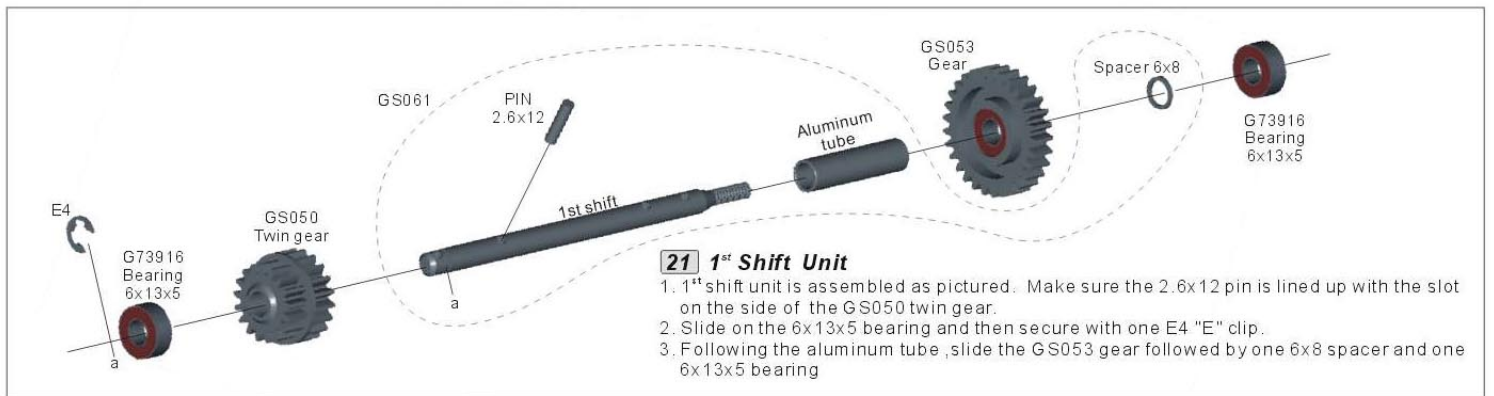

21 1st Shift Unit

1. 1st shift unit is assembled as pictured. Make sure the 2.6x12 pin is lined up with the slot on the side of the GS050 twin gear.
2. Slide on the 6x13x5 bearing and then secure with one E4 "E" clip.
3. Following the aluminum tube, slide the GS053 gear followed by one 6x8 spacer and one 6x13x5 bearing

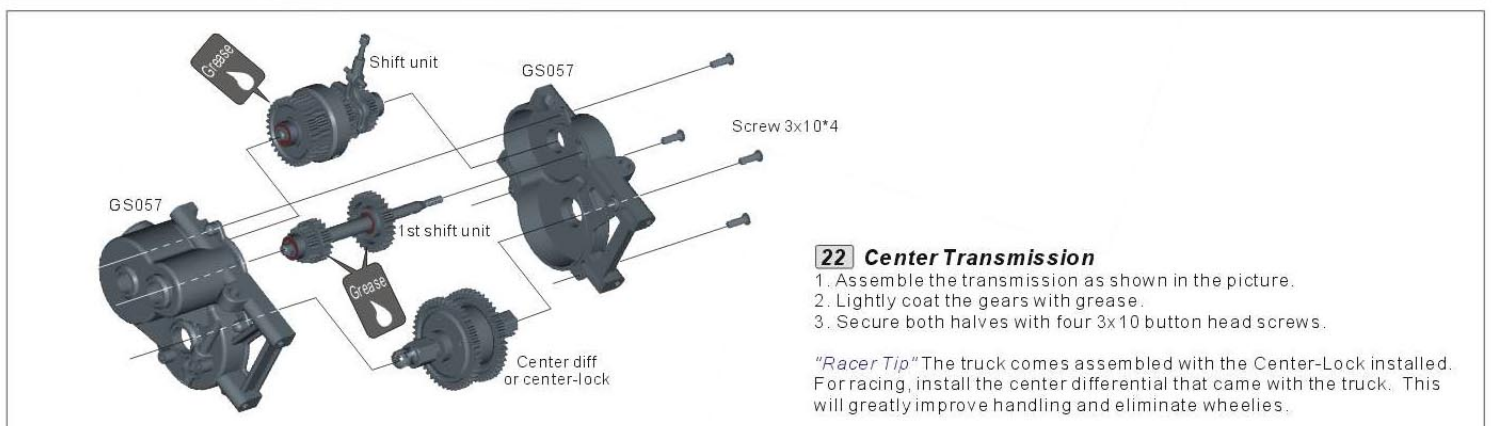

22 Center Transmission

1. Assemble the transmission as shown in the picture.
2. Lightly coat the gears with grease.
3. Secure both halves with four 3x10 button head screws.

"Racer Tip" The truck comes assembled with the Center-Lock installed. For racing, install the center differential that came with the truck. This will greatly improve handling and eliminate wheelies.