

HUGHES 500D

ENGINE SIZE:60

GENERAL INSTALLATION MANUAL

NOTICE: USE EPOXY UNLESS STATED.
SAND INSIDE FUSELAGE WITH #180 SANDING
PAPER BEFORE PARTS GLUING IN PLACE.

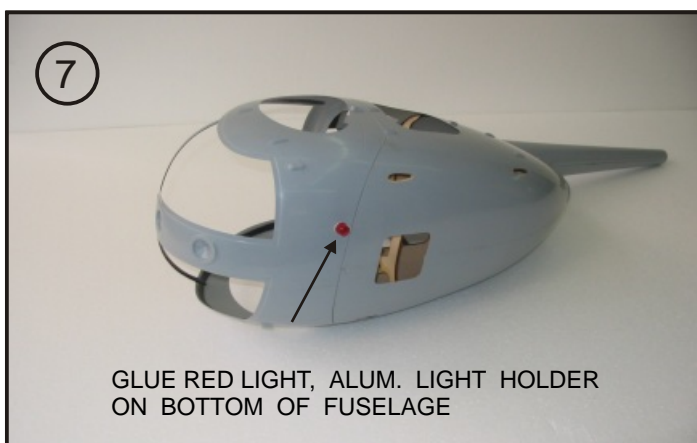
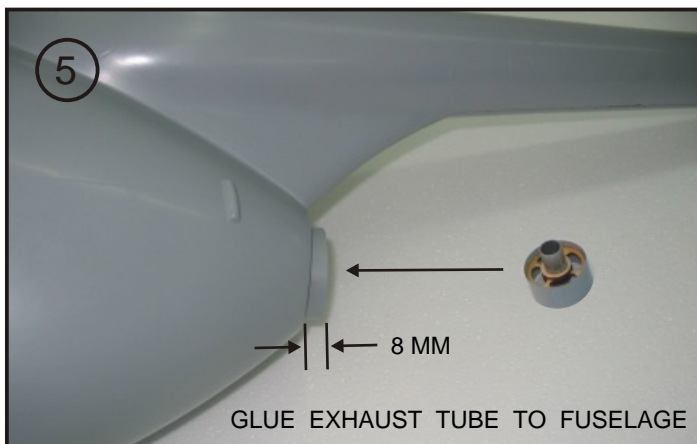
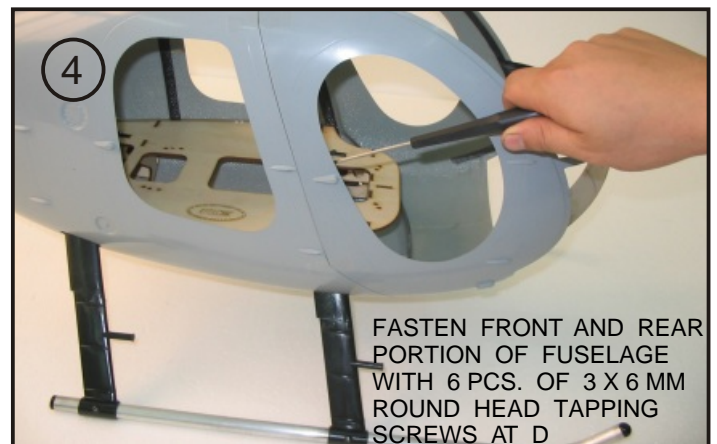

HUGHES 500D

ENGINE SIZE:60

GENERAL INSTALLATION MANUAL

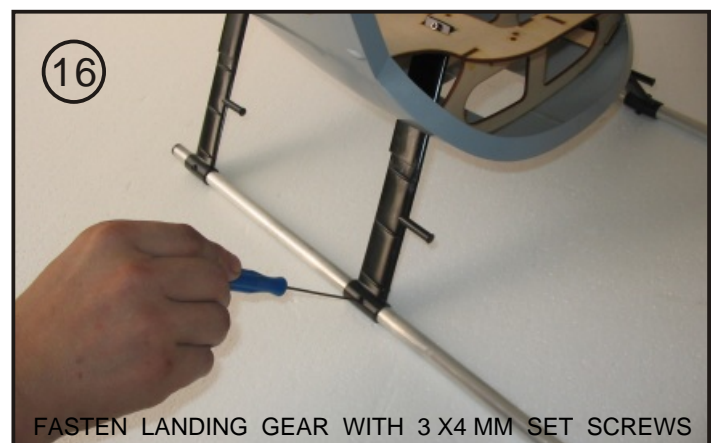
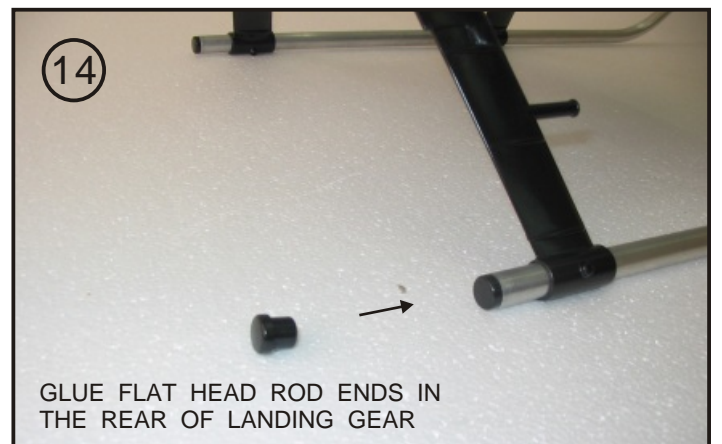
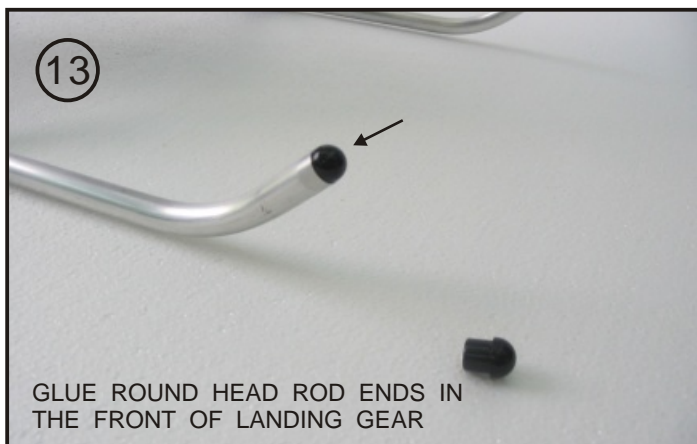
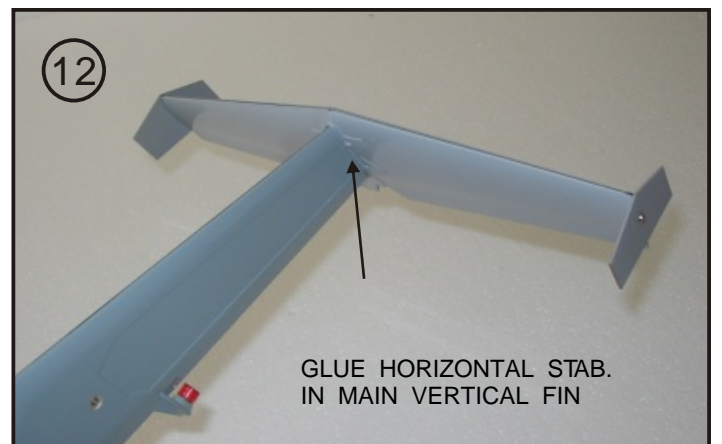
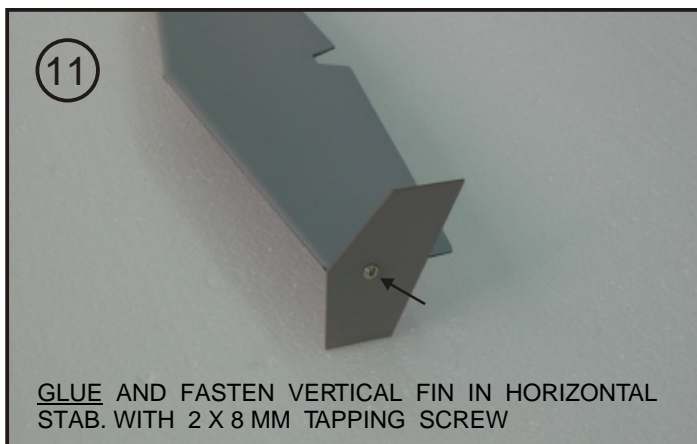
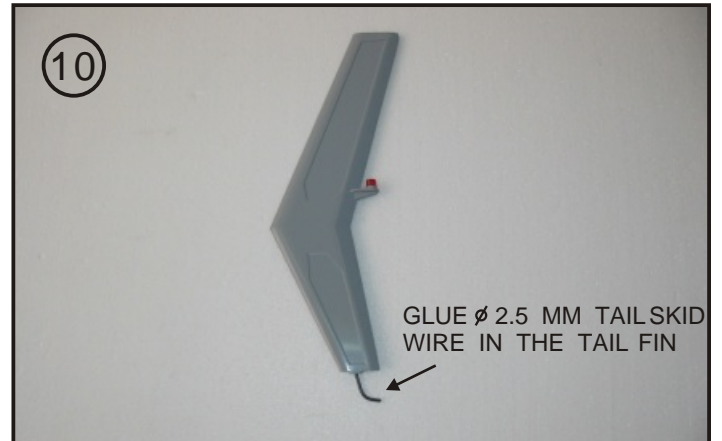
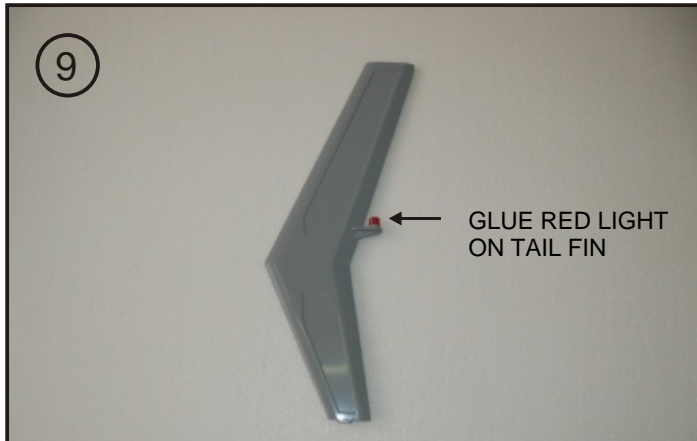

HUGHES 500D

ENGINE SIZE:60

GENERAL INSTALLATION MANUAL

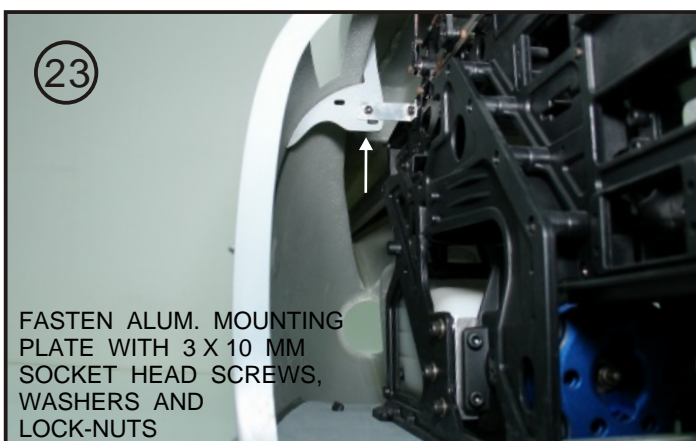
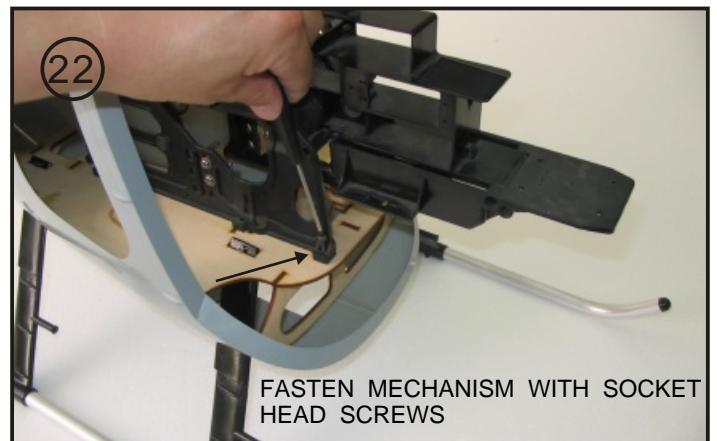
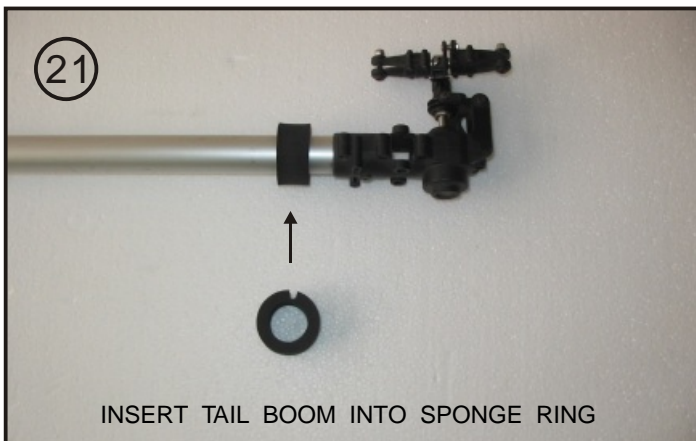
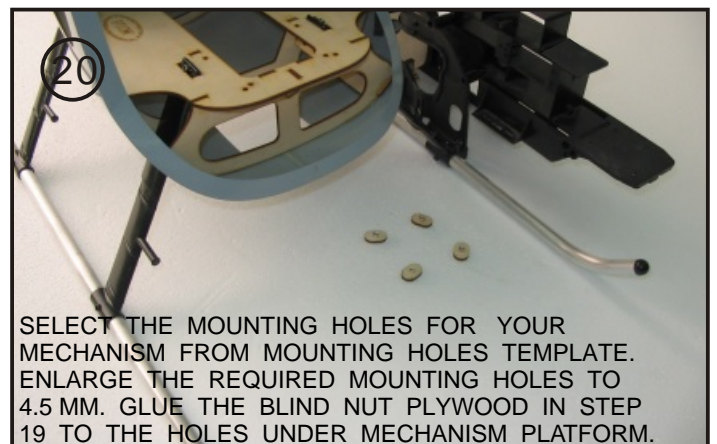
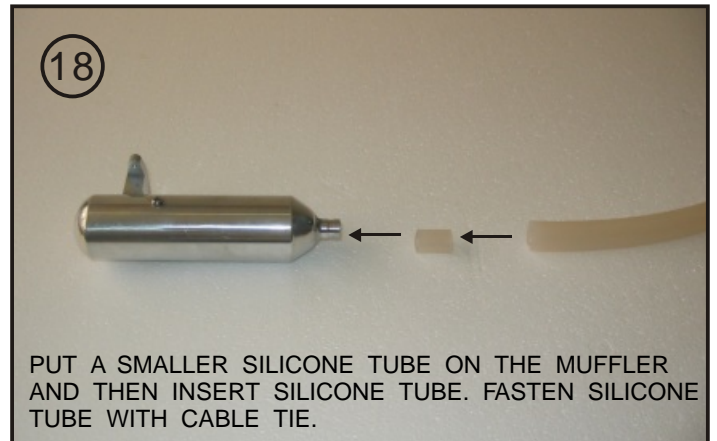

HUGHES 500D

ENGINE SIZE:60

MECHANISM MOUNTING HOLES TEMPLATE

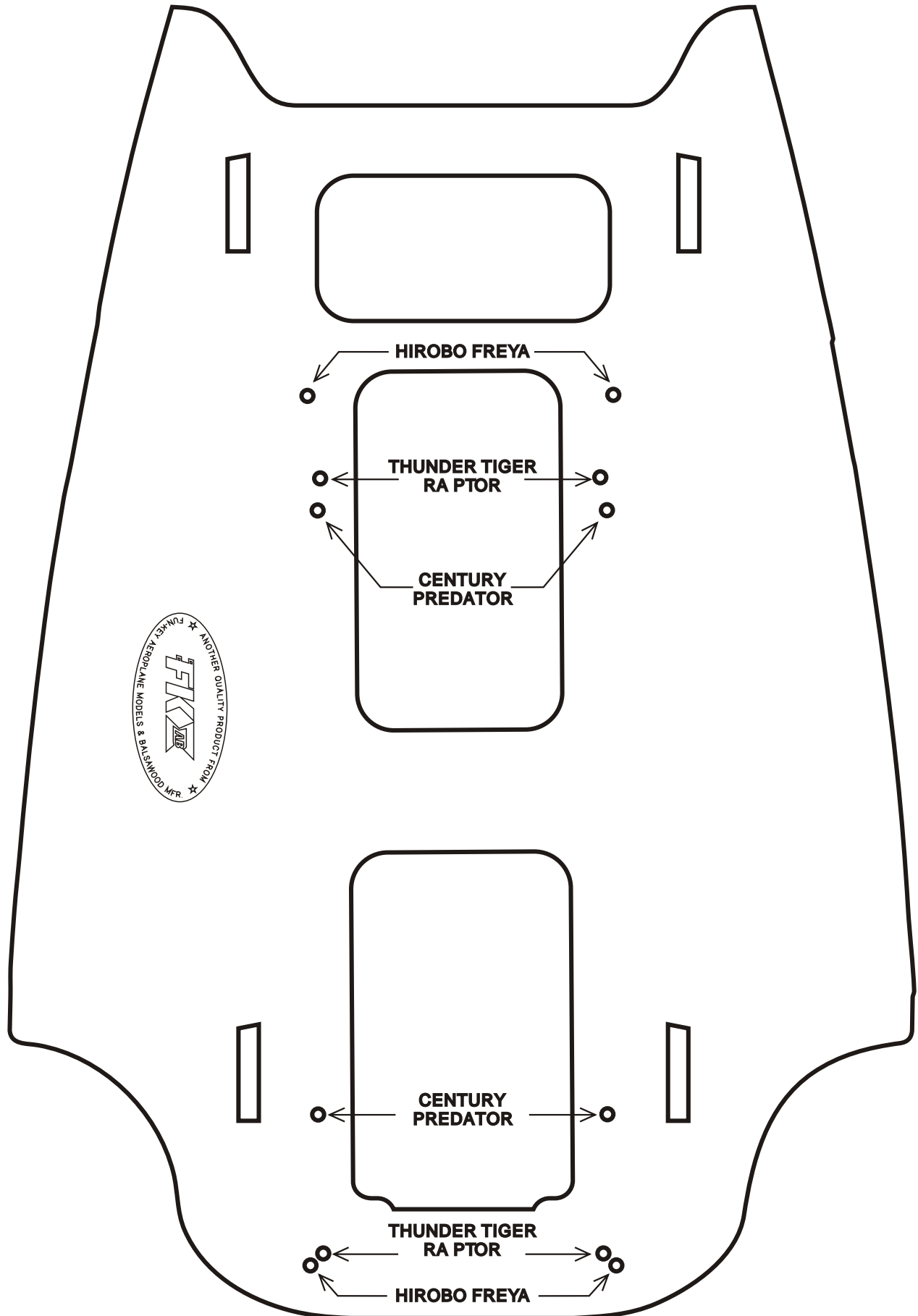

HUGHES 500D

ENGINE SIZE:60

MOUNTING HOLES FOR MAIN VERTICAL FIN TEMPLATE

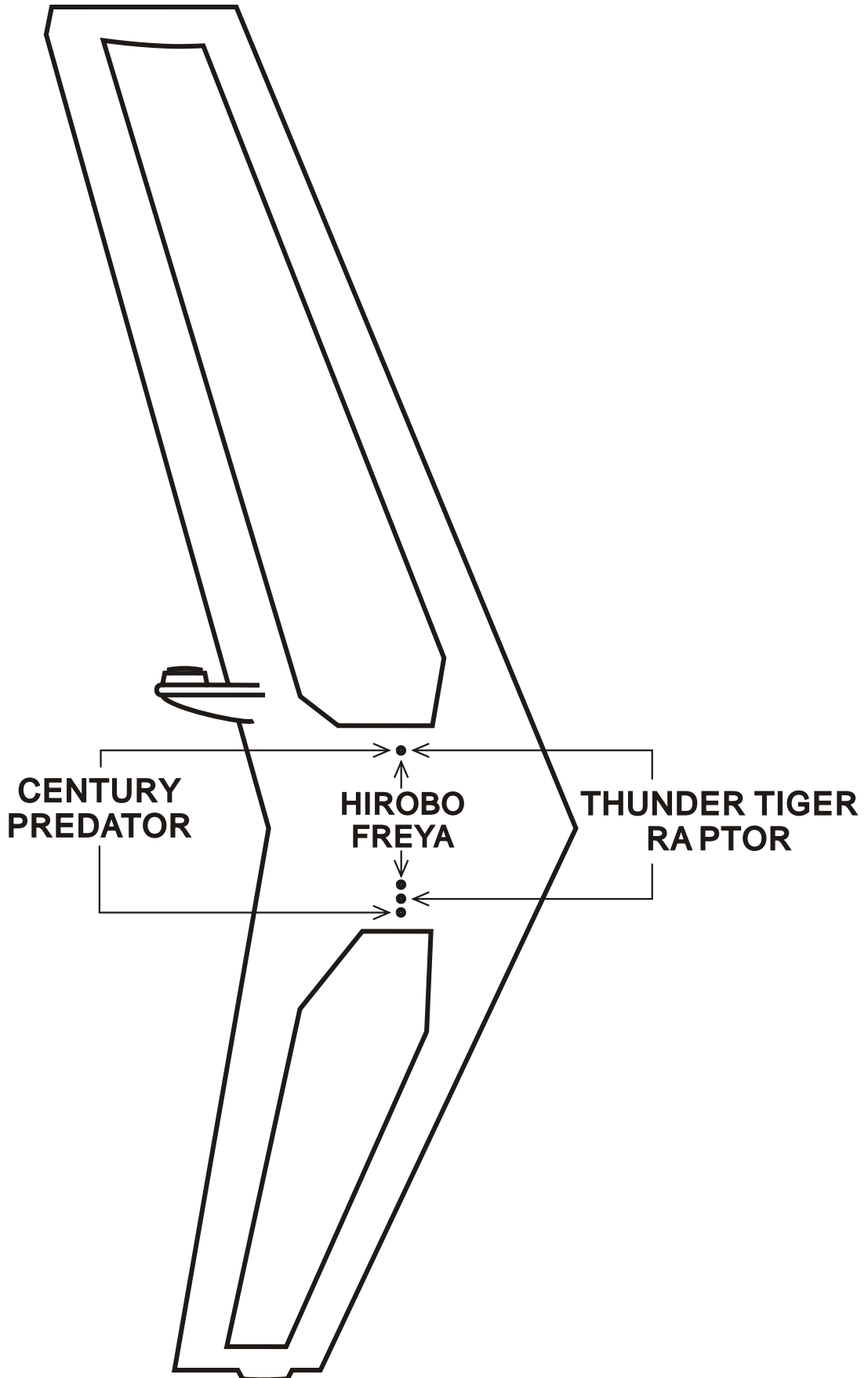

HUGHES 500D

ENGINE SIZE:60

INSTALLATION OF CENTURY PREDATOR MECHANISM

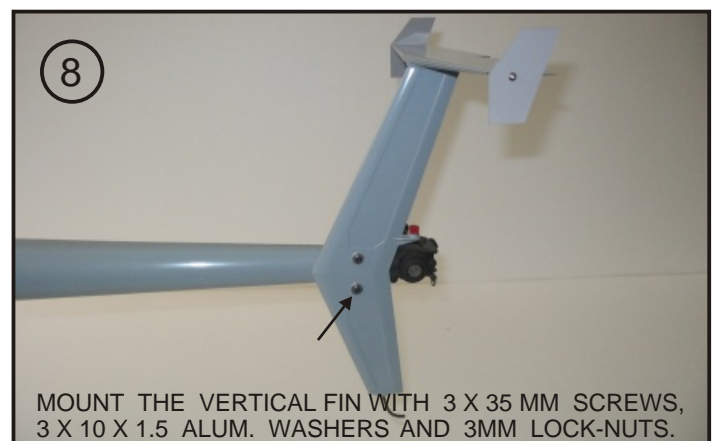
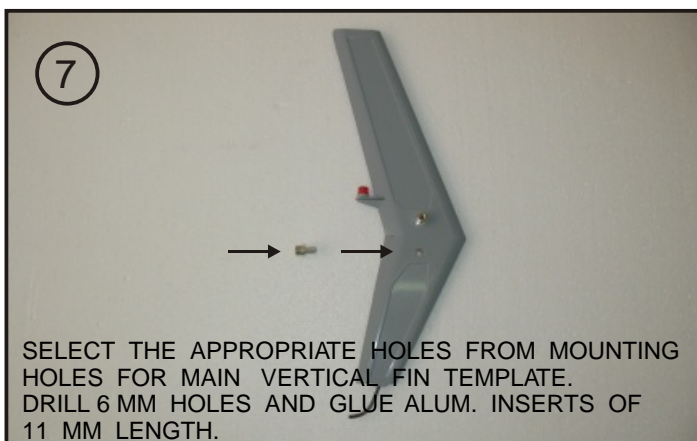
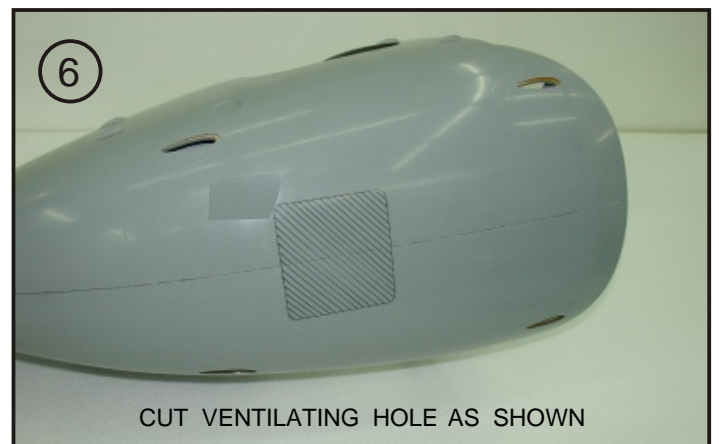
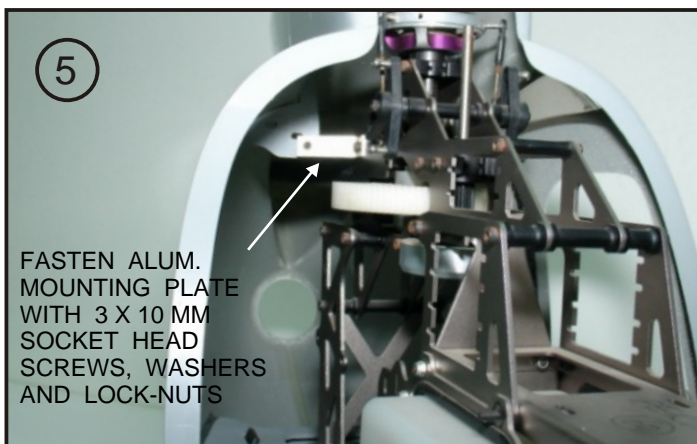
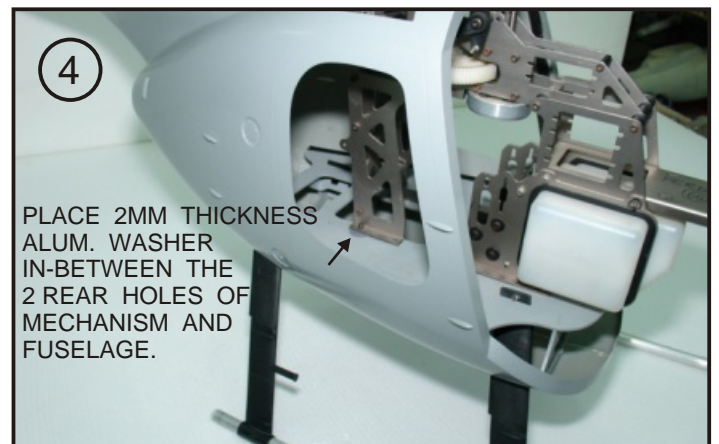
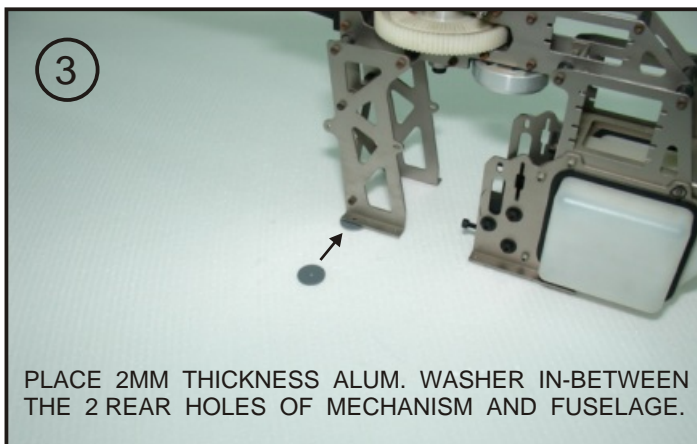
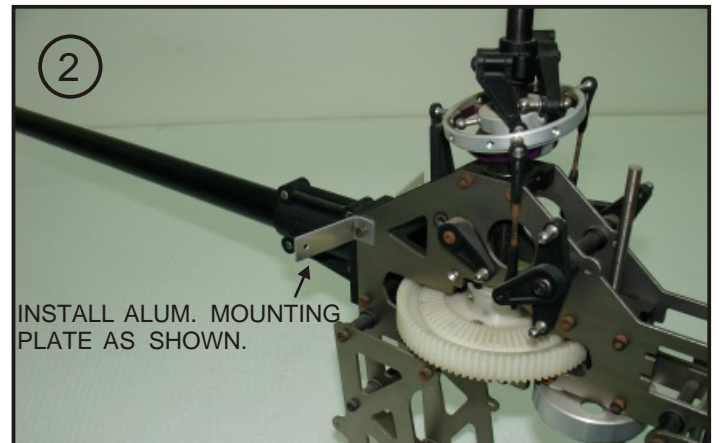
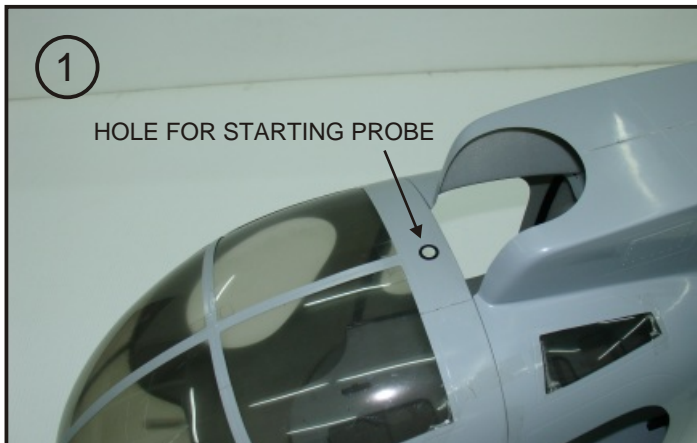

HUGHES 500D

ENGINE SIZE:60

INSTALLATION OF HIROBO FREYA MECHANISM

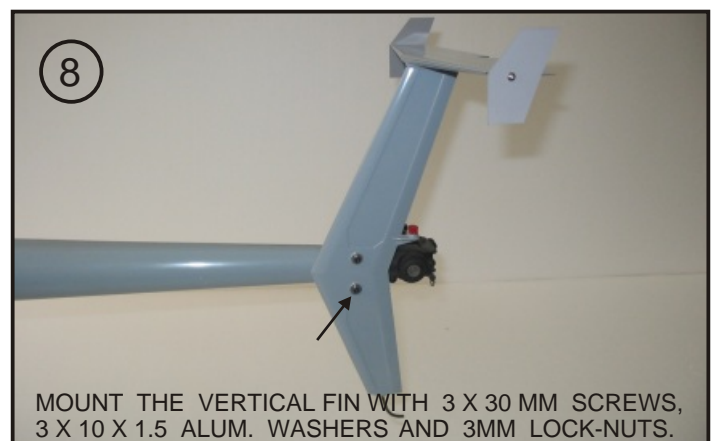
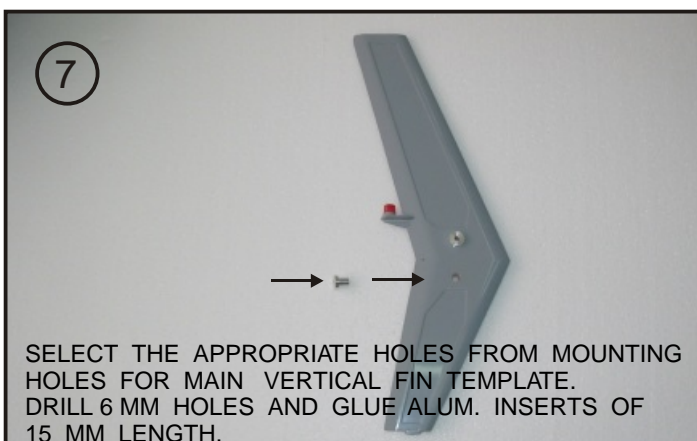
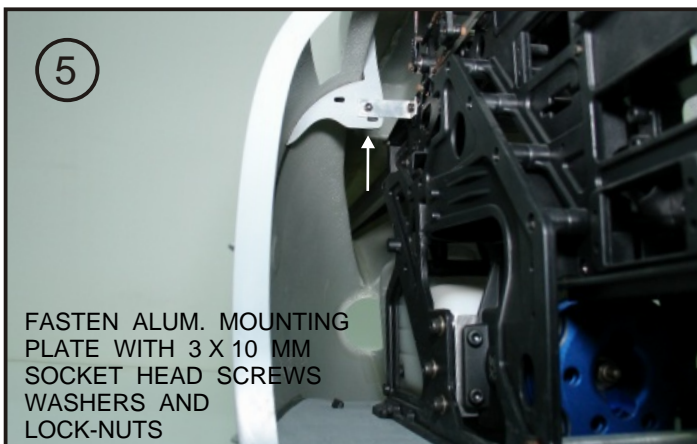
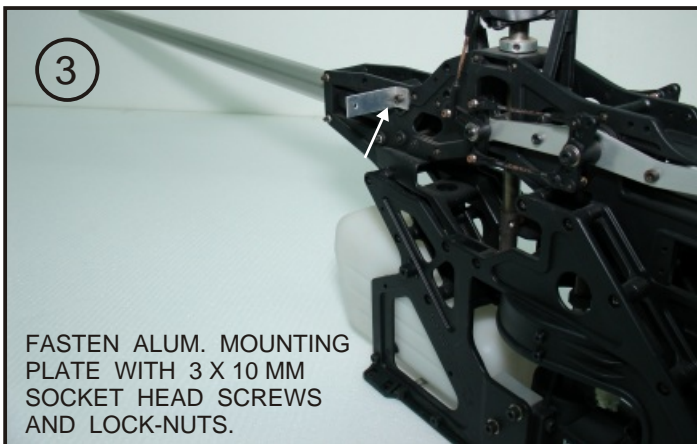
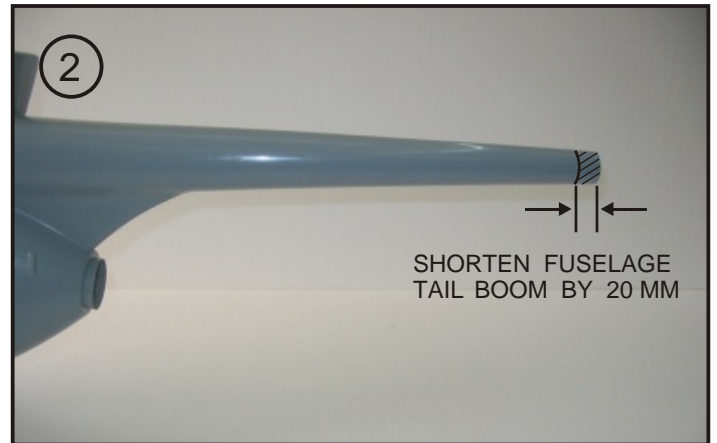
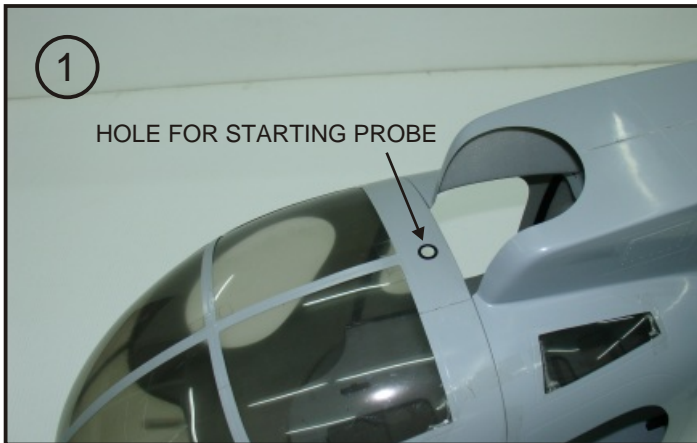

HUGHES 500D

ENGINE SIZE:60

INSTALLATION OF THUNDER TIGER RAPTOR MECHANISM

