

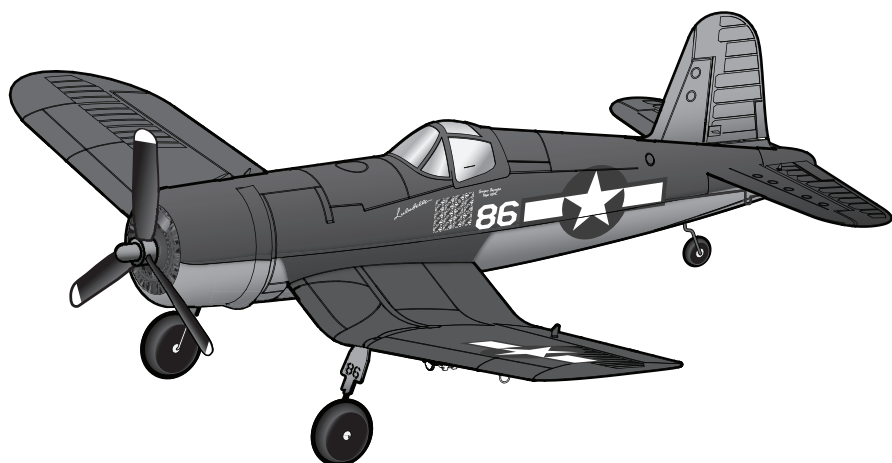

Ultra Micro F4U Corsair RTF/BNF



Instruction Manual
Bedienungsanleitung
Manuel d'utilisation
Manuale di Istruzioni



BIND-N-FLY SPEKTRUM DSM TECHNOLOGY



NOTICE

All instructions, warranties and other collateral documents are subject to change at the sole discretion of Horizon Hobby, Inc. For up-to-date product literature, visit www.horizonhobby.com and click on the support tab for this product.

Meaning of Special Language:

The following terms are used throughout the product literature to indicate various levels of potential harm when operating this product:

NOTICE: Procedures, which if not properly followed, create a possibility of physical property damage AND little or no possibility of injury.

CAUTION: Procedures, which if not properly followed, create the probability of physical property damage AND a possibility of serious injury.

WARNING: Procedures, which if not properly followed, create the probability of property damage, collateral damage, and serious injury OR create a high probability of superficial injury.

 **WARNING:** Read the ENTIRE instruction manual to become familiar with the features of the product before operating. Failure to operate the product correctly can result in damage to the product, personal property and cause serious injury.

This is a sophisticated hobby product. It must be operated with caution and common sense and requires some basic mechanical ability. Failure to operate this Product in a safe and responsible manner could result in injury or damage to the product or other property. This product is not intended for use by children without direct adult supervision. Do not attempt disassembly, use with incompatible components or augment product in any way without the approval of Horizon Hobby, Inc. This manual contains instructions for safety, operation and maintenance. It is essential to read and follow all the instructions and warnings in the manual, prior to assembly, setup or use, in order to operate correctly and avoid damage or serious injury.

Age Recommendation: Not for children under 14 years. This is not a toy.

Congratulations on your purchase of the finest ultra micro RC Corsair available. If you've flown the larger ParkZone Corsair, you'll find this one flies sport aerobatics every bit as well, only in a much smaller space. Before you take the first flight, though, please take time to read through this manual. It has important pre-flight information that will help ensure your first flight is a great one.

Table of Contents

First Flight Preparation	3	Remove Propeller Shaft.....	12
Charging the Battery.....	4	Installing Propeller Shaft	12
Battery Warnings	5	Flying Tips and Repairs.....	13
Low Voltage Cutoff (LVC)	5	Additional Safety Precautions	
Transmitter and Receiver Binding.....	6	and Warnings.....	14
Before Flight.....	6	Maintenance After Flying.....	14
Installing Transmitter Battery.....	6	Troubleshooting Guide	14
Transmitter Control.....	7	Warranty and Repair Policy.....	16
Digital Trims.....	7	Warranty and Service Information.....	17
Dual Rate Function	7	FCC Information.....	17
Control Direction Test.....	8	Compliance Information for	
Reverse Controls.....	9	the European Union	17
Control Centering	9	Declaration of Conformity	18
Control Rates.....	10	Instructions for disposal of WEEE	
Settings for Control Horns	10	by users in the European Union.....	18
Installing Flight Battery.....	10	Replacement Parts.....	70
Adjusting Center of Gravity (CG).....	11	Optional Parts and Accessories.....	71
Removing and Installing Landing Gear.....	11	Decal Application (Option 1).....	72
Propeller and Propeller		Decal Application (Option 2).....	73
Shaft Maintenance.....	12	Parts Contact Information.....	74
Removing and Installing the Propeller.....	12		

First Flight Preparation

- Remove and inspect contents
 - Install batteries into battery charger
 - Begin charging the flight battery
 - Install batteries into the included transmitter (RTF ONLY)
 - Install fully charged flight battery into aircraft
 - Bind the receiver to a transmitter (BNF ONLY)
 - Perform the Control Direction Test with the transmitter
 - Adjust flight controls and transmitter
 - Adjust battery for center of gravity (CG)
 - Perform a radio system Range Check
 - Find a safe and open area
 - Plan flight for flying field conditions
- Note:** For Decal Application Options refer to the back of this manual.

F4U Corsair Specifications	
Wingspan	15.9 in (405mm)
Length	12.8 in (326mm)
Weight	1.47 oz (41.8 g)

F4U Corsair Features	Bind-N-Fly Version	Ready-to -Fly Version
Onboard Electronics Spektrum AR6400 Receiver/Servos/ ESC/ 2 SPMAS2000L Servos	Installed	Installed
Battery 150mAh 3.7V 12C Li-Po	Included	Included
Charger 1S 3.7V Li-Po Battery Charger	Included	Included
Transmitter DSM 4-Channel Transmitter, 2.4GHz	Sold Separately	Included

To register your product online, go to www.parkzone.com

Charging the Battery

Your F4U Corsair comes with a 1S 3.7V Li-Po Battery Charger and 1S Li-Po battery. It is important that you only charge with the included charger, or the E-flite® Celectra™ 4-port Charger (EFLC1004). The flight battery will be required to confirm proper aircraft operation in future steps.

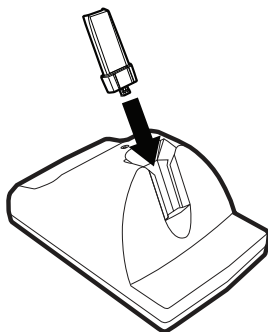

The Battery Charging Process

1. Charge only batteries that are cool to the touch and are not damaged. Look at the battery to make sure it is not damaged e.g., swollen, bent, broken or punctured.
 2. Remove the cover on the bottom of the charger and install four of the included AA batteries, noting proper polarity. Replace the cover after the AA batteries are installed.
 3. Slide the battery into the slot on the charger. The end cap of the battery is specifically designed to allow the battery to fit into the slot one way (usually with the label on the battery facing outward) to prevent reverse polarity connection. However, check for proper alignment and polarity before proceeding to the next step.
 4. Gently press the battery and its connector into the charge jack/connector located at the bottom of the slot in the charger.
 5. When you make the connection successfully, the LED on the charger turns solid red, indicating charging has begun.
 6. Charging a fully discharged (not over-discharged) 150mAh battery takes approximately 30–40 minutes. As the battery nears full charge, the LED begins to blink.
 7. When the battery is fully charged, the LED blinks approximately every 20 seconds or goes out entirely. **Note:** If the LED stays on when the battery is removed, the AA batteries in the charger are low.
 8. Always unplug the battery from the charger immediately upon completion of charging.
- ⚠ CAUTION:** Overcharging a battery can cause a fire.

⚠ CAUTION: Only use a charger specifically designed to charge a Li-Po battery. Failure to do so could result in fire causing injury or property damage.

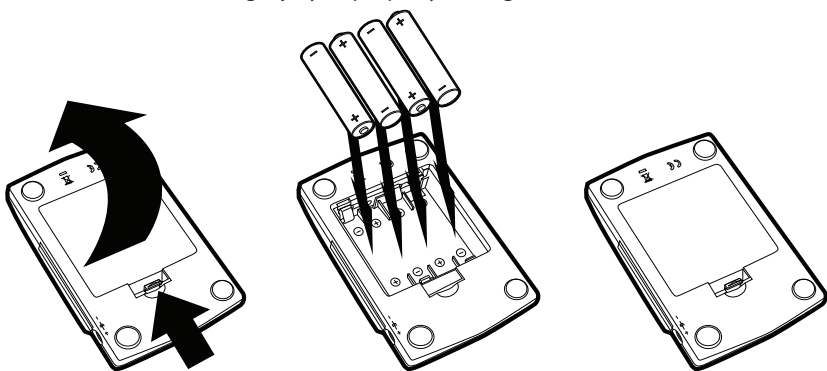

⚠ CAUTION: Only use an E-flite 6V power supply (EFLC1005) with this charger. DO NOT use a 12V power supply or property damage and injury could occur.

Battery Warnings

The Battery Charger (EFLC1003) included with the F4U Corsair has been designed to safely charge the Li-Po battery.

 **CAUTION:** All instructions and warnings must be followed exactly. Mishandling of Li-Po batteries can result in a fire, personal injury, and/or property damage.

- By handling, charging or using the included Li-Po battery you assume all risks associated with lithium batteries.
 - If at any time the battery begins to balloon or swell, discontinue use immediately. If charging or discharging, discontinue and disconnect. Continuing to use, charge or discharge a battery that is ballooning or swelling can result in fire.
 - Always store the battery at room temperature in a dry area for best results.
 - Always transport or temporarily store the battery in a temperature range of 40–120° F. Do not store battery or model in a car or direct sunlight. If stored in a hot car, the battery can be damaged or even catch fire.
- Always charge batteries away from flammable materials.
 - NEVER USE AN Ni-Cd OR Ni-MH CHARGER.
Failure to charge the battery with a compatible charger may cause fire resulting in personal injury and/or property damage
 - Never discharge Li-Po cells to below 3V under load.
 - Never cover warning labels with hook and loop strips.
 - Never leave charging batteries unattended.
 - Never charge batteries outside safe temperature range.
 - Never charge damaged batteries.

Low Voltage Cutoff (LVC)

When a Li-Po battery is discharged below 3V, it will not hold a charge. The Corsair ESC protects the flight battery from over-discharge using Low Voltage Cutoff (LVC). Before the battery charge decreases too much, LVC removes power supply from the motor. Power to the motor quickly decreases and increases, showing some battery power is reserved for flight control and safe landing.

When the motor power decreases then increases, please land the aircraft immediately and recharge the flight battery.

Disconnect and remove the Li-Po battery from the aircraft after use to prevent trickle discharge. Before storage, charge the Li-Po battery to full capacity. During storage make sure battery charge does not go below 3V.

NOTICE: Repeated flying to LVC will damage the battery.

Installing Transmitter Battery

Your F4U Corsair RTF transmitter comes pre-bound to the aircraft, so binding should not be necessary. All that is needed to begin flying is installation of fully charged batteries in the aircraft and transmitter.

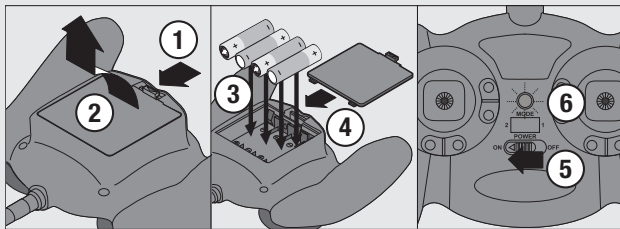

Transmitter and Receiver Binding

Binding is the process of programming the receiver of the control unit to recognize the GUID (Globally Unique Identifier) code of a single specific transmitter. You need to 'bind' your chosen Spektrum™ DSM® technology equipped aircraft transmitter to the receiver for proper operation.

Note: For a list of compatible DSM® transmitters, please visit www.bindnfly.com.

Note: When using a Futaba transmitter with a Spektrum DSM module, you will need to reverse the throttle channel.

✓ Binding Procedure Reference Table

1. Refer to your transmitter's unique instructions for binding to a receiver.	
2. Make sure the flight battery is disconnected from the airplane.	
3. Power off the transmitter.	
4. Connect the flight battery in the aircraft. The receiver LED will begin to flash (typically after 5 seconds).	
5. Put your transmitter into bind mode. If using the transmitter that is supplied with the RTF version, push the left control stick vertically into the case until it clicks, while powering on the transmitter.	
6. Make sure transmitter controls are neutral and throttle is in low position.	
7. After 5 to 10 seconds, the receiver status LED will become solid, indicating that the receiver is bound to the transmitter. Note: If the LED does not go to a solid light, refer to Troubleshooting Guide at back of manual.	

Before Flight

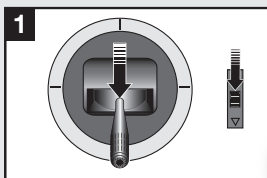

1
Lower throttle and throttle trim to lowest settings.

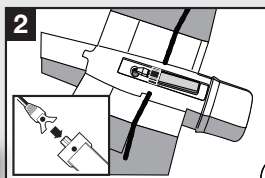

2
Connect flight battery and attach to hook and loop strip.

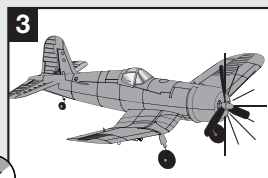

3
Wait 5 Seconds

Continuous LED

⚠ CAUTION: Always keep hands away from propeller. When armed, the motor will turn the propeller in response to any throttle movement.

Transmitter Control

Mode 2

Throttle/Rudder		Elevator/Aileron
Rudder Trim		Aileron Trim
Throttle Trim		Elevator Trim

Mode 1

Elevator/Rudder		Throttle/Aileron
Rudder Trim		Aileron Trim
Elevator Trim		Throttle Trim

Digital Trims

The ParkZone® 4-channel 2.4GHz DSM transmitter features digital trim buttons on all controls to make fine adjustments. The digital trims are used to fine-tune the model's flight path when in flight.

Note: Before the first flight, center the control surfaces mechanically (see Control Centering).

Note: When pressed down, trim buttons make a sound that increases or decreases in pitch at each pressing. The middle or neutral trim position is heard as a middle tone in the pitch range of the sounds. The end of the control range is sounded by a series of beeps.

Dual Rate Function

This transmitter's dual rate feature lets the pilot change between high and low control rates for the aileron, elevator, rudder.

- When powered on, this transmitter is automatically in high-rate mode.
- Change rate modes by pushing the right-hand control stick vertically into the case until it clicks while the transmitter is powered on.
- High-rate mode is shown by the transmitter's LED glowing solid red. In high-rate mode the controls can reach their maximum values. This mode is typically preferred by experienced pilots for maximum control authority.
- Low-rate mode is shown by the transmitter's LED blinking continuously. In low-rate mode the controls are reduced to approximately 70% of their maximum values. This mode is typically preferred by (and best for) first-time, low-time and other pilots interested in smoother and more easily controlled flight.

Control Direction Test

Bind your aircraft and transmitter before doing these tests. Move the controls on the transmitter to make sure aircraft control surfaces move correctly (Mode 2 shown).

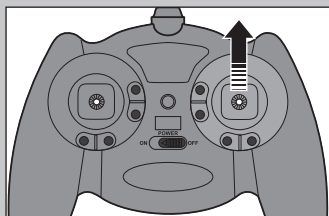

Down Elevator

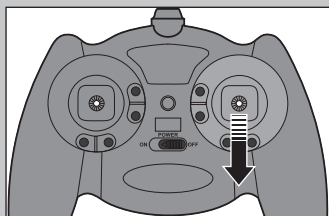
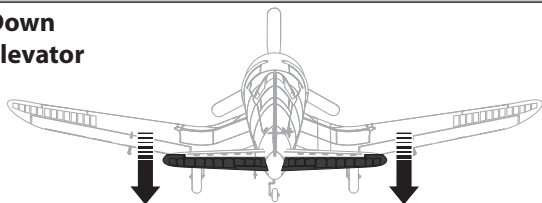

Up Elevator

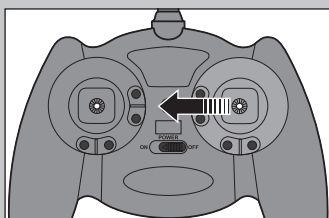
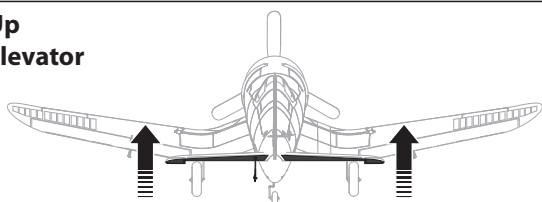

Left Aileron

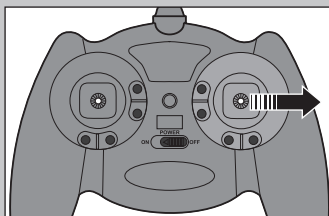
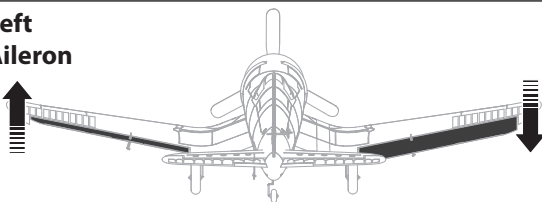

Right Aileron

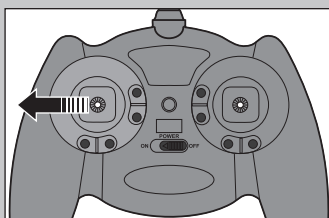
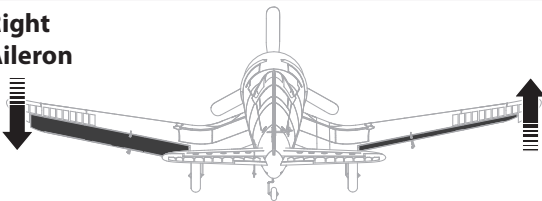

Left Rudder

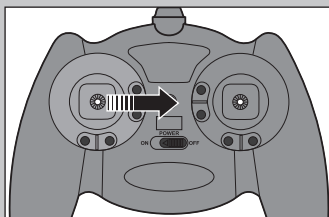
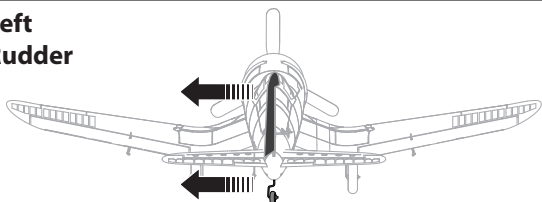

Right Rudder

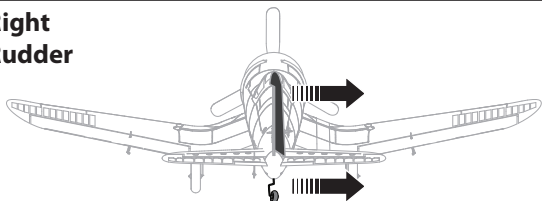

Reverse Controls

NOTICE: The Corsair RTF should not require any servo reversing. Should the F4U Corsair's electronic components be used in another aircraft, you may find it necessary to reverse the operation of the flight control surfaces.

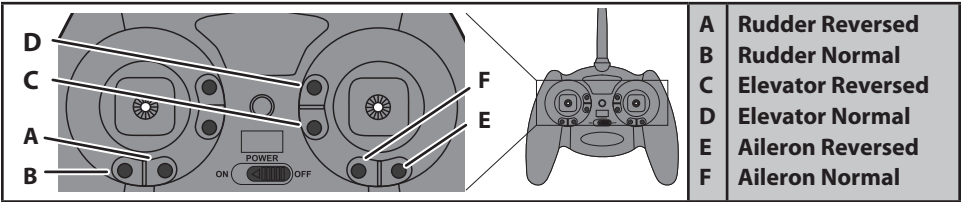

The transmitter included with the F4U Corsair is the same transmitter included in other Ultra Micro RTF models. It also functions identically to the transmitter included with the E-flite mCX and mSR.

1. Be certain the battery is unplugged from the aircraft and the transmitter is turned off.
2. Press and hold the digital trim button for the surface you would like to reverse.
3. While holding the digital trim button, turn the transmitter on.

4. Hold the digital trim buttons down for approximately 5 seconds until you hear a tone, confirming the selection.
5. Connect the flight battery and complete the flight control test. Confirm all surfaces operate in the correct direction.

Control Centering

Before first flights, or in the event of an accident, make sure the flight control surfaces are centered. Adjust linkages mechanically if control surfaces are not centered.

Use of the transmitter trims may not correctly center the aircraft control surfaces due to the mechanical limits of linear servos.

1. Make sure control surfaces are neutral when the transmitter controls and trims are centered. Where possible, transmitter sub-trim must be set to zero.

2. When needed, use a pair of pliers to carefully bend the metal of the linkage (see illustration).
3. Make the U-shape narrower to make the connector shorter. Make the U-shape wider to make the linkage longer.

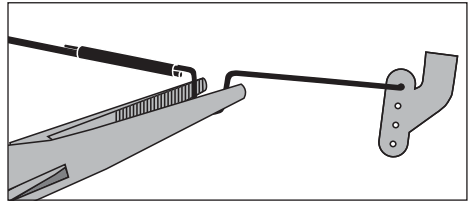

Note: If using any other transmitter that has programmable features, do not use Sub-Trim to adjust the center position of the servo, and **never set Travel Adjust values above 100%**. Ultra Micro servos are unique in that they are calibrated to reach maximum travel at 100%. Increasing the value above 100% will NOT result in more travel, but can cause the servo to lock and will result in poor flight characteristics or a crash.

Note: There are two aileron servos located on the underside of the wings.

Control Rates

We recommend using a DSM aircraft transmitter capable of dual rates. Adjust according to individual preferences after initial flight.

It is normal for linear servos to make noise. The noise is not an indication of a faulty servo.

To achieve the proper Low Rate settings when using a programmable DSM aircraft transmitter, set the low rate value to 70% for aileron, elevator and rudder.

	High Rate	Low Rate
Aileron	6mm up/down	4mm up/down
Elevator	4mm up/down	3mm up/down
Rudder	7mm up/down	5mm up/down

Note: All control surfaces are measured at the widest point.

Settings for Control Horns

The illustration shows factory settings for linkages on control horns. After flying, if you want more or less control throw, carefully adjust linkage positions for desired control response. (Picture not to scale.)

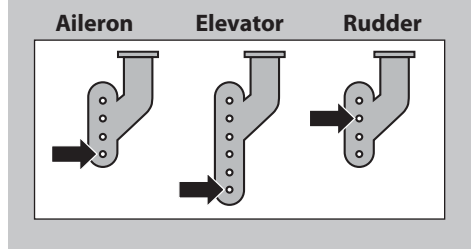

Installing Flight Battery

1. Connect fully charged flight battery to the aircraft, noting proper polarity.

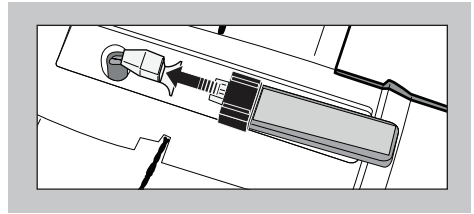

2. Attach flight battery to a strip of loop fastener on the bottom of the fuselage.

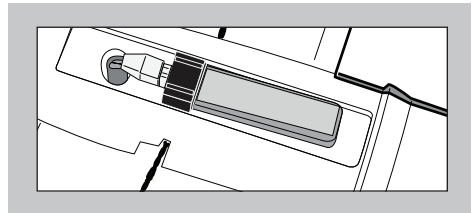

Adjusting Center of Gravity (CG)

The CG location is **28mm** back from leading edge of the wing at the root. This CG location has been determined with the included 1S 150mAh 3.7V Li-Po battery installed in the front of the battery cavity.

Note: The battery cavity is oversized to allow for Center of Gravity adjustment. Start by placing the battery in the front of the cavity and adjust as necessary.

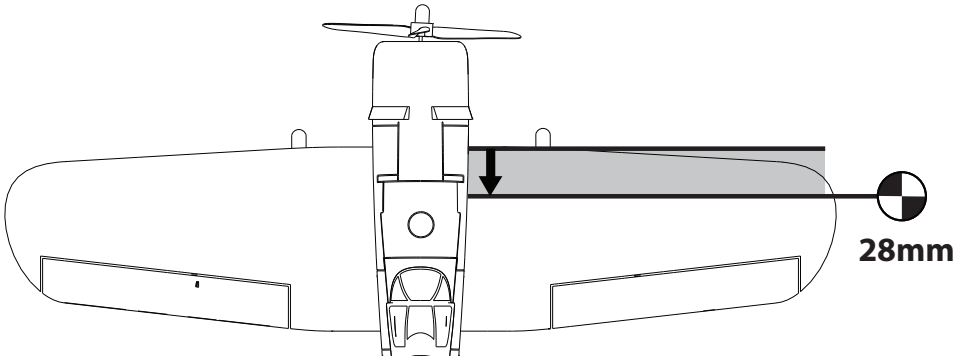

Removing and Installing Landing Gear

To Remove:

1. Lift the end of the landing gear wire above the stop.

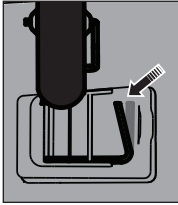

2. Gently pull the landing gear toward the center of the wing and away from the clips.

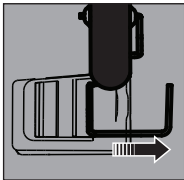

To Install:

1. Gently slide the landing gear into the plastic clips on the bottom of the wing.

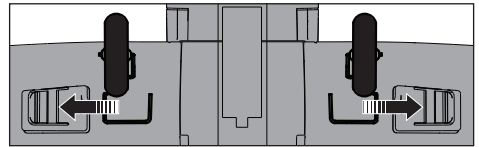

2. The landing gear is installed when the end of the landing gear wire is inside the stop.

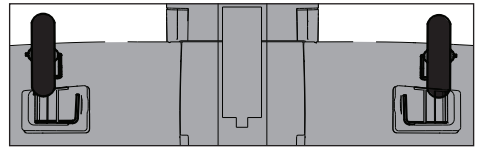

Note: Install left and right gear with the vertical strut of the landing gear toward the front of the wing. Install the bent wire of each strut fully inside each mount.

Propeller and Propeller Shaft Maintenance

⚠ CAUTION: DO NOT handle propeller parts while the flight battery is connected. Personal injury could result.

Removing and Installing the Propeller

1. Hold the shaft using needle-nose pliers or hemostats.

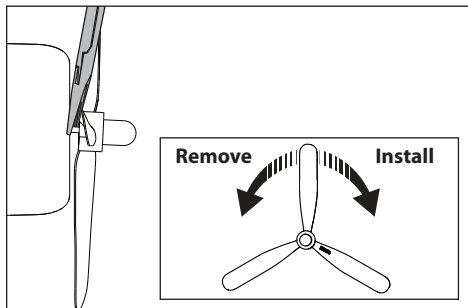

2. Turn propeller counterclockwise (looking from front of model) to remove. (Turn the propeller clockwise to install.)

Note: You may also choose to use a 130mm x 70mm 2-blade propeller (EFL9051) for a bit more performance from your model.

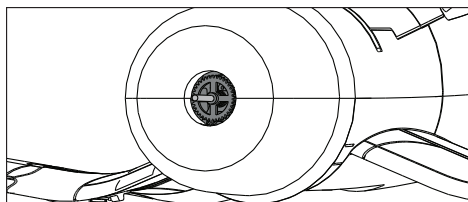

3. Carefully remove glued spinner from propeller. You may need to cut glue from the propeller. (To reinstall the spinner use a drop of CA or Foam-Compatible CA.)

Remove Propeller Shaft

1. Cut open the fuselage at the decal on one side of the fuselage and on the turtle deck (top of fuselage in front of canopy).

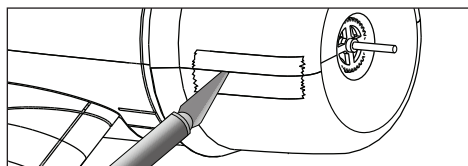

Note: Removing tape or decals will remove paint from the fuselage.

2. While the fuselage is open, hold the white nylon nut on the prop shaft using needle-nose pliers or hemostats.

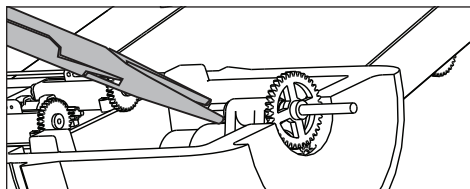

3. Turn the spur gear on the prop shaft clockwise (looking from front of model) to remove the nut.
4. Gently pull the shaft from the gearbox. Make sure washer and 2 bushings are not lost when shaft is removed from gearbox.

Installing Propeller Shaft

1. Push the prop shaft into the gearbox.
2. Hold the nylon nut on the back of the prop shaft.
3. Turn the spur gear counterclockwise (looking from front of model) until the nut is fully installed. Please ensure the prop shaft turns freely before moving on.
4. Assemble the fuselage with clear tape.

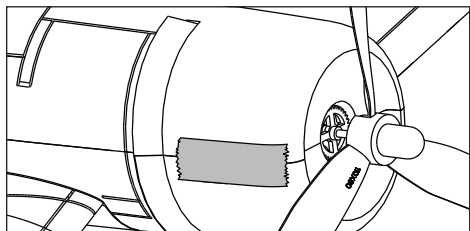

Note: Numbers on the propeller must face out for correct propeller operation.

Flying Tips and Repairs

Flying

We recommend only flying your F4U Corsair in light winds. Always avoid flying near houses, trees, wires and buildings. You should also be careful to avoid flying in areas where there are many people, such as busy parks, schoolyards, or soccer fields. Consult local laws and ordinances before choosing a location to fly your aircraft.

Place the F4U Corsair in position for takeoff (facing into the wind if flying outdoors). Gradually increase the throttle to $\frac{3}{4}$ to full, and steer with the rudder. Pull back gently with the elevator and climb to check trim. Once the trim is adjusted, begin exploring the flight envelope of the F4U Corsair.

Note: Due to the large propeller on the F4U Corsair, it is possible to hit the prop on the ground while landing. Make sure to flare when landing and try to land as smoothly as possible to minimize hitting the prop. While this does not damage the airplane it is

possible to wear down the tips of the propeller if flying from an abrasive surface such as concrete or asphalt.

Failure to lower the throttle stick and trim to the lowest possible positions during a crash could result in damage to the ESC in the receiver unit, which may require replacement.

Note: Crash damage is not covered under warranty.

Repairs

Repair the Corsair using foam-compatible CA glue or clear tape. Only use foam-compatible CA glue, as other types of glue can damage the foam. When parts are not repairable, see the Replacement Parts List for ordering by item number.

Note: For a listing of all replacement and optional parts, refer to the list at the back of this manual.

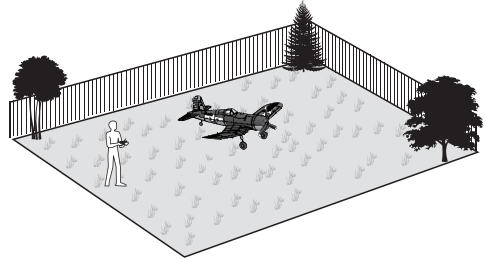

Additional Safety Precautions and Warnings

As the user of this product, you are solely responsible for operating in a manner that does not endanger yourself and others or result in damage to the product or the property of others.

This model is controlled by a radio signal subject to interference from many sources outside your control. This interference can cause momentary loss of control so it is advisable to always keep a safe distance in all directions around your model, as this margin will help avoid collisions or injury.

- Always keep a safe distance in all directions around your model to avoid collisions or injury. This model is controlled by a radio signal subject to interference from many sources outside your control. Interference can cause momentary loss of control
- Always operate your model in open spaces away from full-size vehicles, traffic and people.
- Always carefully follow the directions and warnings for this and any optional support equipment (chargers, rechargeable battery packs, etc.).
- Always keep all chemicals, small parts and anything electrical out of the reach of children.
- Always avoid water exposure to all equipment not specifically designed and protected for this purpose. Moisture causes damage to electronics.
- Never place any portion of the model in your mouth as it could cause serious injury or even death.
- Never operate your model with low transmitter batteries.

Maintenance After Flying

- Disconnect flight battery from Receiver/ ESC (Required for Safety)
- Power off transmitter
- Remove flight battery from aircraft
- Recharge flight battery
- Repair or replace all damaged parts
- Store flight battery apart from aircraft and monitor the battery charge
- Make note of flight conditions and flight plan results, planning for future flights

Troubleshooting Guide

Problem	Possible Cause	Solution
Aircraft will not respond to throttle but responds to other controls	Throttle stick and/or throttle trim too high	Reset controls with throttle stick and throttle trim at lowest setting
	Throttle channel is reversed	Reverse throttle channel on transmitter
	Motor unplugged from receiver	Open fuselage and ensure the plug for the motor is properly installed
Extra propeller noise or extra vibration	Damaged propeller, spinner, prop shaft or motor	Replace damaged parts
	Nut on prop shaft is too loose	Tighten the prop shaft nut 1/2 turn
Reduced flight time or aircraft underpowered	Flight battery charge is low	Completely recharge flight battery
	Propeller installed backwards	Install propeller with numbers facing forward
	Flight battery damaged	Replace flight battery and follow flight battery instructions
	Flight conditions may be too cold	Make sure battery is warm before use
	Battery capacity too low for flight conditions	Replace battery or use a larger capacity battery

Problem	Possible Cause	Solution
LED on receiver flashes and aircraft will not bind to transmitter (during binding)	Transmitter too near aircraft during binding process	Power off transmitter, move transmitter a larger distance from aircraft, disconnect and reconnect flight battery to aircraft and follow binding instructions
	Bind switch or button not held long enough during bind process	Power off transmitter and repeat bind process. Hold transmitter bind button or switch until receiver is bound
LED on receiver flashes rapidly and aircraft will not respond to transmitter (after binding)	Less than a 5-second wait between first powering on transmitter and connecting flight battery to aircraft	Leaving transmitter on, disconnect and reconnect flight battery to aircraft
	Aircraft bound to different model memory (ModelMatch™ radios only)	Select correct model memory on transmitter and disconnect and reconnect flight battery to aircraft
	Flight battery/transmitter battery charge is too low	Replace/recharge batteries
Control surface does not move	Control surface, control horn, linkage or servo damage	Replace or repair damaged parts and adjust controls
	Wire damaged or connections loose	Do a check of wires and connections, connect or replace as needed
	Flight battery charge is low	Fully recharge flight battery
	Control linkage does not move freely	Make sure control linkage moves freely
Controls reversed	Transmitter settings reversed	Do the Control Direction Test and adjust controls on transmitter appropriately
Motor loses power	Damage to motor, propeller shaft or power components	Do a check of motor, prop shaft and power components for damage (replace as needed)
	Nut on prop shaft is too tight	Loosen prop shaft nut until propeller shaft turns freely
Motor power quickly decreases and increases then motor loses power	Battery power is down to the point of receiver/ ESC Low Voltage Cutoff (LVC)	Recharge flight battery or replace battery that is no longer performing
Servo locks or freezes at full travel	Travel adjust value is set above 100% overdriving the servo	Set Travel adjust to 100% or less

Warranty and Repair Policy

Warranty Period

Exclusive Warranty- Horizon Hobby, Inc., (Horizon) warranties that the Products purchased (the "Product") will be free from defects in materials and workmanship at the date of purchase by the Purchaser.

Limited Warranty

Horizon reserves the right to change or modify this warranty without notice and disclaims all other warranties, express or implied.

- (a) This warranty is limited to the original Purchaser ("Purchaser") and is not transferable. REPAIR OR REPLACEMENT AS PROVIDED UNDER THIS WARRANTY IS THE EXCLUSIVE REMEDY OF THE PURCHASER. This warranty covers only those Products purchased from an authorized Horizon dealer. Third party transactions are not covered by this warranty. Proof of purchase is required for all warranty claims.
- (b) Limitations- HORIZON MAKES NO WARRANTY OR REPRESENTATION, EXPRESS OR IMPLIED, ABOUT NON-INFRINGEMENT, MERCHANTABILITY OR FITNESS FOR A PARTICULAR PURPOSE OF THE PRODUCT. THE PURCHASER ACKNOWLEDGES THAT THEY ALONE HAVE DETERMINED THAT THE PRODUCT WILL SUITABLY MEET THE REQUIREMENTS OF THE PURCHASER'S INTENDED USE.
- (c) Purchaser Remedy- Horizon's sole obligation hereunder shall be that Horizon will, at its option, (i) repair or (ii) replace, any Product determined by Horizon to be defective. In the event of a defect, these are the Purchaser's exclusive remedies. Horizon reserves the right to inspect any and all equipment involved in a warranty claim. Repair or replacement decisions are at the sole discretion of Horizon. This warranty does not cover cosmetic damage or damage due to acts of God, accident, misuse, abuse, negligence, commercial use, or modification of or to any part of the Product.

This warranty does not cover damage due to improper installation, operation, maintenance, or attempted repair by anyone other than Horizon. Return of any Product by Purchaser must be approved in writing by Horizon before shipment.

Damage Limits

HORIZON SHALL NOT BE LIABLE FOR SPECIAL, INDIRECT OR CONSEQUENTIAL DAMAGES, LOSS OF PROFITS OR PRODUCTION OR COMMERCIAL LOSS IN ANY WAY CONNECTED WITH THE PRODUCT, WHETHER SUCH CLAIM IS BASED IN CONTRACT, WARRANTY, NEGLIGENCE, OR STRICT LIABILITY. Further, in no event shall the liability of Horizon exceed the individual price of the Product on which liability is asserted. As Horizon has no control over use, setup, final assembly, modification or misuse, no liability shall be assumed nor accepted for any resulting damage or injury. By the act of use, setup or assembly, the user accepts all resulting liability.

If you as the Purchaser or user are not prepared to accept the liability associated with the use of this Product, you are advised to return this Product immediately in new and unused condition to the place of purchase.

Law: These Terms are governed by Illinois law (without regard to conflict of law principals).

Warranty Services

Questions, Assistance, and Repairs

Your local hobby store and/or place of purchase cannot provide warranty support or repair. Once assembly, setup or use of the Product has been started, you must contact Horizon directly. This will enable Horizon to better answer your questions and service you in the event that you may need any assistance. For questions or assistance, please direct your email to product-support@horizonhobby.com, or call 877.504.0233 toll free to speak to a Product Support representative. You may also find information on our website at www.horizonhobby.com.

Inspection or Repairs

If this Product needs to be inspected or repaired, please use the Horizon Online Repair Request submission process found on our website or call Horizon to obtain a Return Merchandise Authorization (RMA) number. Pack the Product securely using a shipping carton. Please note that original boxes may be included, but are not designed to withstand the rigors of shipping without additional protection. Ship via a carrier that provides tracking and insurance for lost or damaged parcels, as Horizon is not responsible for merchandise until it arrives and is accepted at our facility. An Online Repair Request is available at www.horizonhobby.com under the Repairs tab. If you do not have internet access, please contact Horizon Product Support to obtain a RMA number along with instructions for submitting your product for repair. When calling Horizon, you will be asked to provide your complete name, street address, email address and phone number where you can be reached during business hours. When sending product into Horizon, please include your RMA number, a list of the included items, and a brief summary of the problem. A copy of your original sales receipt must be included for warranty consideration. Be sure your name, address, and RMA number are clearly written on the outside of the shipping carton.

Notice: Do not ship batteries to Horizon. If you have any issue with a battery, please contact the appropriate Horizon Product Support office.

Warranty Inspection and Repairs

To receive warranty service, you must include your original sales receipt verifying the proof-of-purchase date. Provided warranty conditions have been met, your Product will be repaired or replaced free of charge. Repair or replacement decisions are at the sole discretion of Horizon Hobby.

Non-Warranty Repairs

Should your repair not be covered by warranty the repair will be completed and payment will be required without notification or estimate of the expense unless the expense exceeds 50% of the retail purchase cost. By submitting the item for repair you are agreeing to payment of the repair without notification. Repair estimates are available upon request. You must include this request with your repair. Non-warranty repair estimates will be billed a minimum of 1/2 hour of labor. In addition you will be billed for return freight. Horizon accepts money orders and cashiers checks, as well as Visa, MasterCard, American Express, and Discover cards. By submitting any item to Horizon for inspection or repair, you are agreeing to Horizon's Terms and Conditions found on our website under the Repairs tab.

Warranty and Service Information

Country of Purchase	Horizon Hobby	Address	Phone Number/Email Address
United States of America	Horizon Service Center (Electronics and engines)	4105 Fieldstone Rd Champaign, Illinois 61822 USA	877-504-0233 Online Repair Request visit: www.horizonhobby.com/repairs
	Horizon Product Support (All other products)	4105 Fieldstone Rd Champaign, Illinois 61822 USA	877-504-0233 productsupport@horizonhobby.com
United Kingdom	Horizon Hobby Limited	Units 1-4 Ployters Rd Staple Tye Harlow, Essex CM18 7NS United Kingdom	+44 (0) 1279 641 097 sales@horizonhobby.co.uk
Germany	Horizon Technischer Service	Hamburger Str. 10 25335 Elmshorn, Germany	+49 4121 46199 66 service@horizonhobby.de
France	Horizon Hobby SAS	14 Rue Gustave Eiffel Zone d'Activité du Réveil Matin 91230 Montgeron	+33 (0) 1 60 47 44 70 infofrance@horizonhobby.com

FCC Information

This device complies with part 15 of the FCC rules. Operation is subject to the following two conditions: (1) This device may not cause harmful interference, and (2) this device must accept any interference received, including interference that may cause undesired operation.

CAUTION: Changes or modifications not expressly approved by the party responsible for compliance could void the user's authority to operate the equipment.

This product contains a radio transmitter with wireless technology which has been tested and found to be compliant with the applicable regulations governing a radio transmitter in the 2.400GHz to 2.4835GHz frequency range.

Compliance Information for the European Union

Declaration of Conformity

(in accordance with ISO/IEC 17050-1)
No. HH2011022802

Product(s): PKZ Ultra Micro F4U Corsair RTF
Item Number(s): PKZ1600
Equipment class: 1

The object of declaration described above is in conformity with the requirements of the specifications listed below, following the provisions of the European R&TTE directive 1999/5/EC and EMC Directive 2004/108/EC

EN 300-328 V1.7.1
EN 301 489-1 V1.7.1: 2006
EN 301 489-17 V1.3.2: 2008
EN 60950-1:2006+A11

EN55022: 2006,
EN55024: 1998+A1: 2001+A2: 2003
(EN61000-4-2: 2001, EN61000-4-3: 2006, EN61000-4-8: 2001)



Signed for and on behalf of:
Horizon Hobby, Inc.
Champaign, IL USA
Feb. 28, 2011

Steven A. Hall
Vice President
International Operations and Risk Management
Horizon Hobby, Inc.

Declaration of Conformity

(in accordance with ISO/IEC 17050-1)

No. HH2011022801

Product(s): PKZ Ultra-Micro F4U Corsair BNF
Item Number(s): PKZ1680
Equipment class: 1

The object of declaration described above is in conformity with the requirements of the specifications listed below, following the provisions of the European R&TTE directive 1999/5/EC and EMC Directive 2004/108/EC

EN 301 489-1 V1.7.1: 2006

EN 301 489-17 V1.3.2: 2008

EN55022: 2006,

EN55024: 1998+A1: 2001+A2: 2003

(EN61000-4-2: 2001, EN61000-4-3: 2006, EN61000-4-8: 2001)



Signed for and on behalf of:
Horizon Hobby, Inc.
Champaign, IL USA
Feb. 28, 2011

A handwritten signature in black ink, appearing to read 'S A Hall'.

Steven A. Hall
Vice President
International Operations and Risk Management
Horizon Hobby, Inc.

Instructions for disposal of WEEE by users in the European Union



This product must not be disposed of with other waste. Instead, it is the user's responsibility to dispose of their waste equipment by handing it over to a designated collections point for the recycling of waste electrical and electronic equipment. The separate collection and recycling of your waste equipment at the time of disposal will help to conserve natural resources and ensure that it is recycled in a manner that protects human health and the environment. For more information about where you can drop off your waste equipment for recycling, please contact your local city office, your household waste disposal service or where you purchased the product.

Replacement Parts • Ersatzteile • Pièces de rechange • Pezzi di ricambio

Part # Nummer Numéro Codice	Description	Beschreibung	Description	Descrizione
PKZU1602	Decal Sheet: UM F4U Corsair	Dekorbogen: UM F4U Corsair	Planche de décal- comanies : UM F4U Corsair	Foglio con decalcomanie: UM F4U Corsair
PKZU1603	Landing Gear Set: UM F4U Corsair	Fahrgestellsatz: UM F4U Corsair	Jeu de train d'atterrissage : UM F4U Corsair	Set carrello di atterraggio: UM F4U Corsair
PKZU1604	Clear Canopy: UM F4U Corsair	Durchsichtige Kabinenhaube: UM F4U Corsair	Verrière transpar- ente : UM F4U Corsair	Capottina trasparente: UM F4U Corsair
PKZU1608	Spinner: UM F4U Corsair (4)	Spinner: UM F4U Corsair (4)	Cône d'hélice : UM F4U Corsair (4)	Ogiva: UM F4U Corsair (4)
PKZU1620	Wing/Belly Pan Without Servo: UM F4U Corsair	Flügel / untere Verk- leidung ohne Servo: UM F4U Corsair	Aile/blindage inféri- eur sans servo : UM F4U Corsair	Carenatura ala/ inferiore, senza servo: UM F4U Corsair
PKZU1622	Aileron Pushrod Linkage: UM F4U Corsair	Querrudergestänge: UM F4U Corsair	Liaison de com- mande d'aileron : UM F4U Corsair	Leveraggio asta di comando dell'alettone: UM F4U Corsair
PKZU1625	Complete Tail Set: UM F4U Corsair	Vollständiger Heck- satz: UM F4U Corsair	Queue complète : UM F4U Corsair	Set completo coda: UM F4U Corsair
PKZU1626	Elevator/Rudder Pushrod Set: UM F4U Corsair	Höhen-/Seitenrud- ergestängesatz: UM F4U Corsair	Jeu de biellettes mécaniques de gouverne de profon- deur et de direction : UM F4U Corsair	Set asta di comando elevator/timone: UM F4U Corsair
PKZU1667	Bare Fuselage with Canopy: UM F4U Corsair	Blank Rumpf mit Kabinenhaube: UM F4U Corsair	Fuselage nu avec verrière : UM F4U Corsair	Fusoliera semplice con capottina: UM F4U Corsair
HBZ4929	Gearbox (No Motor): Champ, UM T28, Corsair	Getriebe (ohne Mo- tor): Champ, UM T28, Corsair	Réducteur (sans moteur) : Champ, UM T28, Corsair	Riduttore (senza motore): Champ, UM T28, Corsair
PKZ3528	Propeller Shaft: Sukhoi Su-26m, Micro P-51	Propellerwelle: Sukhoi Su-26m, Micro P-51	Arbre d'hélice : Sukhoi Su-26m, Micro P-51	Albero dell'elica: Sukhoi Su-26m, Micro P-51
PKZ3616	Motor: Ultra Micro P-51, UM T-28	Motor: Ultra Micro P-51, UM T-28	Moteur : Ultra Micro P-51, UM T-28	Motore Ultra Micro P-51, UM T-28
EFLC1003	DC 3.7V Li-Po Charger	DC-3,7V-Li-Po- Ladegerät	Chargeur Li-Po DC 3,7 V	Caricabatterie Li-Po CC da 3,7 V
PKZ3341	2.4GHz Transmitter DSM2: Vapor	2,4GHz-DSM2- Sender: Vapor	Émetteur DSM2 2,4 GHz: Vapor	Trasmettitore DSM2 da 2,4 GHz: Vapor
EFLUP11803B	110 x 80mm 3 Blade Propeller	110 x 80 mm- 3-Blattpropeller	Hélice 3 pales 110 x 80 mm	Elica 110 x 80 mm a 3 lame
EFLB1501S	1S 3.7V 150mAh Li-Po Battery	1S-3,7V-150mAh-Li- Po-Akku	Batterie Li-Po 150 mAh 3,7 V 1S	Batteria Li-Po 1S da 3,7 V, 150 mAh
EFLH1067	Replacement Servo Retaining Collars	Ersatzsicherung für Servo	Bagues de maintien de servo de rechange	Collarini di fissaggio del servo di ricambio
EFLH1066	Replacement Servo Mechanics: MCX/2/ MSR/FHX/MH-35	Ersatz-Servomechan- ik: MCX/2/MSR/FHX/ MH-35	Pièces de rechange mécaniques servo : MCX/2/MSR/FHX/ MH-35	Componenti meccanici di ricambio del servo: MCX/2/MSR/FHX/ MH-35

Optional Parts and Accessories • Optionale Bauteile und Zubehör • Pièces et accessoires optionnels • Componenti e accessori opzionali

Part # Nummer Numéro Codice	Description	Beschreibung	Description	Descrizione
EFL9054	Prop Shaft with Gear (2): UMX 4Site	Propellerwelle mit Zahnrad (2): UMX 4Site	Arbre d'hélice avec réducteur (2) : UMX 4Site	Albero dell'elica con riduttore (2): UMX 4Site
SPMAR6400	AR6400 DSM2 6-Channel Ultra Micro Receiver/ESC	AR6400-DSM2-6-Kanal Ultra-Mikro-Empfänger/ESC	Récepteur/ESC DSM2 AR6400 6 voies Ultra-Micro	Ricevitore/ESC AR6400 a 6 canali Ultra-Micro DSM2
SPMAS2000L	1.7-Gram Linear Long Throw Servo	1,7g-Linearservo mit großem Ausschlag	Servo linéaire course longue 1,7 g	Servo lineare a corsa lunga da 1,7 grammi
SPM6832	Replacement Servo Mechanics: Ultra Micro Long Throw	Ersatz-Servomechanik: Ultra Micro mit großem Ausschlag	Pièces de rechange mécaniques servo : Ultra Micro course longue	Componenti meccanici di ricambio del servo: corsa lunga Ultra Micro
EFL9051	Prop and Spinner 130x70 (2): UM 4-Site/Champ	Propeller und Spinner 130x70 (2): UM 4-Site/Champ	Hélice et cône d'hélice 130 x 70 (2) : UM 4-Site/Champ	Elica e ogiva 130 x 70 (2): UM 4-Site/Champ
EFLC1004	Celectra 4-Port 1S 3.7V 0.3A DC Li-Po Charger	Celectra-1S-3,7V-0,3A-DC-Li-Po-Ladegerät mit 4 Anschlüssen	Chargeur Li-Po CC 0,3 A 3, 7 V 1S 4 ports Celectra	Caricabatterie Li-Po 1S da 3,7 V 0,3 A CC, a 4 porte, Celectra
EFLC1005	AC to 6VDC 1.5 Amp Power Supply	Netzteil 6V 1,5 A	Alimentation CA vers 6 V CC, 1,5 A	Alimentatore CA - 6 V CC da 1,5 A
EFLC1005AU	AC to 6VDC 1.5 Amp Power Supply, AU	Netzteil 6V 1,5 A Australien	Alimentation CA vers 6 V CC, 1,5 A AU	CA - 6 V CC, 1,5 A Alimentatore, AU
EFLC1005EU	AC to 6VDC 1.5 Amp Power Supply, Int'l	Netzteil 6V 1,5 A EU	Alimentation CA vers 6 V CC, 1,5 A International	CA - 6 V CC, 1,5 A Alimentatore, Int'l
EFLC1005UK	AC to 6VDC 1.5 Amp Power Supply, United Kingdom	Netzteil 6V 1,5 A Großbritannien	Alimentation CA vers 6 V CC, 1,5 A Alimentation, Royaume-Uni	CA - 6 V CC, 1,5 A Alimentatore, Regno Unito
SPMR6610	DX6i Transmitter Only Mode 2	DX6i-Sender (nur Sender) Mode 2	Émetteur DX6i uniquement Mode 2	Solo trasmettitore DX6i Modalità 2
SPMR66101	DX6i Transmitter Only Mode 1	DX6i-Sender (nur Sender) Mode 1	Émetteur DX6i uniquement Mode 1	Solo trasmettitore DX6i Modalità 1
SPMR6610E	DX6i Transmitter Only Mode 2 Int'l	DX6i-Sender (nur Sender) Mode 2 international	Émetteur DX6i uniquement Mode 2 International	Solo trasmettitore DX6i Modalità 2 Int'l
SPMR66101E	DX6i Transmitter Only Mode 1 Int'l	DX6i-Sender (nur Sender) Mode 1 international	Émetteur DX6i uniquement Mode 1 International	Solo trasmettitore DX6i Modalità 1 Int'l
SPMR8800	DX8 Transmitter Only Mode 2	DX8-Sender (nur Sender) Mode 2	Émetteur DX8 uniquement Mode 2	Solo trasmettitore DX8 Modalità 2
SPMR8800EU	DX8 Transmitter Only Mode 2 Int'l	DX8-Sender (nur Sender) Mode 2 international	Émetteur DX8 uniquement Mode 2 International	Solo trasmettitore DX8 Modalità 2 Int'l
SPMR88001AU	DX8 Transmitter Only Mode 1 AU	DX8-Sender (nur Sender) Mode 1 Australien	Émetteur DX8 uniquement Mode 1 AU	Solo trasmettitore DX8 Modalità 1 AU
SPMR88001EU	DX8 Transmitter Only Mode 1 Int'l	DX8-Sender (nur Sender) Mode 1 international	Émetteur DX8 uniquement Mode 1 International	Solo trasmettitore DX8 Modalità 1 Int'l

Pappy Boyington

Option 1
Opzione 1

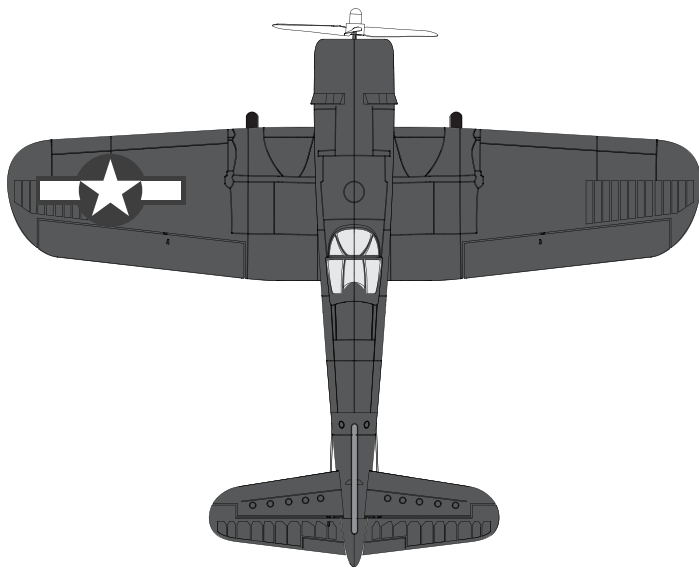
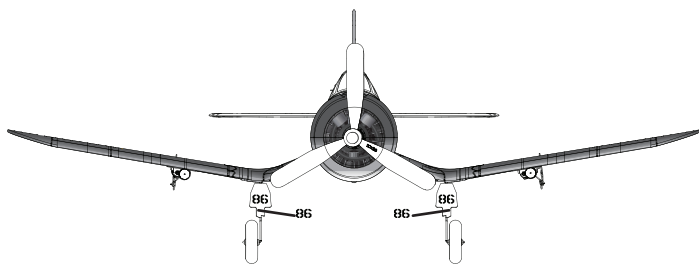
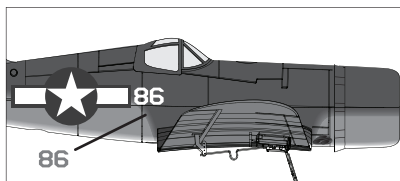
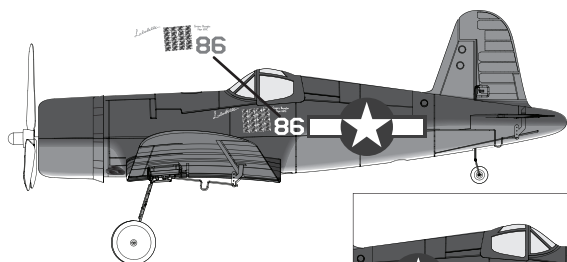

Ira Kepford

Option 2
Opzione 2

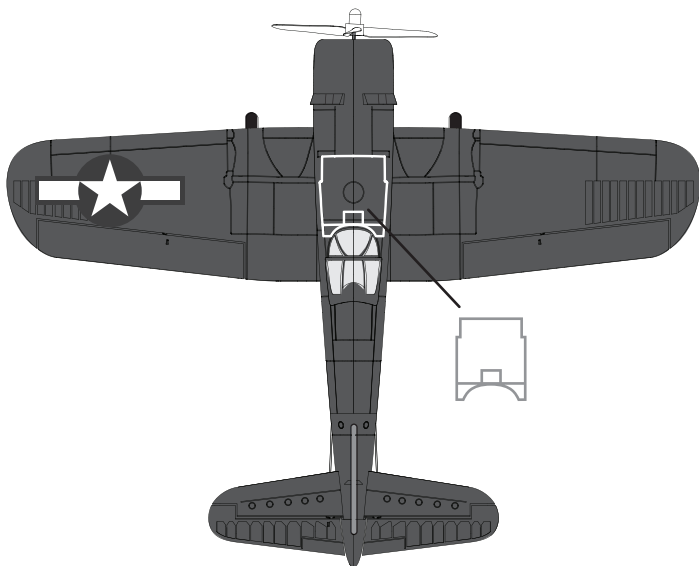
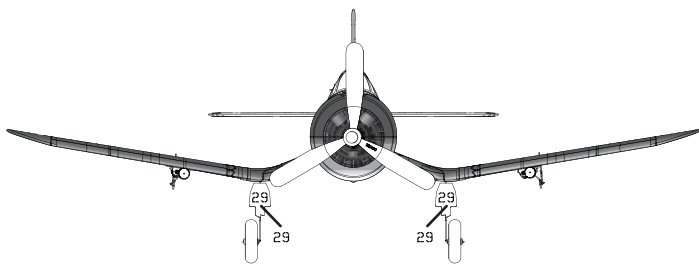
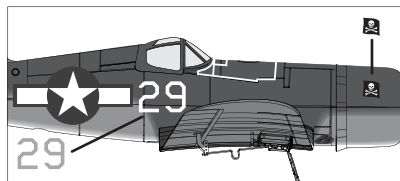
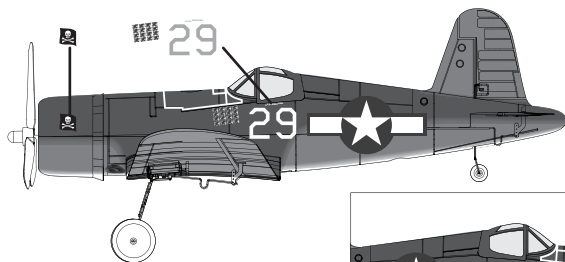

Parts Contact Information • Kontaktinformationen für Ersatzteile • Coordonnées (pièces) • Recapiti dei distributori

Country of Purchase	Horizon Hobby	Address	Phone Number/ Email Address
United States	Sales	4105 Fieldstone Rd Champaign, Illinois, 61822 USA	800-338-4639 sales@horizonhobby.com
United Kingdom	Horizon Hobby Limited	Units 1-4 Ployters Rd Staple Tye Harlow, Essex CM18 7NS, Regno Unito	+44 (0) 1279 641 097 sales@horizonhobby.co.uk
Germany	Horizon Hobby GmbH	Hamburger Str. 10 25335 Elmshorn, Germany	+49 4121 46199 60 service@horizonhobby.de
France	Horizon Hobby SAS	14 Rue Gustave Eiffel Zone d'Activité du Réveil Matin 91230 Montgeron	+33 (0) 1 60 47 44 70 infofrance@horizonhobby.com

© 2011 Horizon Hobby, Inc.

The Spektrum trademark is used with permission of Bachmann Industries, Inc.
ParkZone, E-flite, JR, Celectra, DSM, ModelMatch
are trademarks or registered trademarks of Horizon Hobby, Inc.
Futaba is a registered trademark of Futaba Denshi Kogyo Kabushiki Kaisha Corporation of Japan.

US D578,146. PRC ZL 200720069025.2. US 7,391,320 Other patents pending.

www.parkzone.com

Created 12/10 30602



parkzone.