

GETTING STARTED

NOTE: Before you start your 8IGHT RTR, read your engine break-in and operating instructions. If you run your 8IGHT RTR without following proper break-in procedure, you may damage or fail to get maximum performance from your engine, and void the warranty.

Radio Batteries



Install the 8 AA-size alkaline batteries in the transmitter making sure the positive(+) and negative (-) ends are oriented correctly. Use only quality alkaline or rechargeable Ni-Cad batteries.

Antenna Tube

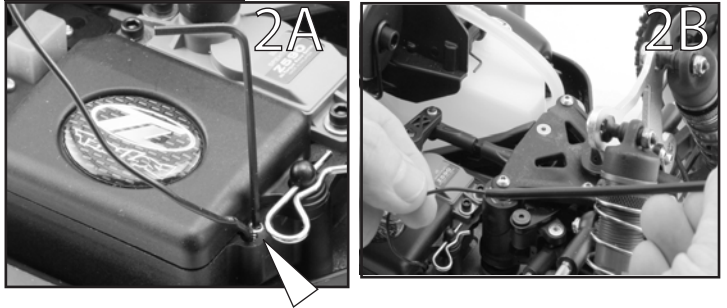

Locate the antenna tube in the plastic bag with the Operations guide. Remove the silver 5-40 setscrew from the radio tray with a 1/16" allen key (fig.2A). Thread the black antenna wire through the antenna tube (fig 2B). Push the antenna tube into the antenna mounting hole, then reinstall the 5-40 setscrew and attach the antenna cap.

5 cell Receiver Pack

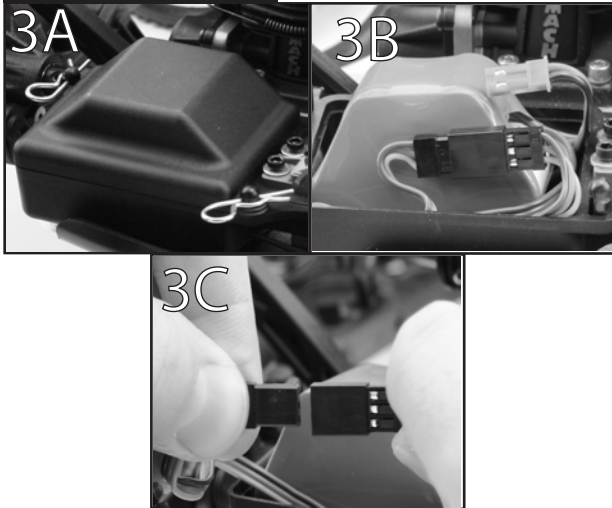

Note: Your 8IGHT RTR is equipped with a rechargeable receiver pack installed in your buggy. Follow the instructions to remove or replace the receiver pack.

To remove or charge the battery pack remove the two clips securing the receiver box cover (fig 3A & 3B). Unplug the black battery connector from the black switch connector, (fig 3C). Remove the battery from the receiver box.

Charging the Receiver Pack



Plug the AC charger into the proper wall receptacle (110V). Plug the red male connector from the battery pack into the red female connector from the charger. When the battery is charging the red indicator light will be on. Charge for 8 to 12 hours depending on the level of charge remaining. Never charge for more than 12 hours. **Never charge the battery with the black battery connector connected to the black switch connector. Damage to your radio system may result.**

Spin-Start Battery Installation



Slide the battery access panel opposite the hand strap back and remove the cover (fig. 5A). Remove hex starter shaft from the back side of the cover, (fig. 5B), and press the o-ringed end into the drive cup. Slide the 6 cell, 7.2 volt, "stick pack" (not supplied), into the Spin-Start and plug it in. Note that the plug is made such that it can only be plugged in one way. Carefully tuck the plug wires under the battery access panel and slide shut.

Operations Check

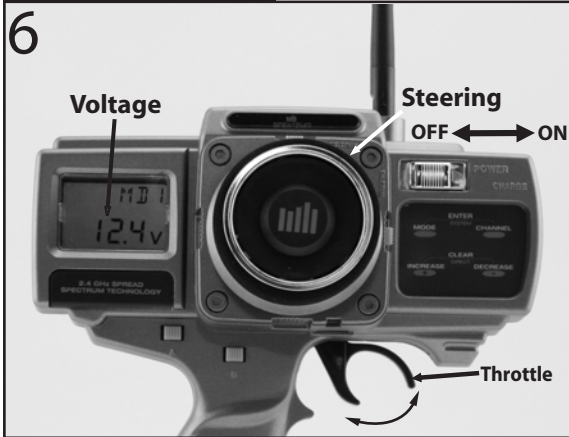

Turn on the transmitter and check for proper voltage, 10 - 12.4 volts (fig. 6). Slide the switch on the radio tray to the ON position (fig. 7). With the front tires off the ground turn the steering wheel on the transmitter left to right (fig. 8). The wheels should turn smoothly and with ease. Also operate the throttle and brake checking for smooth operation. Do not try to operate your 8IGHT RTR if any of the servos or any part of the radio is not operating correctly. If the servos operate slowly it is possible the batteries are low and must be recharged. Never try to operate your 8IGHT RTR if either the transmitter or receiver batteries are low.

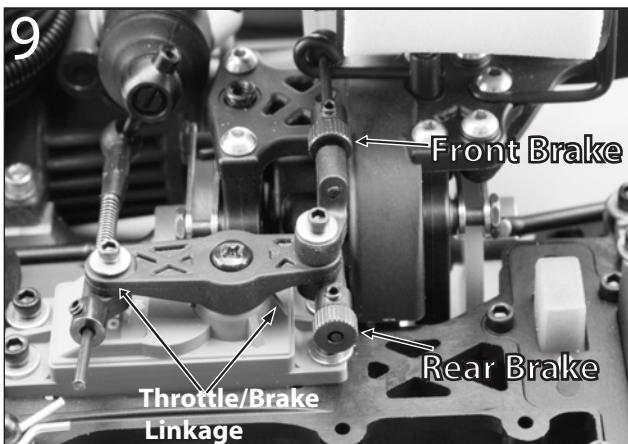
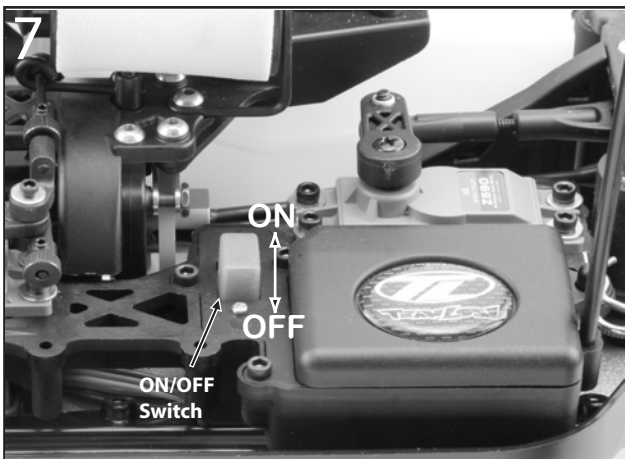

Your 8IGHT RTR is equipped with front and rear adjustable brakes (fig. 9). The upper blue knob adjusts the front brakes and the lower blue knob adjusts the rear brakes. To adjust the brakes turn the blue knob counter-clockwise for more brakes, clockwise for less brakes. These adjustments are for fine tuning and setting the brake bias. You will perform most of your brake adjustments from the transmitter. The collar with the set screw is used to adjust your throttle linkage.

Fueling

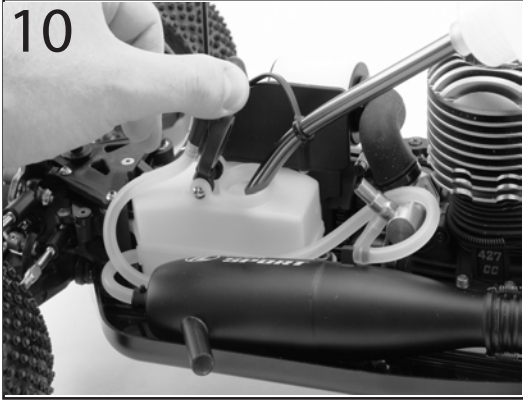

Fill your fuel bottle with fuel and lift the lid of the fuel tank and fill the tank (fig. 10). Make sure to put the lid back on both the fuel bottle and fuel jug.

Install Battery

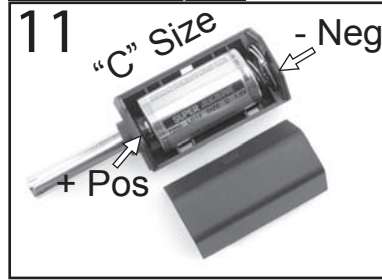

Remove the cover from the Glow plug igniter. Install a "C" size Alkaline battery with the "+" end of the battery as shown.

Priming your Engine



Insert the Spin-Start into the back plate of the engine. Cover the exhaust outlet with a rag. Press the Spin-Start button to turn the engine over for a few seconds. When you see the fuel reach the carburetor, release the Spin-Start button. Excessive priming will flood the engine and make it difficult to start.

Start your Engine



Attach the glow plug igniter to the glow plug. If you are using an aftermarket glow igniter with a meter make sure the needle is in the green or good condition. Holding the starter securely, press on the switch button and the engine should turn over and start.

If the engine does not turn over, it may be flooded or the battery in the starter needs to be charged. Use the 4-way wrench supplied to loosen the glow plug at least two turns and press the Spin-Start button again. Raw fuel should come out around the glow plug. Tighten the glow plug and resume the starting procedure.

Follow the engine break-in procedure, found in the Operations Guide, before attempting any racing or high performance operation. Use caution when adding fuel while the engine is running. Do not over fill or spill fuel outside the tank.

Stopping the Engine



When you are done running your 8IGHT RTR, use the handle of a screw driver or a rag to cover the exhaust pipe exit. Be EXTREMELY careful not to burn your hand as this will be hot. Also, make sure turn the receiver switch off, then turn the transmitter switch off.

