

GETTING STARTED

NOTE: Before you start your Muggy, read your engine break-in and operating instructions. If you run your Muggy without following proper break-in procedure, you may damage or fail to get maximum performance from your engine, and void the warranty.

Radio Batteries



Install the 8 AA-size alkaline batteries in the transmitter making sure the positive(+) and negative (-) ends are oriented correctly. Use only quality alkaline or rechargeable Ni-Cad batteries.

Antenna Tube

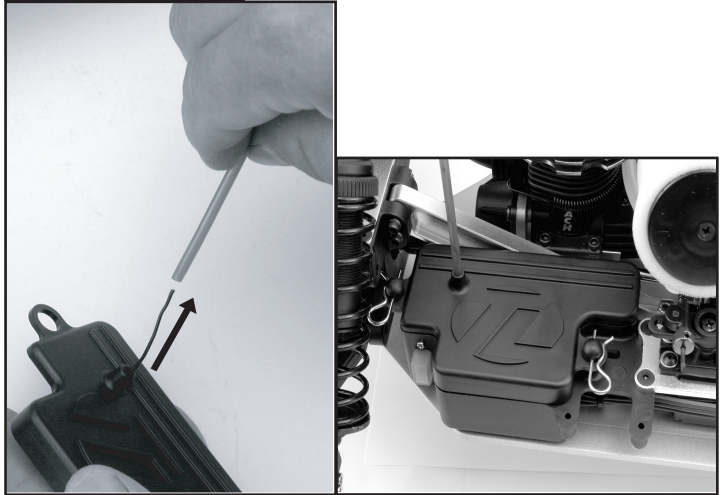

Locate the antenna tube in the plastic bag with the Operations guide. Thread the black antenna wire through the mounting boss on top of the receiver box cover and through the antenna tube. Push the antenna tube into the mounting boss and attach the antenna cap.

5 cell Receiver Pack

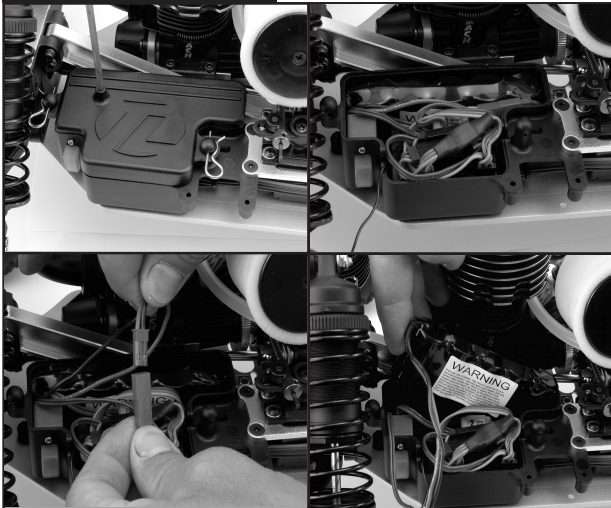

Note: Your Muggy is equipped with a rechargeable receiver pack installed in your truck. Follow the instructions to remove or replace the receiver pack.

To remove or charge the battery pack remove the two clips securing the receiver box cover. Unplug the battery from the switch. Remove the battery from the receiver box.

Charging the Receiver Pack



Plug the AC charger into the proper wall receptacle (110V). Plug the battery pack into the charger. When the battery is charging the red indicator light will be on. The battery must be charged for 12 hours to attain full charge.

Rotary Starter Battery Install



Slide the battery access panel opposite the hand strap back and remove the cover. Remove hex starter shaft from the back side of the cover and press the o-ringed end into the drive cup. Slide the 6 cell, 7.2 volt, "stick pack" into the Spin-Start and plug it in. Note that the plug is made such that it can only be plugged in one way. Carefully tuck the plug wires under the battery access panel and slide shut.

Operations Check



Turn on the transmitter and check for proper voltage, 10-12.4 volts. Slide the switch on the side of the radio box to the ON position. With the front tires off the ground turn the steering wheel on the transmitter left to right. The wheels should turn smoothly and with ease. Also operate the throttle and brake checking for smooth operation. Do not try to operate your truck if any of the servos or any part of the radio is not operating correctly. If the servos operate slowly it is possible the batteries are low and must be recharged. Never try to operate your truck if either the transmitter or receiver batteries are low.

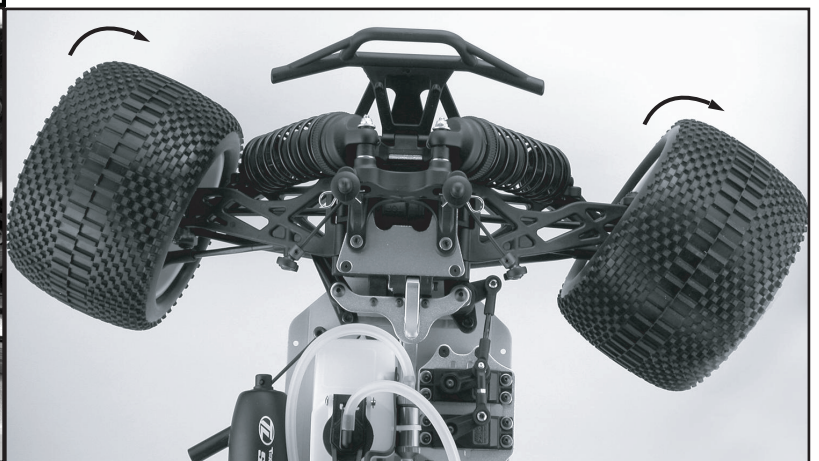
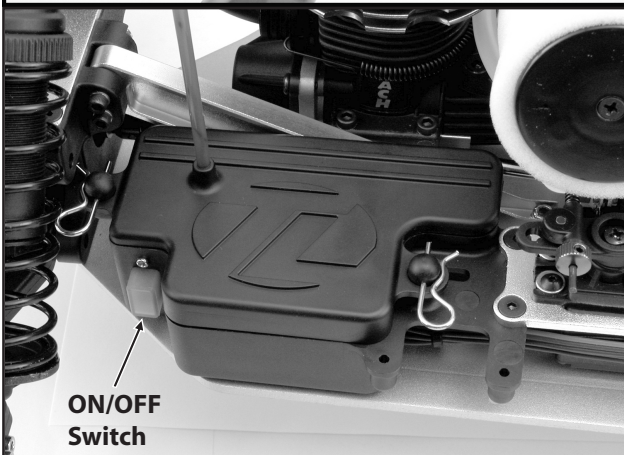

Your Muggy is equipped with front and rear adjustable brakes. To adjust the rear brake turn the red nob right or left. To adjust the front brake turn the silver nob right or left. The blue nob is the used to adjust your throttle linkage. A detailed explanation of the throttle linkage setup is located in your users manual. **NOTE:** The reference picture only shows one brake adjuster. The second brake adjuster is located below.

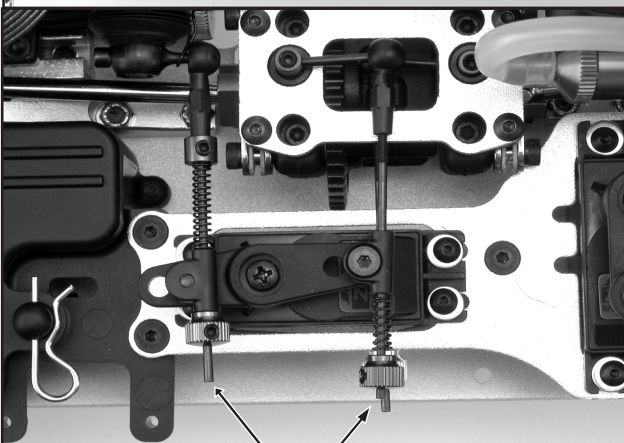

Throttle/Brake Linkage



Fueling



Fill your fuel bottle with fuel and lift the lid of the fuel tank and fill the tank. Make sure to put the lid back on both the fuel bottle and fuel jug.

Install Battery

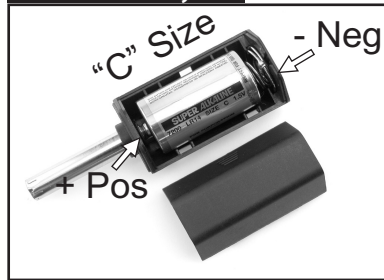

Remove the cover from the Glow plug igniter. Install a "C" size Alkaline battery with the "+" end of the battery as shown.

Priming your Engine

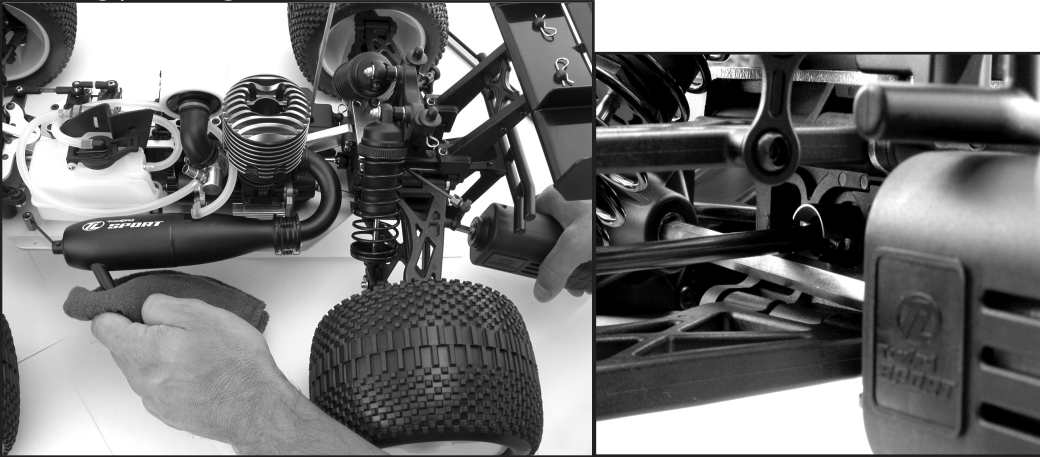

Insert the Spin-Starter into the back plate of the engine and plug the exhaust with a rag. Press the Spin-Start button and turn over the engine for 5 seconds to help prime the engine. Excessive priming will flood the engine and make it difficult to start.

Start your Engine



Attach the glow plug igniter to the glow plug. If you are using an aftermarket glow igniter with a meter make sure the needle is in the green or good condition. Holding the starter securely, press on the switch button and the engine should turn over and start.

If the engine does not turn over, it may be flooded or the battery in the starter needs to be charged. Use the 4-way wrench supplied to loosen the glow plug at least two turns and press the Spin-Start button again. Raw fuel should come out around the glow plug. Tighten the glow plug and resume the starting procedure.

Follow the engine break-in procedure, found in the Operations Guide, before attempting any racing or high performance operation. Use caution when adding fuel while the engine is running. Do not over fill or spill fuel outside the tank.

Stopping the Engine



When you are done running your Muggy use the handle of a screw driver or a rag to cover the exhaust pipe exit. Be EXTREMELY careful not to burn you hand as this will be hot.

