

# TEAM LOSI

# MINI-BAJA

**1/18TH SCALE READY-TO-RUN MINI DUNE BUGGY**

## Operation Manual

Thank you for choosing the Mini-Baja from Team Losi®. This guide contains the basic instructions for operating your new Mini-Baja. While the Mini-Baja is great for first-time R/C drivers, it does require some mechanical experience and/or parental supervision for drivers under 12. It is critical that you read all of the instructions in order to operate your model correctly and avoid unnecessary damage. Please take a moment to look over all the printed materials before operating your new Mini-Baja.



## Safety Precautions

This is a sophisticated radio controlled model that must be operated with caution and common sense. Failure to operate your Mini-Baja in a safe and responsible manner could result in damage to the model and property. The Mini-Baja is not intended for use by children without direct adult supervision. Team Losi and Horizon Hobby shall not be liable for any loss or damages, whether direct, indirect, special, incidental, or consequential, arising from the use, misuse, or abuse of this product or any product required to operate it.

- This model is controlled by a radio signal subject to interference from many sources outside your control. This interference may cause momentary loss of control so it is advisable to always keep some distance in all directions around your model as a safety margin to avoid collisions.
- Always operate your model in an open area away from cars, traffic and people.
- Avoid running your model in the street where damage can occur.
- Never run your Mini-Baja with low transmitter batteries.
- Carefully follow the directions and warnings for this and any optional support equipment.
- Keep all chemicals, small parts and anything electrical out of the reach of children.



## Tools and Items You Will Find Handy

- Soft bristle brush for cleaning
- 5.5mm nut driver for the wheel nuts.
- #0 or #1 Phillips screwdriver
- LOSA99100 .050" Allen Wrench

**Note:** Use only Team Losi tools or other high quality tools. Use of inexpensive tools can cause damage to the small screws and parts used on this type of model.

## The Radio System

The following is an overview of the various functions and adjustments found on the Mini-Baja radio system. Since the Mini-Baja operates on a radio signal you control, it is important for you to read and understand about all of these functions and adjustments before driving.

### The Receiver

1. **Throttle Port:** Where the Electronic Speed Control (ESC) plugs in.
2. **Steering Port:** Where the steering servo(s) plug in.
3. **Frequency Selector Button:** Used to program the desired frequency/channel.
4. **Frequency Indicator Lights:** Shows what frequency/channel is being received.

### The Electronic Speed Controller (ESC)

5. **On/Off Switch:** Powers the receiver and ESC.
6. **Setup Button and Indicator Light:** Used for re-setting the ESC.
7. **Battery Lead:** Connects to the battery pack for power.
8. **Motor Lead:** Connects to the wire leads from the motor.

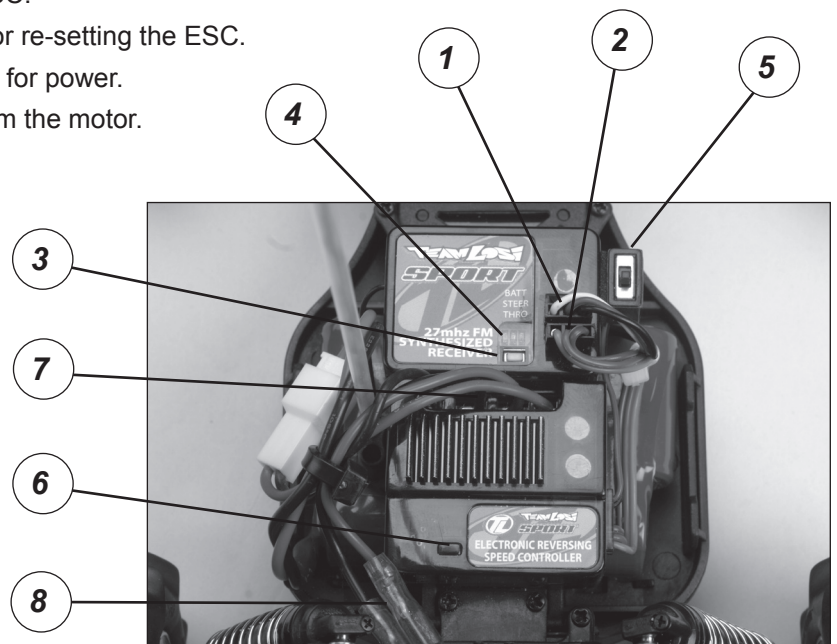

## The Transmitter

1. **Steering Wheel:** Controls direction (left/right) of the model.
2. **Throttle Trigger:** Controls speed and direction (forward/reverse) of the model.
3. **Antenna:** Transmits signal to the model.
4. **On/Off Switch:** Turns the power on for the transmitter operation.
5. **Indicator Lights:** Green (top) light indicates adequate battery power. Red (bottom) light indicates signal strength.
6. **Steering Trim (ST. TRIM):** Adjusts the “hands off” direction of the model.
7. **Throttle Trim (TH. TRIM):** Adjusts the motor speed to stop at neutral.
8. **Steering Rate:** Adjusts amount front wheels move when the steering wheel is turned left or right.
9. **Steering Reverse Switch (ST. REV):** Reverses the function of the steering when the wheel is turned left or right.
10. **Throttle Reverse Switch (TH. REV):** Reverses the function of the speed control when pulled back or pushed forward.
11. **Bottom Cover:** Covers and holds the batteries powering the transmitter.
12. **Frequency Indicator Lights:** Shows the frequency/channel you are on. The receiver must have a matching frequency/channel to operate.
13. **Frequency Select or Button:** Used to choose 1 of 6 available 27MHz frequencies.

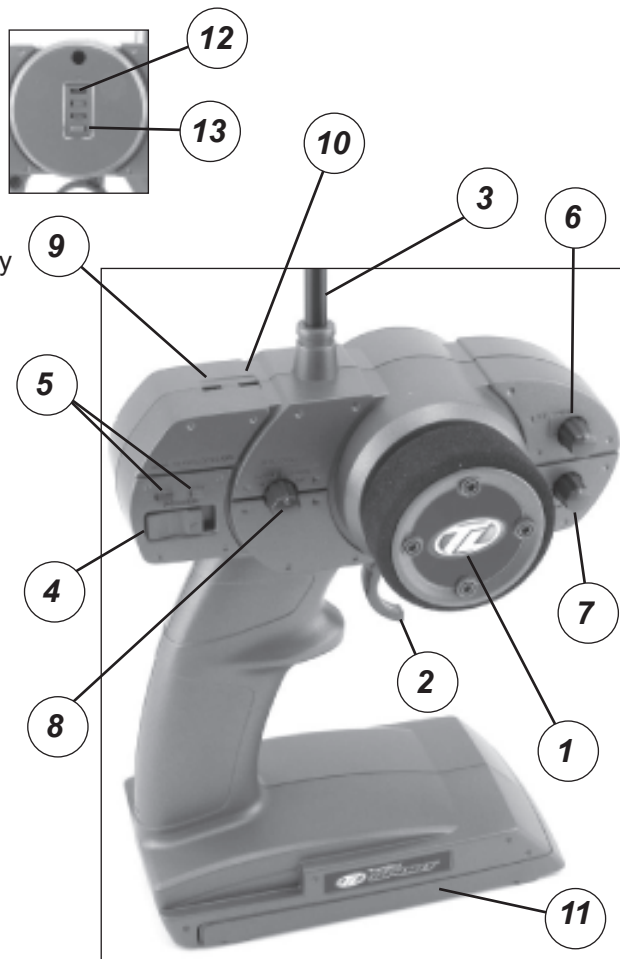

## Changing Frequencies/Channels

The Mini-Baja radio operates on 27MHz and has 6 different frequencies—often referred to as “channels” available. This allows you to operate without interference while up to 5 other models on 27MHz are also operating. Simply put, a frequency is like a TV channel. The transmitter you hold in your hand is like the TV station and the receiver in the Mini-Baja is like your TV at home that must be set to the correct channel to receive the signal your transmitter is sending. Unlike most radio systems, the Mini-Baja features a “synthesized” system that does not require crystals to be physically changed to select the channel you wish to operate on. Both the transmitter and the receiver must be set to the same frequency/channel for the model to operate correctly. This can be easily checked by noting the colored LED’s (lights) on the top of the receiver and the back of the transmitter. These should always be the same on both or you will not have control of the model. Always program the transmitter first then the receiver. To select a frequency, follow the following easy steps.

1. Turn on the transmitter and/or receiver. Note: Both should display the same light(s).
2. Locate the frequency selector button.
3. Press the selector button until the desired frequency light(s) are illuminated.
4. Repeat for the receiver if necessary.
5. Double-check to make sure both the transmitter and receiver have the same LED’s (lights) on.

Frequency/Channel Guide		
Channel/Color	Frequency	LED Indicators
Ch. 1 (Brown)	26.095MHz	Red (top) only
Ch. 2 (Red)	27.045MHz	Yellow (middle) only
Ch. 3 (Orange)	27.095MHz	Red & Yellow (top & middle)
Ch. 4 (Yellow)	27.145MHz	Green (bottom) only
Ch. 5 (Green)	27.195MHz	Red & Green (top and bottom)
Ch. 6 (Blue)	27.255MHz	Yellow and green (middle and bottom)

**Note:** A frequency guide sticker has been factory-applied to the back of the Mini-Baja transmitter for your convenience.

## Resetting the ESC

The ESC comes from the factory pre-set and ready for use. If for some reason you should need to re-set the ESC, use the following instructions.

1. Turn on the transmitter and ESC. Press the set-up button — both the RED and GREEN LEDs will come on.
2. Pull the throttle trigger all the way back (full speed) and press the set-up button once — only the GREEN LED will come on.
3. Push the throttle trigger full forward (brake/reverse) and push the set-up button once — only the RED LED will come on.
4. Let the throttle trigger return to the neutral (center) position and press the set-up button once more to save the program and exit set-up mode — only the GREEN LED will be on.

### Notes:

- A: If the receiver does not receive a signal from the Transmitter, the ESC will not enter the Program mode.
- B: While in Program mode, the motor will not run.
- C: If the set-up button is not pressed for 20 seconds while in the Program mode, the ESC will exit the Program mode and the data will be saved.

## Slipper Adjustments

The Mini-Baja is equipped with a slipper device offering both traction control and protection for the transmission. The slipper is primarily used to help absorb sudden impacts on the drive train due to landing big jumps or when using more powerful aftermarket motors and/or battery packs. Additionally, it can be used to smooth out the flow of power to the rear wheels and limit wheel spin when running on extremely slick surfaces. Adjustment is made by turning the 3mm adjustment nut clockwise (to the right) to reduce the slip, or counterclockwise (to the left) to increase the slip. When adjusted properly, you should be able to hold the rear tires firmly and barely be able to push the spur gear forward with your thumb. To track test, turn the Mini-Baja on and place it on the ground. As you push it backwards allowing it to roll freely, punch the throttle. The slipper should slip no more than an inch or two as it accelerates. With the included motor and battery pack it should slip just a little. Make sure you replace the gear cover before running.

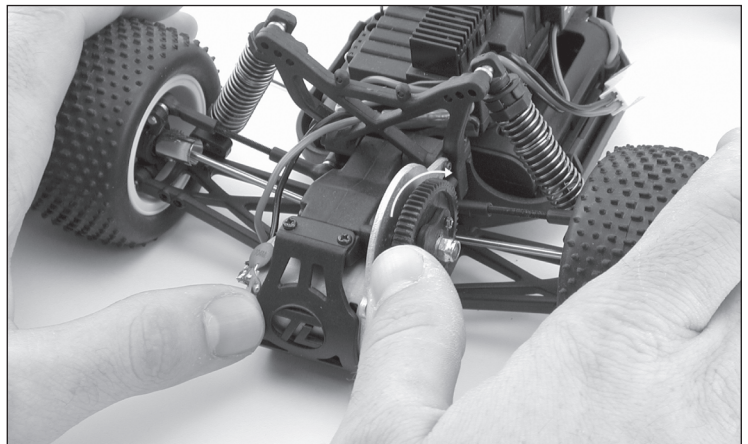
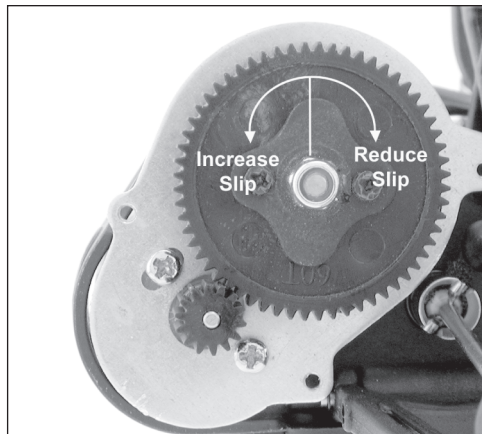

## Steering Rate

Your transmitter is equipped with a steering rate control to the left of the steering wheel. This advanced feature, usually found only on competition-type radios, allows you to adjust the amount the front tires move when you turn the steering wheel. This is really helpful when you are on slick, as well as high traction, surfaces. If your Mini-Baja turns too sharply and/or spins out easily, try turning the steering rate down by rotating the knob counterclockwise (to the left). For sharper or additional steering, try turning the knob clockwise (to the right).

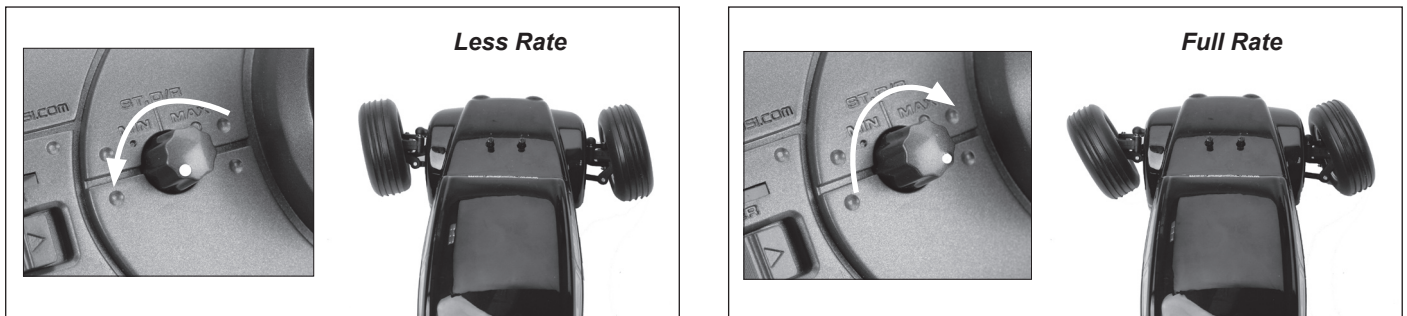

## Chassis Tuning

The Mini-Baja has several adjustments available to you for tuning the performance for your needs. Although there are multiple shock positions and camber link locations provided, as noted above we have built the model with the best overall settings. The following are simple adjustments and easily maintained settings to assure proper operation and performance. It is advised when making any adjustment you do so in small increments and always check for other parts of the chassis that are affected.

### Camber

Camber is the angle of the tires to the racing surface when viewed from the front or rear of the truck. You want to keep both the front and rear tires straight up and down or leaning in at the top very slightly. If you are running on carpet or similar high traction surfaces, you may find leaning the tires in a bit more helps. This adjustment is made with the threaded links extending from the front or rear bulkhead to the spindle carrier or rear hub. Making the camber rods shorter increases the camber and lean-in of the tire, while making the camber rods longer decreases the camber.

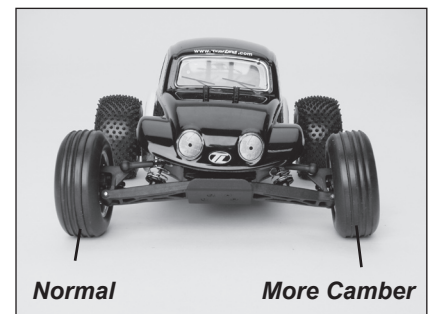

### Toe-In

This is the relationship of the left and right side tire to one another. Ideally you want the front of the tires to be pointed inward toward each other just slightly when viewed from above. This makes the model track straight and stable. This is controlled with the threaded steering rods on either side. As you make them longer you will increase the toe-in and vice versa.

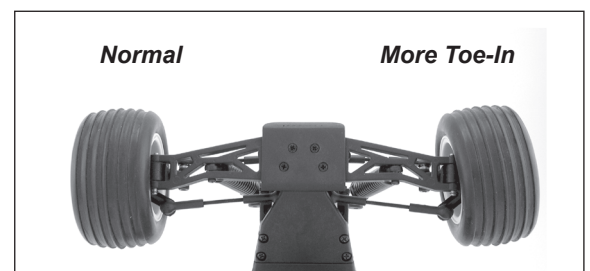

### Ride Height

This is the height the chassis sits and runs at. Spring spacers included with the Mini-Baja, when installed between the shock top and spring, will increase the pre-load on the spring and raise the chassis. You may want to try this when running on extremely rough surfaces.

## Service/Repair

### Radio/Speed Control & Motor

If you have any problems other than those covered in the troubleshooting section, please call the electronics service department at (877) 504-0233. They will be able to give your specific problem additional attention and instruct you as to what needs to be done.

### Chassis

If you have any questions other than those covered in the troubleshooting or maintenance sections, please call (877) 504-0233.

### Cleaning

Performance can be hindered if dirt gets in any of the moving suspension parts. Use compressed air, a soft paintbrush, or toothbrush to remove dust or dirt. Avoid using solvents or chemicals as they can actually wash dirt into the bearings or moving parts as well as cause damage to the electronics.

### Rebuilding the Differential

The gears in the differential will wear over time. The same is true for the outdrives, driveshafts, and rear axles. We suggest using a small rag or paper towel to lay out the parts you remove to make it easier to reassemble.

### Disassembly

1. Unplug the motor.
2. Remove the gear cover (three screws).
3. Remove the motor guard screws at the top of the transmission and the two at the extreme rear bottom of the chassis.
4. Remove the screw attaching the rear shock tower to the transmission and the four screws at the bottom of the chassis holding the gearbox in place and slide it out of the chassis
5. Remove the left side of the gearbox by removing the three screws.
6. Remove any shims on the bevel gears and set them aside so they can be reinstalled in the same location.
7. Carefully remove the large plastic sun gear and the bevel gears on either side of it. You can use the removed differential assembly as a guide for putting together the replacement unit (a little Team Losi Teflon grease #LOSA3066 can be applied for even better performance).
8. Remove the center mounted idler gear from the gearbox. Remove the shaft and push out the ball bearings from either side. Install these bearings in the new gear.

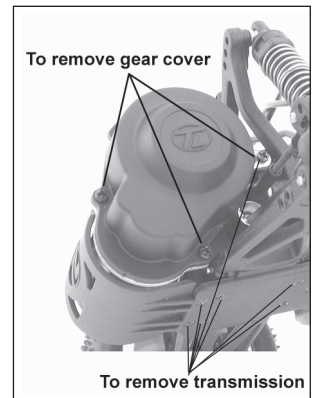

### Reassembly

Replace the idler gear and shaft into the center of the same right side of the gearbox. Replace any shims removed from the right bevel gear and slide it through the lower bearing. Replace any shims that came off of the left side bevel gear and allow it to slide through the lower bearing as you put the left gear box half back into position. Replace the screws and reinstall the rebuilt gearbox using the steps in reverse order that were used to remove it.



### Changing the Spur Gear

Remove the gear cover by removing the three small screws. If you are replacing the spur gear with one different size (number of teeth), you must first loosen (do not remove) the two screws that secure the motor and slide it back slightly. Remove the 3mm nut at the end of the slipper shaft and all of the slipper parts on the outside of the spur gear as well as the old gear. Place the new spur gear into position and replace the slipper parts. If you have changed the size of the spur, see Setting the Gear Mesh on the following page. After you have changed the spur gear, you will have to adjust the slipper as described elsewhere.

## **Changing the Pinion Gear/Gear Ratio**

Before you change the pinion gear ask yourself why you are doing it. In general, if you change to a larger pinion the top speed will improve but you will see less acceleration and run time. This would only be advisable for really long track layouts with few tight turns. Changing to a smaller pinion will give you quicker acceleration and possibly a bit longer run time but a little less top speed. This would be good for short layouts or when running hotter motors. The pinion on the Mini-Baja offers the best balance of both. To change the pinion, remove the gear cover, loosen the motor screws, and slide the motor back. Use a pair of small needle-nose pliers between the motor plate and back of the pinion to push the pinion off. Place the new pinion on the end of the motor shaft and, using the flat of the pliers or a similar flat tool, push it on to the same position as the one removed. If you have changed the size of the spur, see Setting the Gear Mesh below.

**Warning:** When running after-market motors, check with the motor manufacturer for correct gearing. Never over-gear the motor as it can cause overheating, damaging it and the speed control.

## **Setting the Gear Mesh**

The motor screws should be slightly loose. Slide the motor forward allowing the pinion gear to mesh with the spur gear. Snug (not tight) the bottom motor screw and try rocking the spur back and forth. There is a slight bit of movement before the motor is forced to turn over. If not, pull the top of the motor back slightly and recheck. If there is too much slop between the gears, push the top of the motor forward. When set properly the wheels can be spun forward freely with very little noise. Make sure to tighten both motor screws and replace the gear cover before running.



## **Radio Replacement/Service**

If you have a radio problem please call (877) 504-0233 for customer service. Most likely, unless you have gotten the components wet, the service technician can help you fix the problem over the phone. If the problem is more severe, you may be asked to send in the truck and transmitter or the entire radio system, which would include the receiver/speed control unit and steering servo. In some cases, like a broken servo or a speed control that has failed due to getting wet, your local dealer can sell you the a replacement component. The following is complete guide to removing the system.

## **Steering Servo**

Unplug the servo lead from the receiver. Remove the four small screws that secure the servo mount/chassis brace to the chassis. Use a screwdriver or small pliers to pop the steering link off of the servo, so it can be removed. There is no need to remove the servo mounts on either side as all service can be done with them on. Replace in the reverse sequence used to remove it.

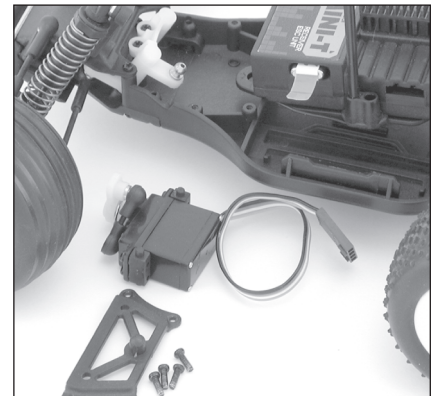

## **Receiver/Speed Control (ESC)**

Unplug the power lead, motor leads and steering servo. Carefully remove the antenna wire from the antenna tube. Do not attempt to open the receiver or electronic speed control (ESC) as only a factory technician has the proper tools and parts to make any repairs necessary. The receiver and ESC are mounted with double-sided foam tape. Use your thumb and index finger at the bottom of the front corners to pull them from the mount. If this is difficult, ask for help. If necessary, carefully use a large flat blade screwdriver between the unit and the mount to pry it loose. Make sure you remove any left over foam or adhesive before remounting with common servo tape or hobby type foam tape.

## **Service/Tech Help**

(877) 504-0233

# Rebuilding/Refilling the Shocks

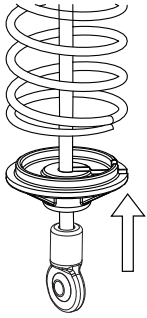

## Step 1

After removing the shock, push up on the lower spring cup and remove it from the shaft. Remove the spring and preload spacers.

**Note:** If you only wish to change or fill the shock fluid, skip to step 6.

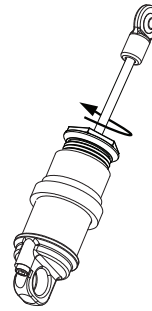

## Step 2

Turn the shock upside down and remove the black shock cartridge/shaft assembly from the shock body by turning it counterclockwise.

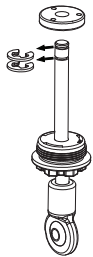

## Step 3

Remove the top E-clip from the shock shaft. Remove the shock piston. Remove second E-clip. Remove the old cartridge.

Put a drop of oil on the shock shaft before installing a new shock cartridge.

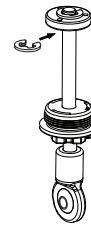

## Step 4

Reinstall the lower E-clip. Slide the shock piston onto the shock shaft against the E-clip. Reinstall the top E-clip.



## Step 5

If you plan on completely changing the shock fluid (suggested), dump out the old fluid from the shock body. Carefully fill the shock body with fluid to the bottom of the threads inside the shock body.

**Note:** Your Mini-Baja comes with 100wt shock fluid from the factory.



## Step 6

Pull the shaft out so the piston is next to the cartridge and reinstall the assembly into the shock body, turn in a clockwise direction until snug—DO NOT TIGHTEN yet!

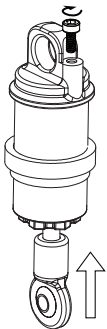

## Step 7

Turn the shock over and use a #0 Phillips screwdriver to remove the small bleed screw at the top of the shock. Slowly push the shock shaft up until it stops. Excess fluid should flow out of the bleed hole. Slowly pull the shock shaft halfway back and replace the bleed screw. Use pliers to tighten the cartridge, being careful not to strip the plastics lobes on the cartridge.

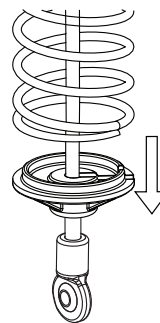

## Step 8

Replace the spring and spring cup and test the shock action for smoothness and leaks. Retighten the bleed screw or cartridge if either leaks. Remount the shock on your truck.

**\*\* Production shock parts may differ from those shown in above drawings.**